



XFL8001

- Crystal Filter
- Surface Mount Seam Weld Package
- 2-pole IF Filter
- High Reliability
- Complies with Directive 2002/95/EC (RoHS)



**76.8 MHz
Crystal Filter**

Surface mount 5.0 x 7.0 x 1.27 mm Crystal Filter

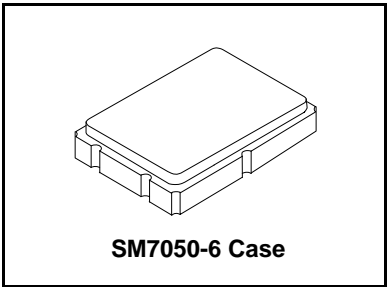

Electrical Characteristics

Characteristic	Sym	Notes	Minimum	Typical	Maximum	Units
Center Frequency	F_0		76.8 MHz, Third Overtone			MHz
Insertion Loss					3.0	dB
Ripple (@ ± 4 kHz)					1.0	dB
3 dB Passband				± 4		kHz
Stopband (@ ± 60 kHz)			35			dB
Spurious			10			dB
Terminating Impedance				$1500\Omega \pm 1.4$		pF
Power Level					10	dBm
Operating Temperature (without lost of function)			-40 ~ +85			°C
Lid Symbolization (in addition to Lot and/or Date Codes)	8001 YWWS					



CAUTION: Electrostatic Sensitive Device. Observe precautions for handling.

Notes:

1. The design, manufacturing process, and specifications of this device are subject to change without notice.

Testing Circuit

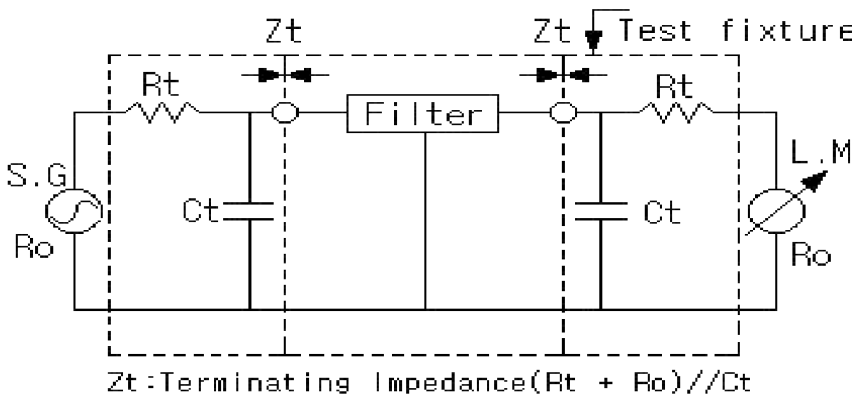

Rt	1450 ohms
Ro	50 ohms
Ct	-1.4 pF

SM7050-6 Case

6-Terminal Surface-Mount Case 5.0 x 7.0 mm Nominal Footprint

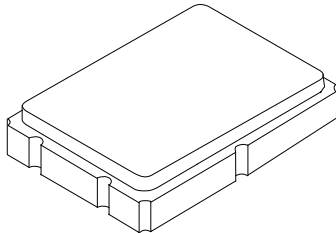

Mechanical Dimensions (mm):

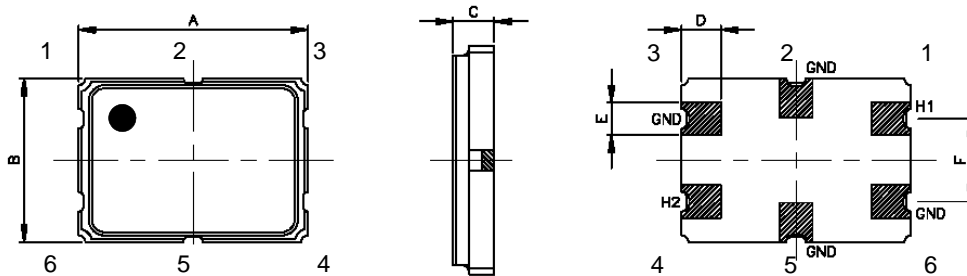

A	B	C	D	E	F
7.00	5.00	1.27	1.21	0.99	2.54
± 0.18	± 0.18	± 0.20	± 0.13	± 0.13	± 0.13

Tape Dimensions (mm):

Marking
Line1: 8001
Line2: YWWS (Y=year, WW=week, S=shift)

