

## DETAILS

<b>Product Number</b>	CA13747_KIKI-A
<b>Family</b>	KIKI
<b>Type</b>	Assembly
<b>Color</b>	clear
<b>Diameter</b>	21.6 x 14 mm
<b>Height</b>	5.9 mm
<b>Style</b>	rectang
<b>Optic Material</b>	PMMA
<b>Holder Material</b>	
<b>Fastening</b>	pin, tape
<b>Status</b>	ready
<b>ROHS Compliant</b>	Yes
<b>Date Updated</b>	30/03/2015



## OPTICAL PROPERTIES

LED	Viewing Angle	Light Beam	Efficiency	cd/lm	Connector
Oslon Square PC	161 deg	Wide-Area...	88 %	0.290	-
LUXEON T	162 deg	Wide-Area...	91 %	0.280	-
LUXEON TX	162 deg	Wide-Area...	90 %	0.270	-
XT-E HVW	163 deg	Wide-Area...	91 %	0.280	-
XT-E	165 deg	Wide-Area...	92 %	0.260	-

4

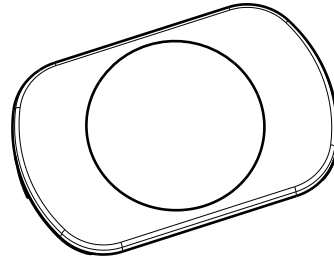
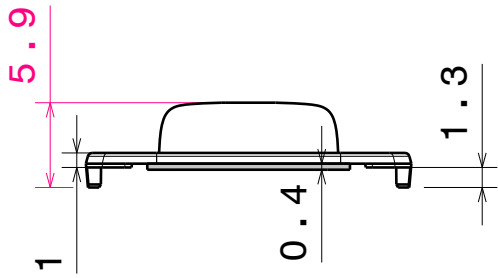

Isometric view

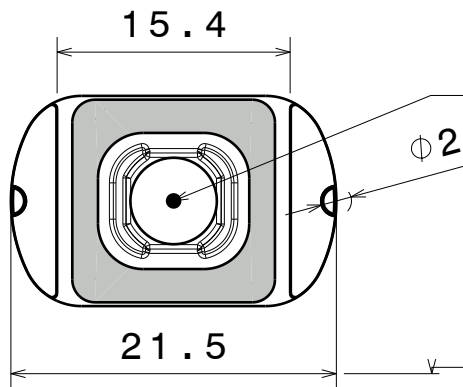
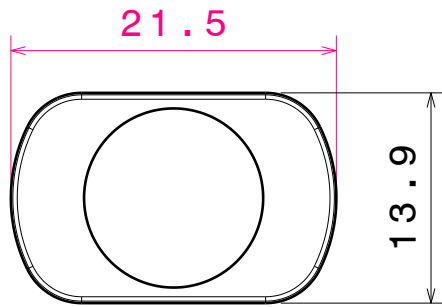

Led position

Positionpins center to center

4

3

2

1

INDEX	PART NO	DESCRIPTION	MATERIAL	COLOUR
1	CA13747	KIKI-A	None	

Tolerances if not otherwise shown  
 According to DIN ISO 2768-1  
 Linear measures:  
 Up to 30mm class M, otherwise class C.  
 According to DIN ISO 2768-2  
 Form and position: class L



Ledil Oy  
 Salorankatu 10  
 FIN 24240 SALO  
 Finland

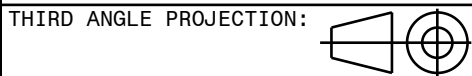

DRAWING TITLE

CA13747\_KIKI-A

This drawing is the property  
 of LEDiL Oy. It may not be  
 reproduced, copied or  
 communicated without a written  
 agreement with LEDiL Oy."

SIZE	PART NUMBER
A4	CA13747

SCALE	2:1	WEIGHT	-	SHEET	1/1
-------	-----	--------	---	-------	-----

D

A

Luminaire: LEDiL Oy CA13747\_KIKI-A\_(SQ-PC)

Lamps: 1 x OSRAM\_OSLON\_SQUARE\_PC\_(LCW\_CQAR.PL-MSMV-5H71-1)\_100.369lm@250mA\_CCT=5913K\_P=0.770467W\_I=249.9mA

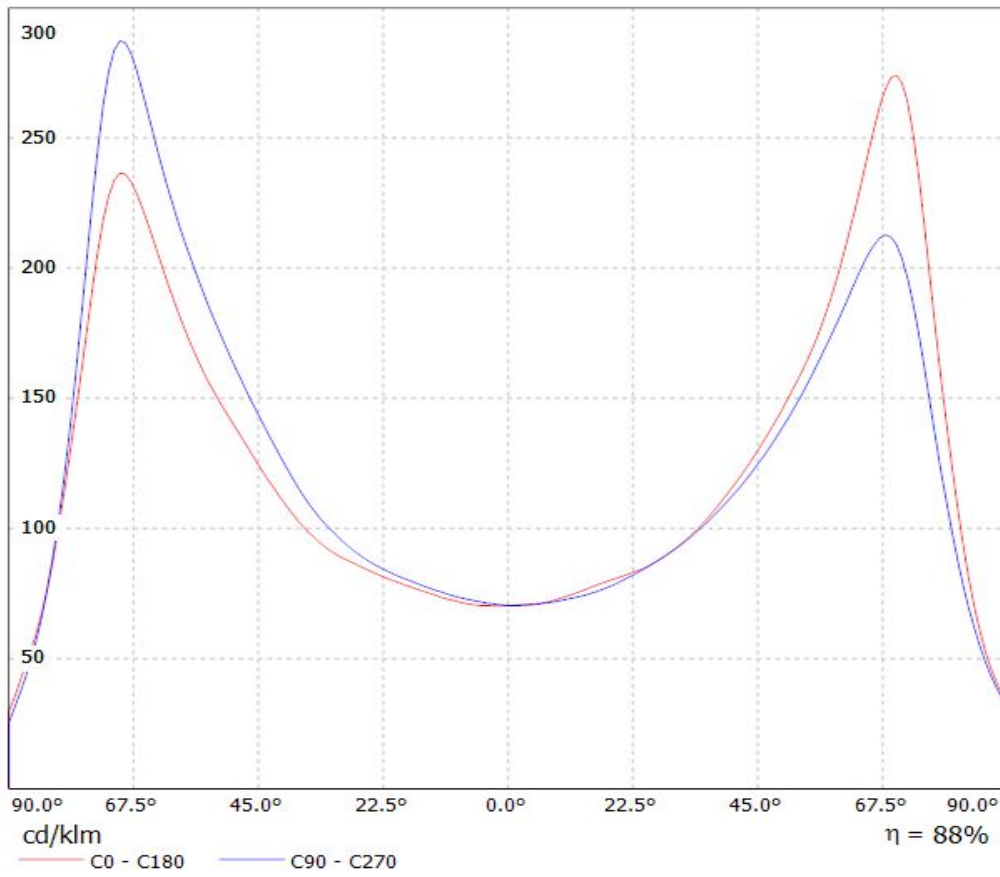

Luminaire: LEDiL Oy CA13747\_KIKI-A\_(Luxeon\_T) Eff: 91%

Lamps: 1 x Luxeon\_T\_(LXH8-FW30-3)\_71.7197lm@250mA\_CCT=3178K\_P=0.735456W\_I=249.9mA

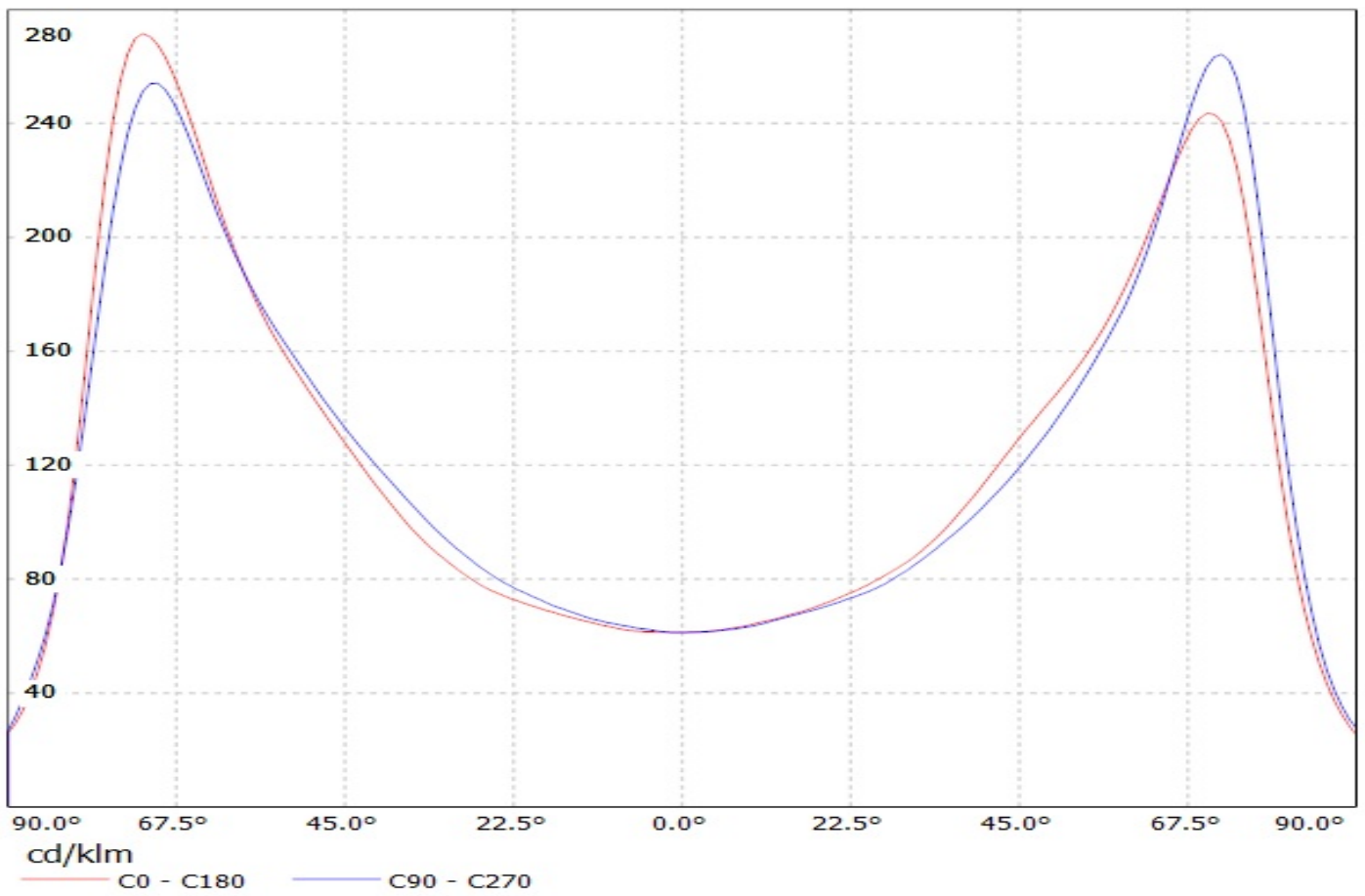

Luminaire: LEDiL Oy CA13747\_KIKI-A\_(Luxeon\_TX) Eff.89.9%

Lamps: 1 x Luxeon\_TX\_(L1T2-3585)\_80.1801lm@250mA\_CCT=3500K\_P=0.731482W\_I=249.9mA

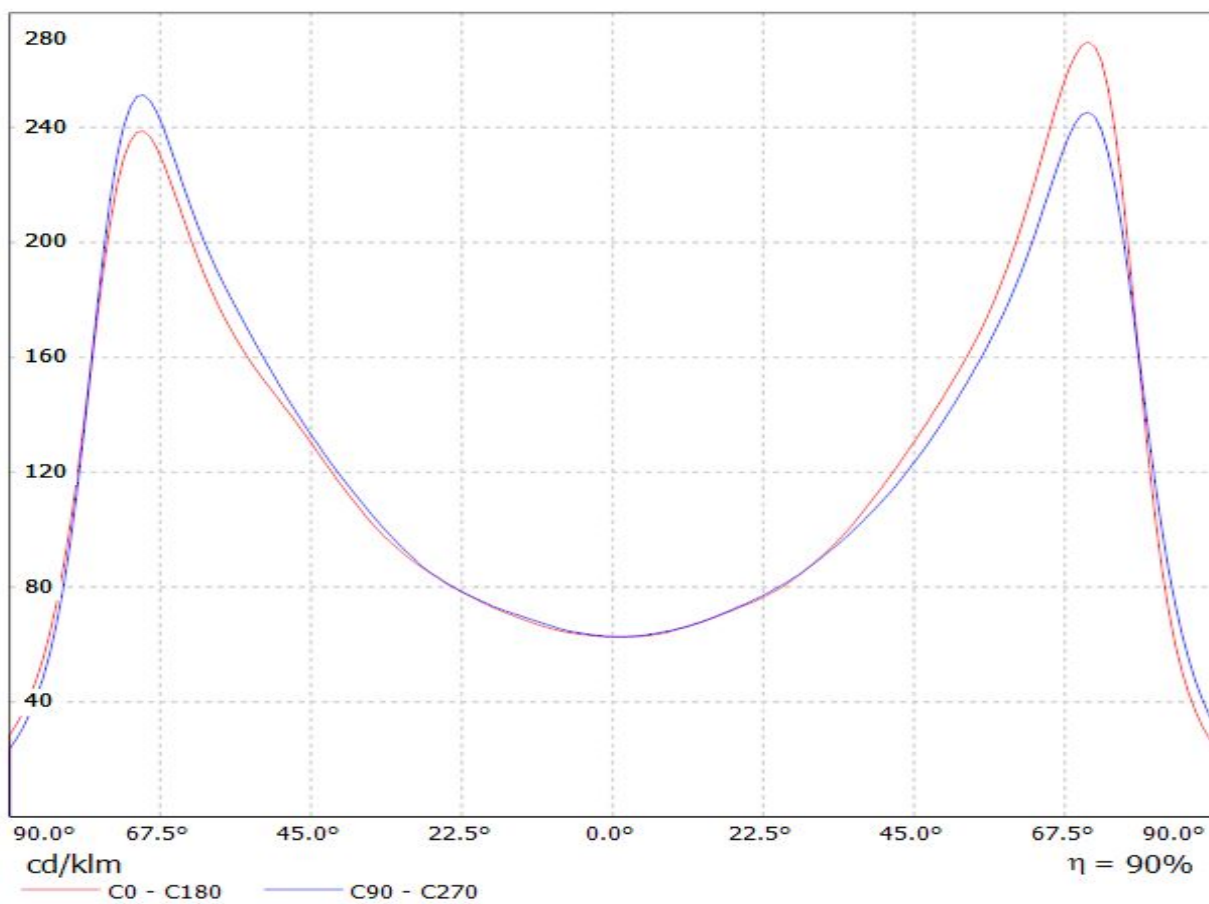

Luminaire: LEDiL Oy CA13747\_KIKI-A\_(XT-E\_HVW) Eff.90.9%  
Lamps: 1 x CREE\_XT-E\_HVW\_(XTEHVW-Q-1BO-Q5O-3L-0001)  
\_118.154lm@20mA\_P=0.988468W\_I=20.3mA

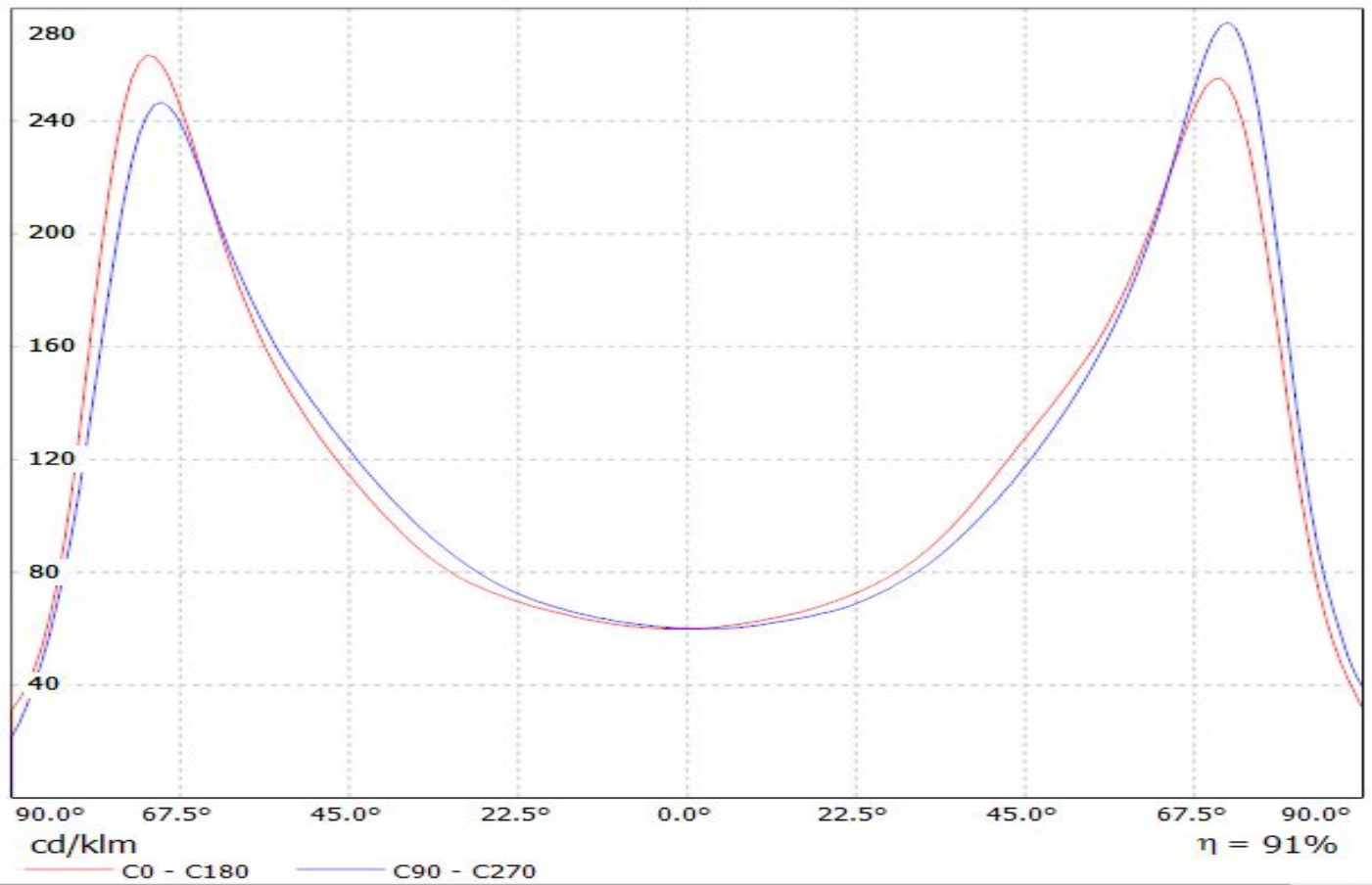

Luminaire: LEDiL Oy CA13747\_KIKI-A\_(XT-E) Eff. 92%

Lamps: 1 x Cree\_XT-E\_(XTEAWT-00-0000-00000HBE8)\_75.6217lm@250mA\_CCT=2811K\_P=0.789334W\_I=249.9mA

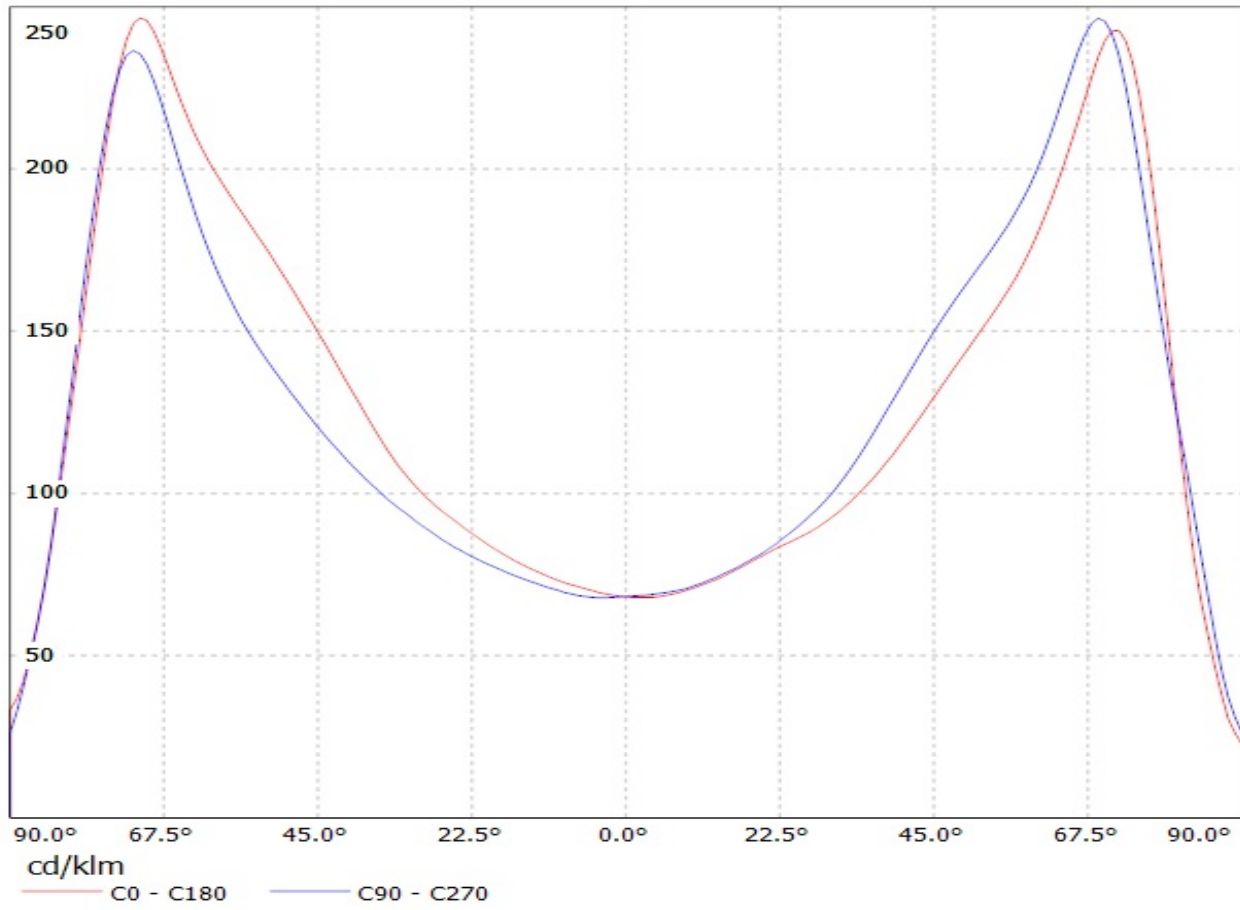

Luminaire: LEDiL Oy CA13747\_KIKI-A\_(SQ-PC)

Lamps: 1 x OSRAM\_OSLON\_SQUARE\_PC\_(LCW\_CQAR.PL-MSMV-5H71-1)\_100.369lm@250mA\_CCT=5913K\_P=0.770467W\_I=249.9mA

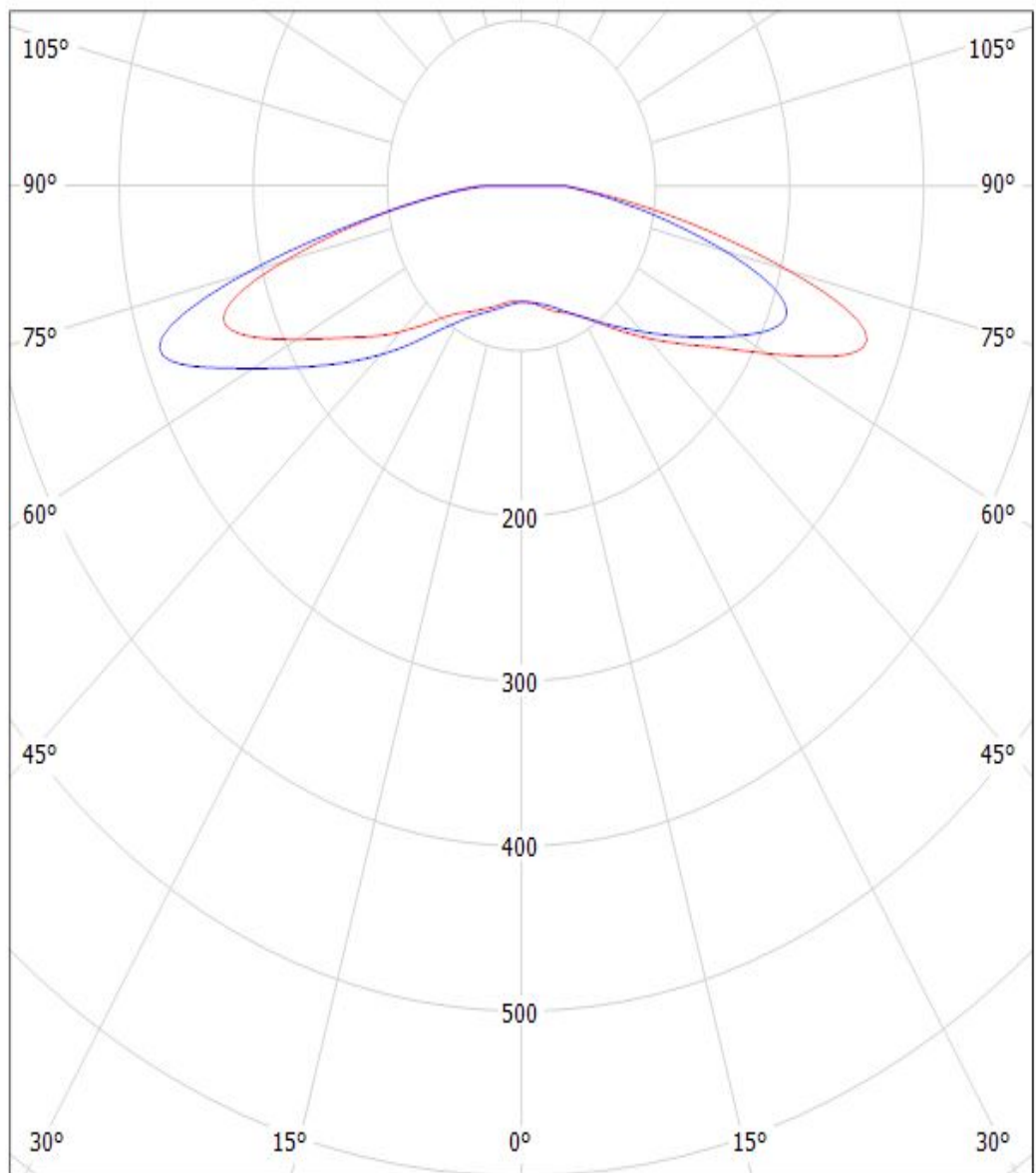

cd/klm

— C0 - C180    — C90 - C270

$\eta = 88\%$



Luminaire: LEDiL Oy CA13747\_KIKI-A\_(Luxeon\_T) Eff: 91%

Lamps: 1 x Luxeon\_T\_(LXH8-FW30-3)\_71.7197lm@250mA\_CCT=3178K\_P=0.735456W\_I=249.9mA

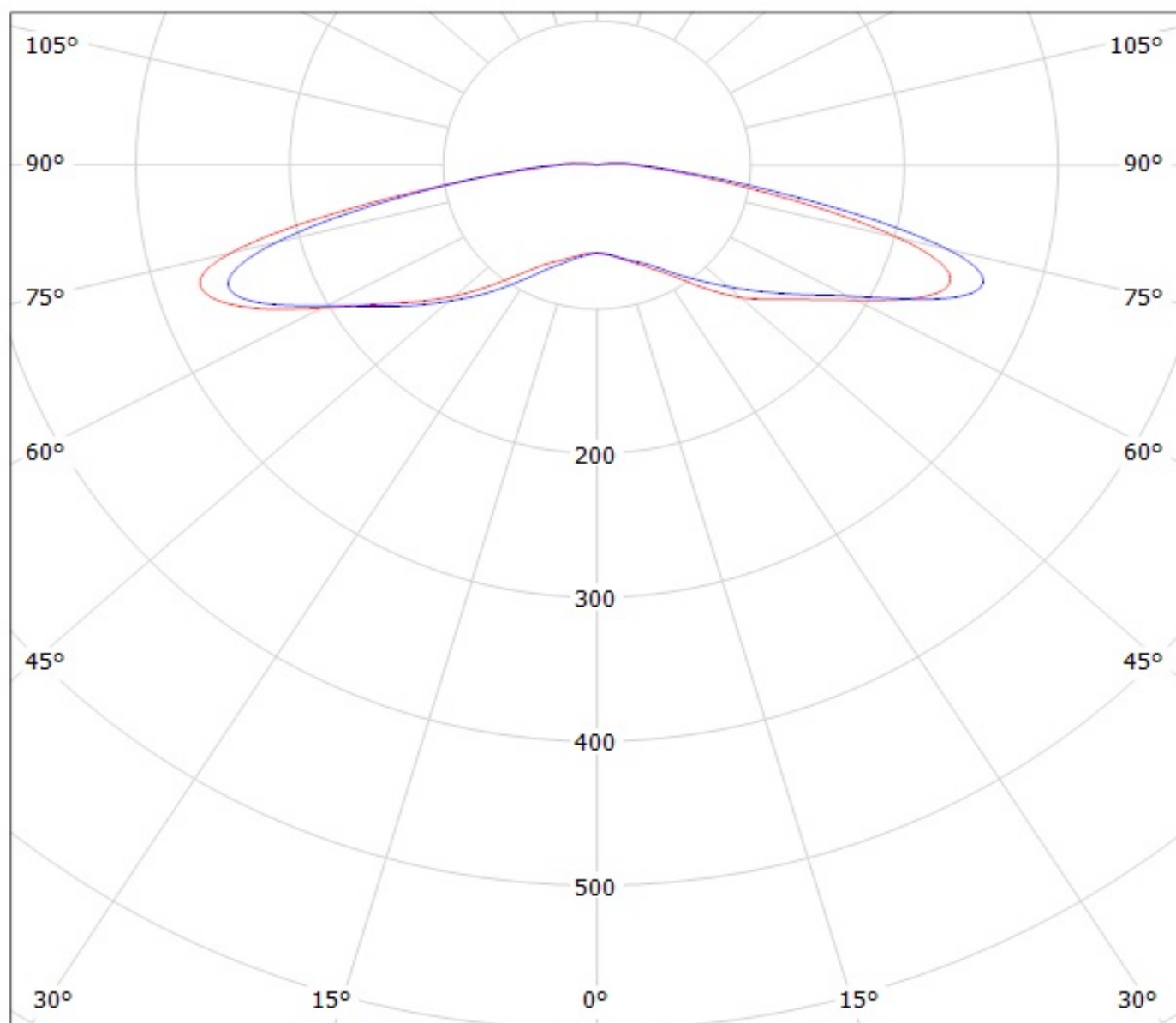

cd/klm

— C0 - C180

— C90 - C270

Luminaire: LEDiL Oy CA13747\_KIKI-A\_(Luxeon\_TX) Eff.89.9%  
Lamps: 1 x Luxeon\_TX\_(L1T2-3585)\_80.1801lm@250mA\_CCT=3500K\_P=0.731482W\_I=249.9mA

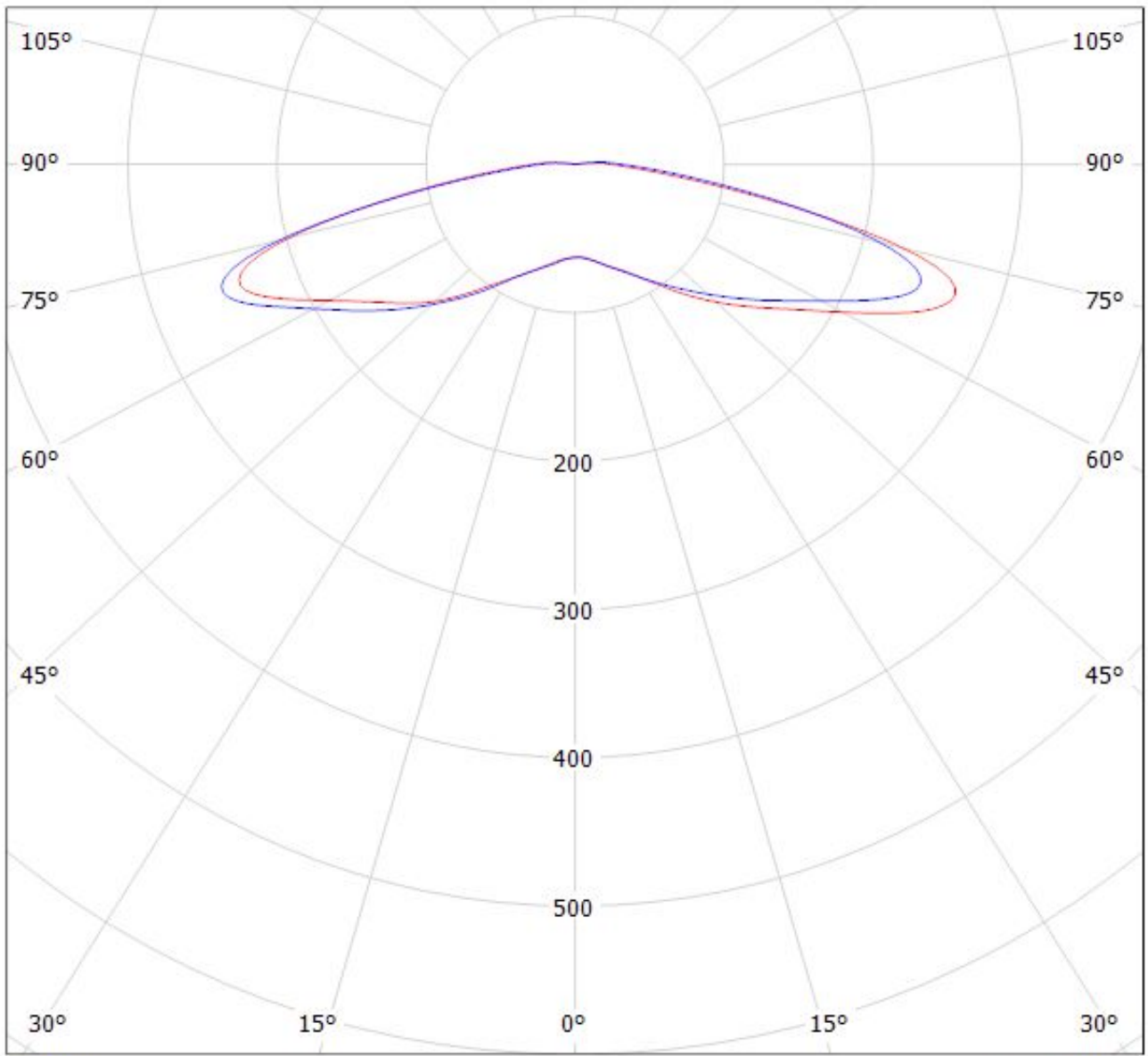

cd/klm

— C0 - C180    — C90 - C270

$\eta = 90\%$

Luminaire: LEDiL Oy CA13747\_KIKI-A (XT-E\_HVW) Eff.90.9%  
Lamps: 1 x CREE\_XT-E\_HVW\_(XTEHVW-Q-1BO-Q5O-3L-0001)  
\_118.154lm@20mA\_P=0.988468W\_I=20.3mA

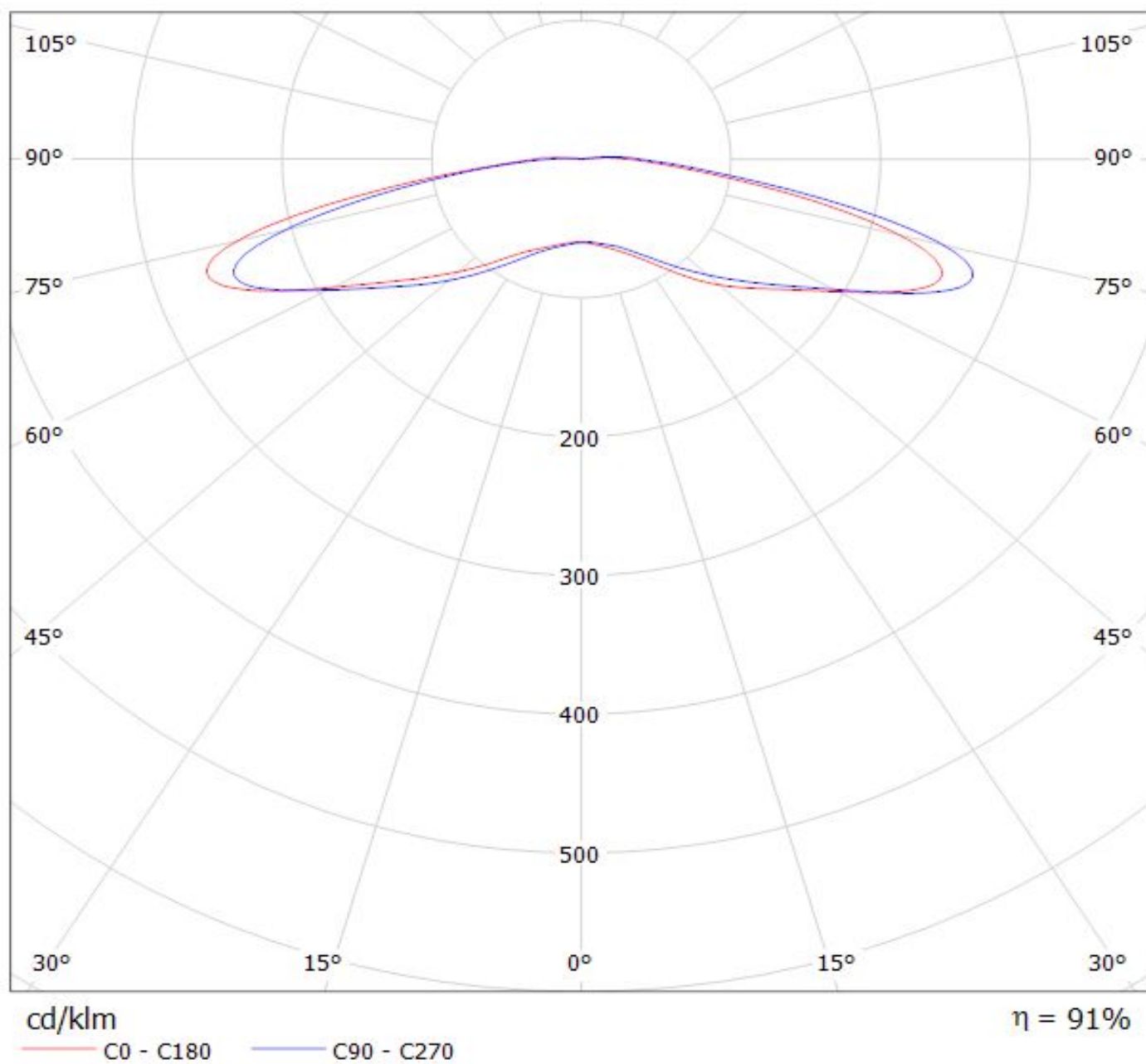

Luminaire: LEDiL Oy CA13747\_KIKI-A\_(XT-E) Eff. 92%

Lamps: 1 x Cree\_XT-E\_(XTEAWT-00-0000-00000HBE8)\_75.6217lm@250mA\_CCT=2811K\_P=0.789334W\_I=249.9mA

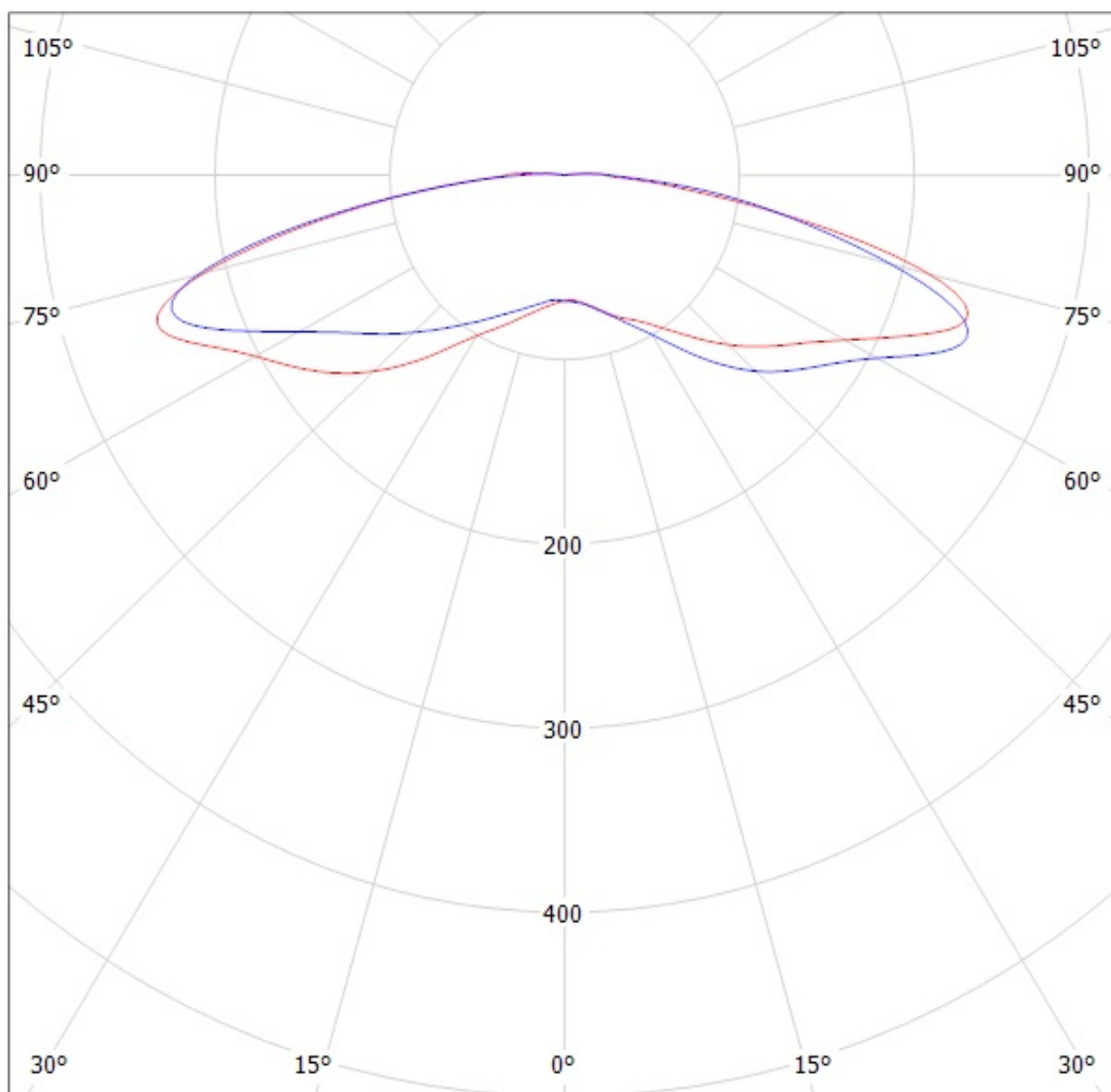

cd/klm

— C0 - C180

— C90 - C270

**NOTE: The typical divergence will be changed by different color, chip size and chip position tolerance. The typical total divergence is the full angle measured where the luminous intensity is half of the peak value.**