

Dimensions: mm (in.)

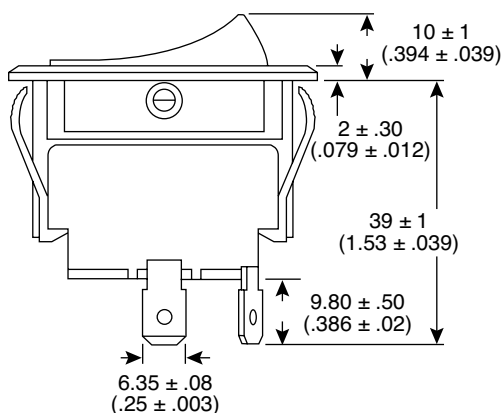

Mounting Hole

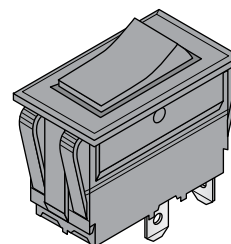
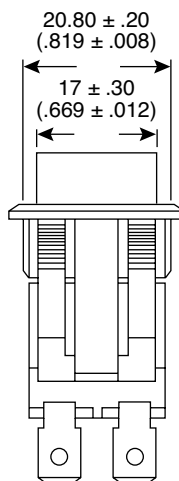
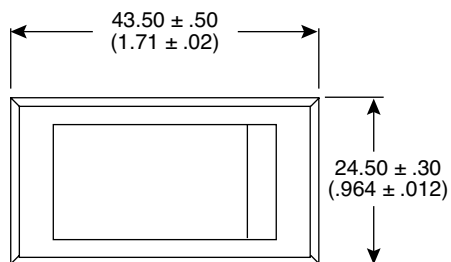
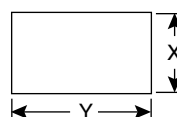

| Thickness | X | Y |
|-----------|----------|----------|
| 0.75-1.25 | 21.2+0.1 | 37.3-0.1 |
| 1.25-2 | 21.2+0.1 | 37.5-0.1 |
| 2-3 | 21.2+0.1 | 37.9-0.1 |

Circuit Diagram

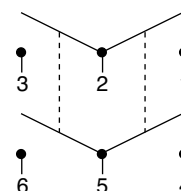

| Mouser Stock No. | Type | Circuit | Button Color / Mark |
|------------------|---------|-----------|---------------------|
| 103-7043-EVX | 2P SPST | On-Off | On - Off |
| 103-7044-EVX | 6P DPDT | On-Off-On | Black |
| 103-7045-EVX | 4P DPST | On-Off | Black |

Electrical Specifications:

- Rating: 16A / 125VAC, 10A / 250VAC
- Contact Resistance: 50m Ω max.
- Insulation Resistance: 500 VDC 100M Ω min.
- Dielectric Strength: 1500 VAC 1 minute

Note:

- RoHS Compliant by Exemption

Mechanical Specifications:

- Operating Temperature: -20° ~ 85°

Rocker Switches

103-7043-EVX, 103-7044-EVX, 103-7045-EVX