

LOC	DIST	REVISIONS					
		P	LTN	DESCRIPTION	DATE	OWN	APVD
HM	00	A		INITIAL RELEASE; ECO-15-004457	25MAR2015	GG	LS

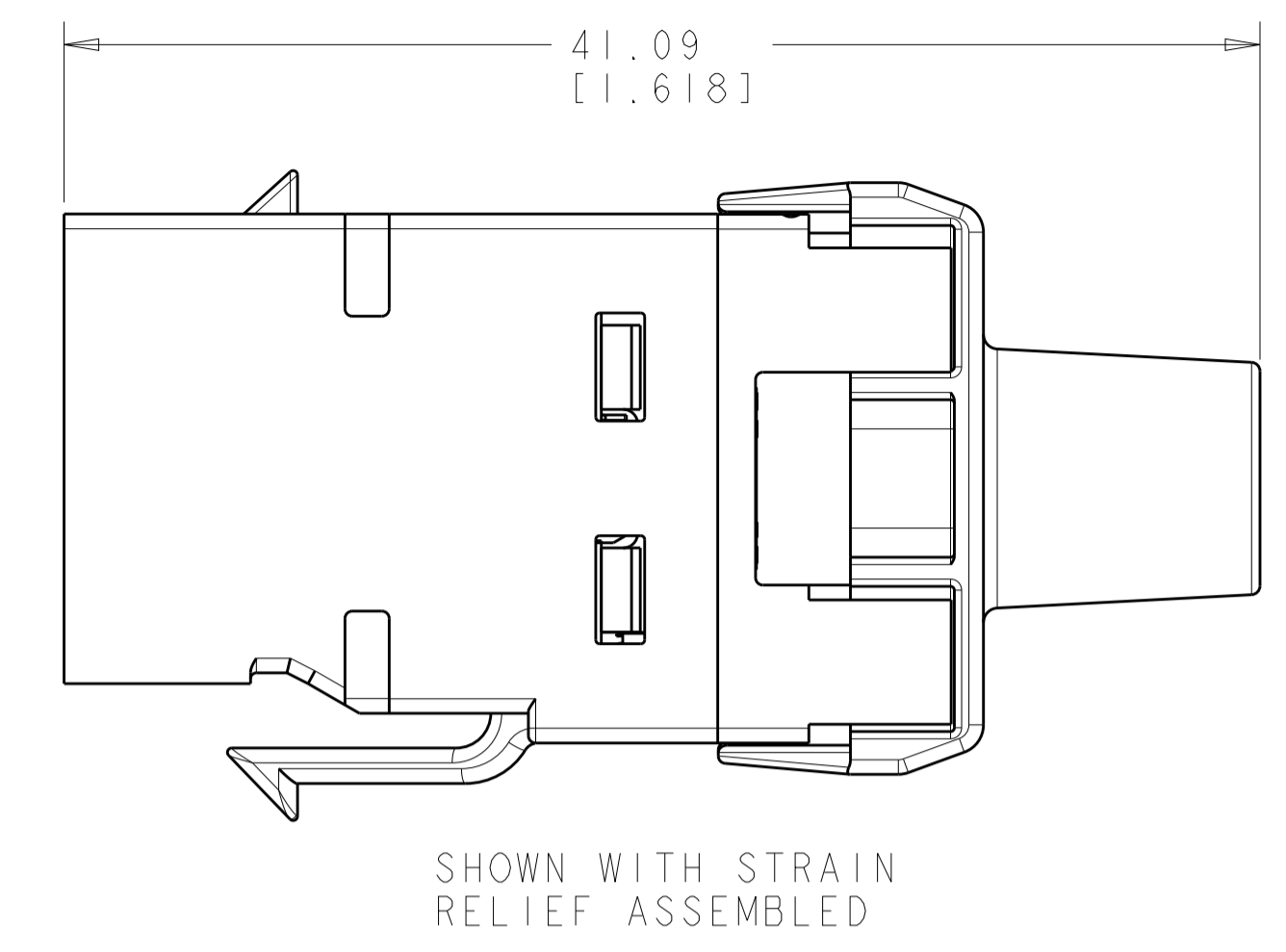

- 1. MATERIAL: JACK HOUSING - POLYCARBONATE, 94V-0 RATED. ARRAY TRAY - PBT POLYESTER. JACK CONTACTS ARRAY - BERYLLIUM COPPER, PLATED WITH 1.27µm [.000050] MINIMUM THICK GOLD IN LOCALIZED AREA AND 3.81µm [.000150] MINIMUM THICK MATTE TIN IN BOARD INTERFACE AREA OVER 1.27µm [.000050] MINIMUM THICK NICKEL UNDERPLATE.
- 2. KL 110 JACK WILL TERMINATE 22-24 AWG SOLID AND 24-26 AWG STRANDED CONDUCTORS, 1.27[.050] MAXIMUM INSULATION DIAMETER. JACK WILL ACCEPT CONDUCTORS UP TO 1.45 [.057] BUT REQUIRE THE USE OF A STRAIN RELIEF.
- 3. CAVITY CONFORMS TO FCC RULES AND REGULATIONS; PART 68 SUBPART F REQUIREMENTS.
- 4. MOUNTING PANEL THICKNESS 1.22 - 1.55 [.048 - .061].
- 5. THESE TWO SUGGESTED CUTOUT OPENINGS ARE USED IN TANDEM WITH DUAL FRONT AND BACK CUTOUTS.
- 6. ONE MODULAR JACK ASSEMBLY AND ONE STRAIN RELIEF PER POLYBAG.
- 7. USE OF STRAIN RELIEF IS OPTIONAL.
- 8. REFER TO 408-8858 FOR TERMINATION INSTRUCTIONS USING SL SERIES TOOL TERMINATION. REFER TO 408-8417 FOR TERMINATION INSTRUCTIONS USING 110 PUNCH DOWN TOOL.

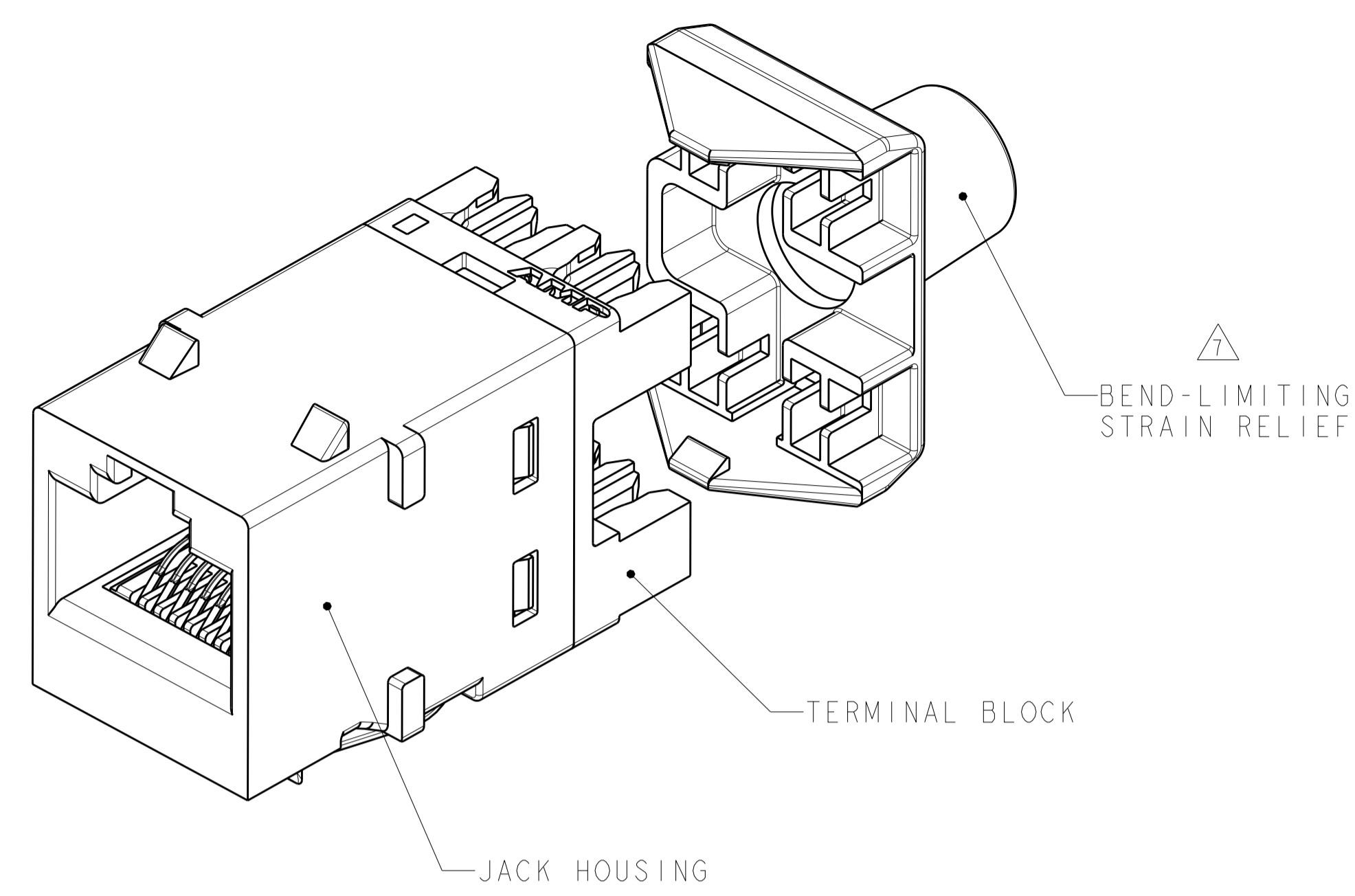
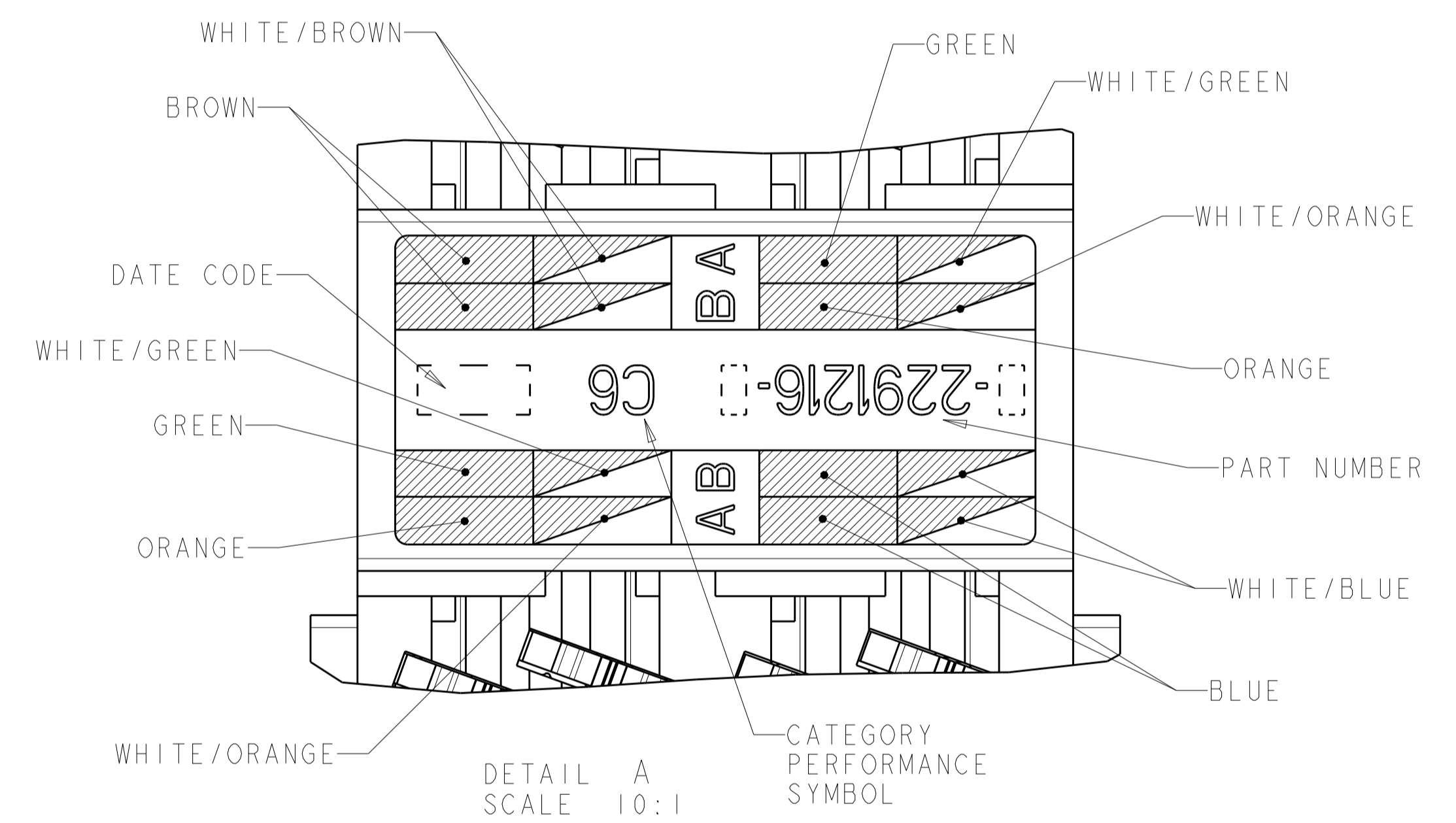
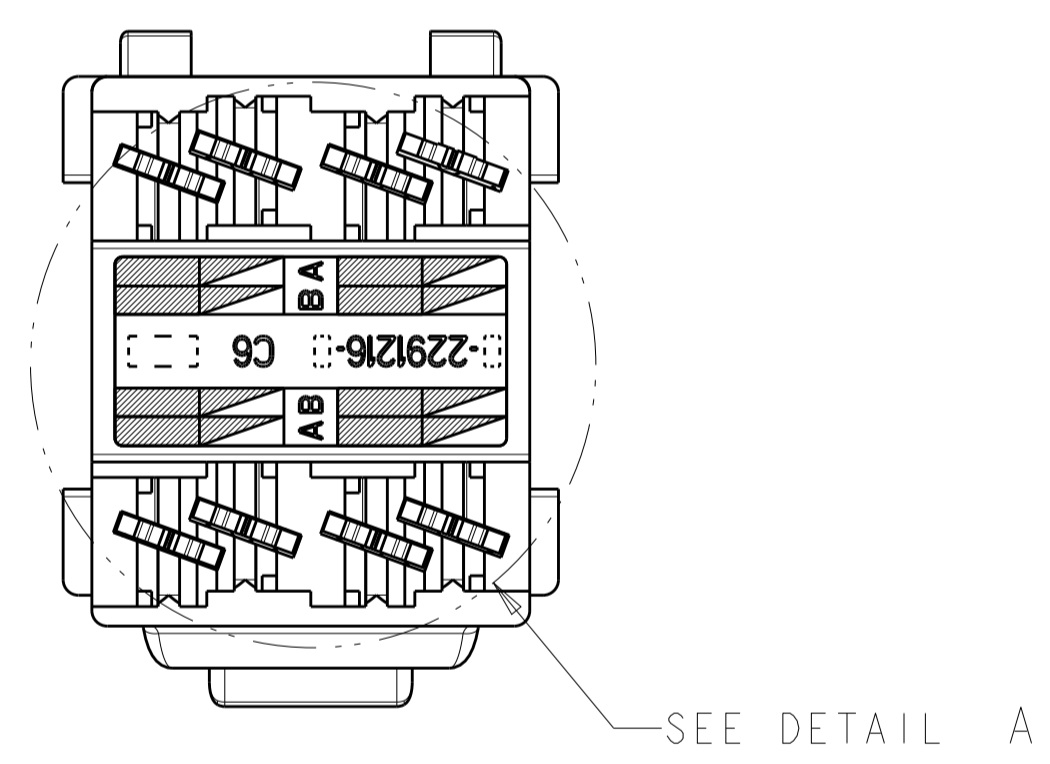
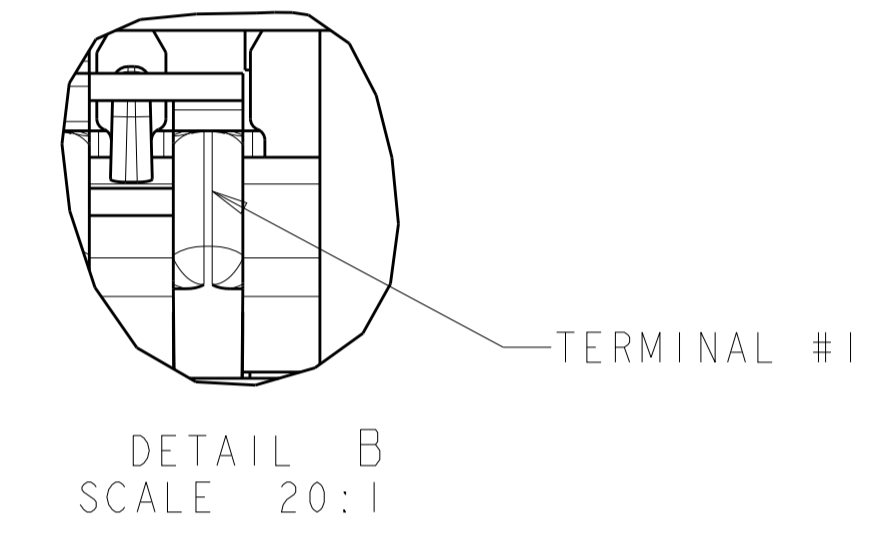
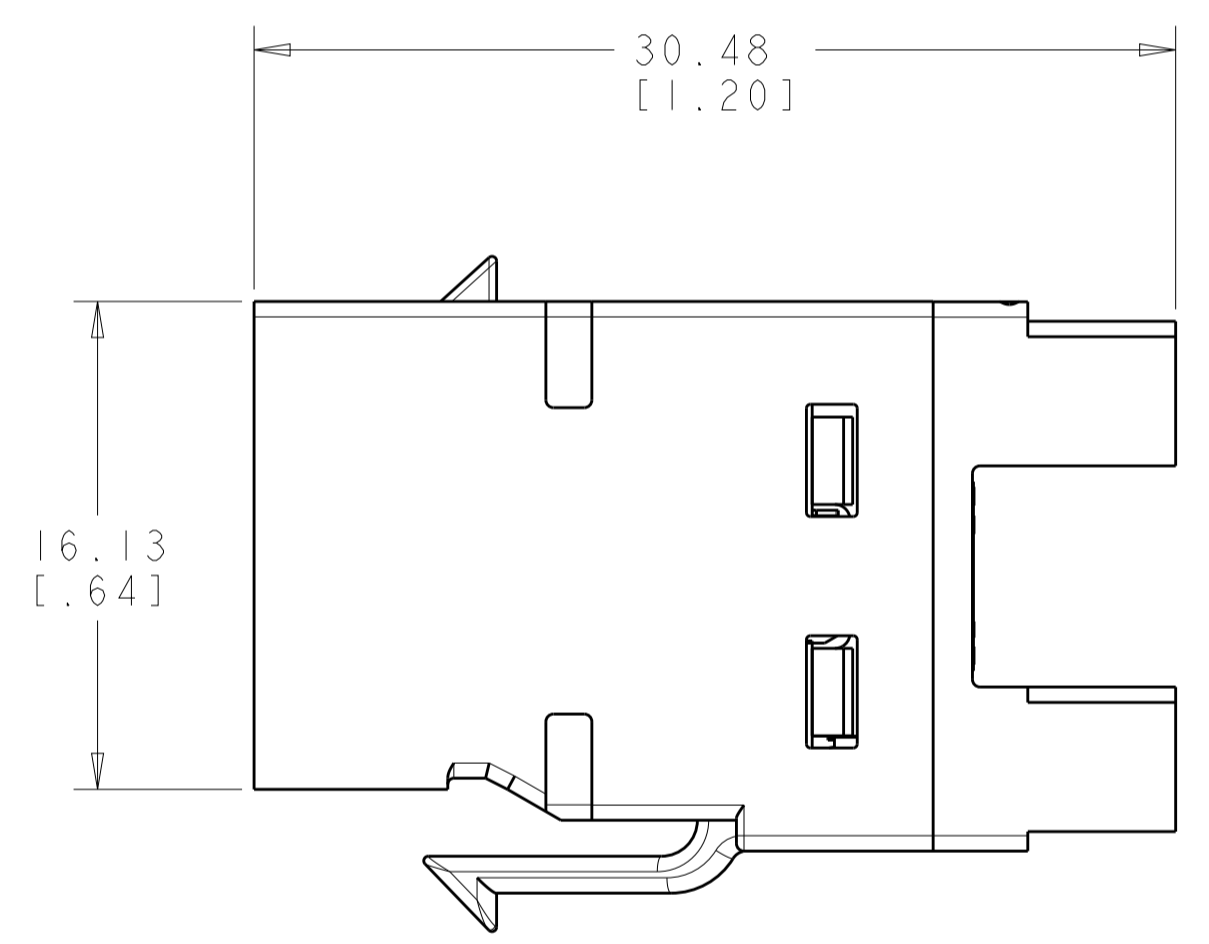
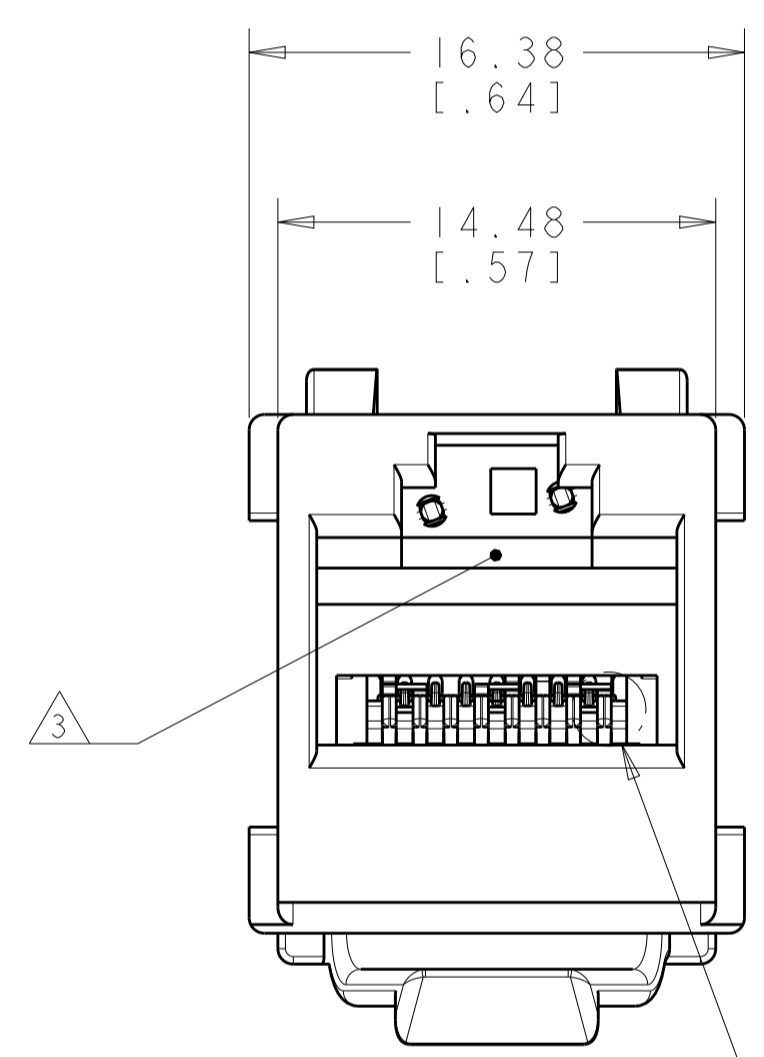

COLOR CODE	IDC TERMINAL	MODULAR JACK	
WHITE/BLUE	5	5	
BLUE	4	4	
WHITE/ORANGE	3	3	
ORANGE	6	6	
WHITE/GREEN	1	1	
GREEN	2	2	
WHITE/BROWN	7	7	
BROWN	8	8	

ELECTRICAL SCHEMATIC T568A

COLOR CODE	IDC TERMINAL	MODULAR JACK	
WHITE/BLUE	5	5	
BLUE	4	4	
WHITE/ORANGE	1	1	
ORANGE	2	2	
WHITE/GREEN	3	3	
GREEN	6	6	
WHITE/BROWN	7	7	
BROWN	8	8	

ELECTRICAL SCHEMATIC T568B

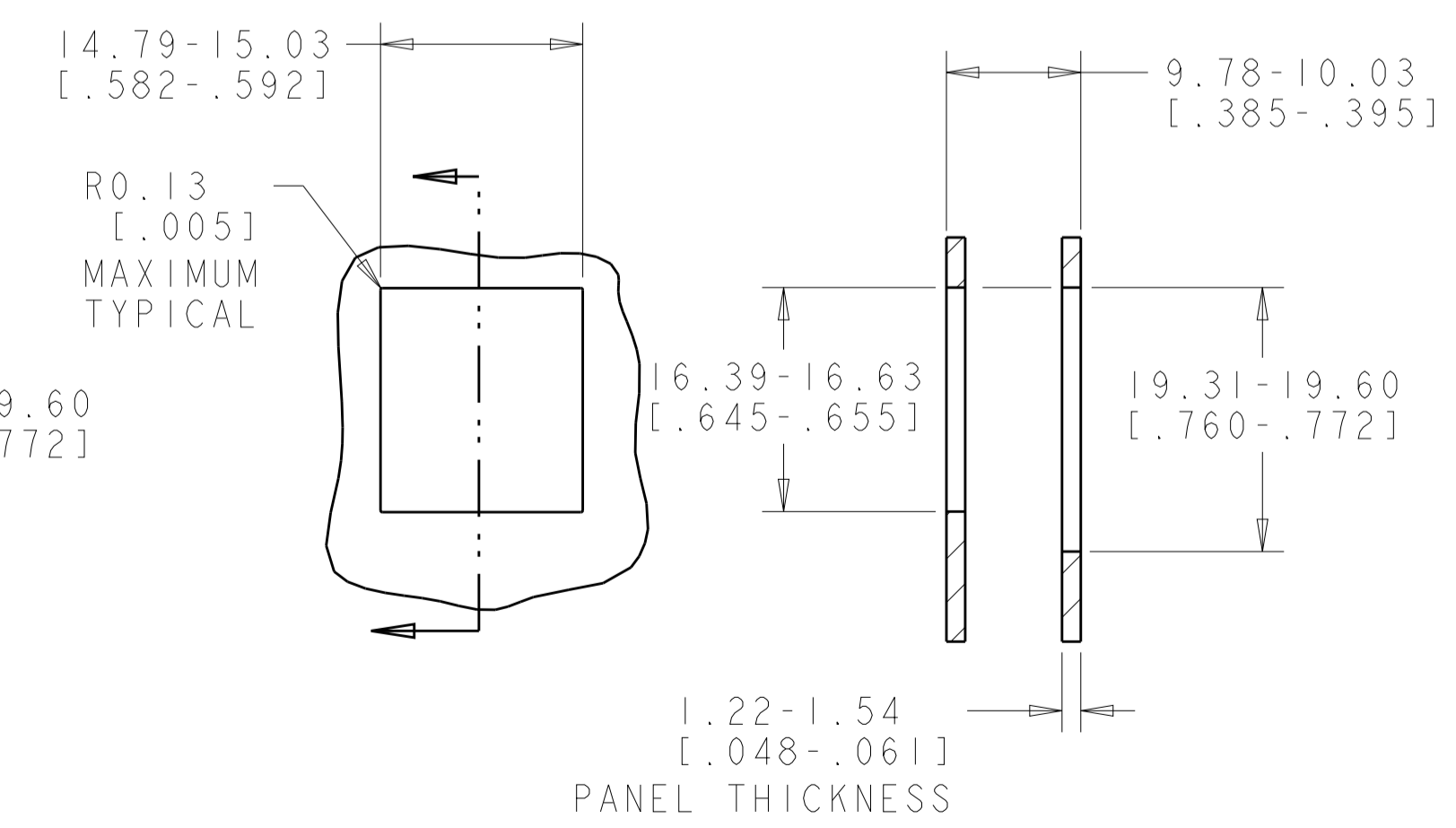
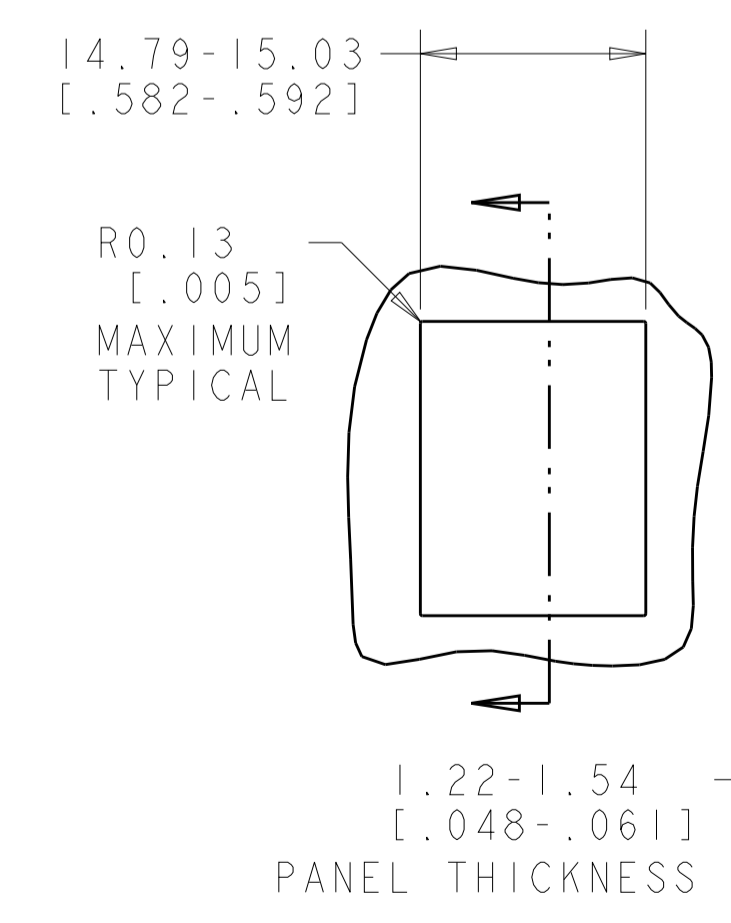

PACKAGE	HOUSING COLOR	PART NUMBER
ALPINE WHITE		1-2291216-3
ELECTRIC IVORY		1-2291216-1
VIOLET		1-2291216-0
GREEN		2291216-9
YELLOW		2291216-8
RED		2291216-7
BLUE		2291216-6
ORANGE		2291216-5
NEMA GRAY		2291216-4
WHITE		2291216-3
BLACK		2291216-2
LIGHT ALMOND		2291216-1

THIS DRAWING IS A CONTROLLED DOCUMENT.

OWN: G. GARRETT 17MAR2015
 CH: L. SCHLOSS 17MAR2015
 APVD: L. SCHLOSS 17MAR2015

TE Connectivity

ASSY, CAT 6, UTP, KL SERIES JACK

SIZE: CAGE CODE: DRAWING NO: A100779C=2291216
 RESTRICTED TO: -

Customer Drawing SCALE: 4:1 SHEET 1 OF 1 REV A