

DESCRIPTION: HIGH DENSITY MALE - SOLDER CUP - SEALED

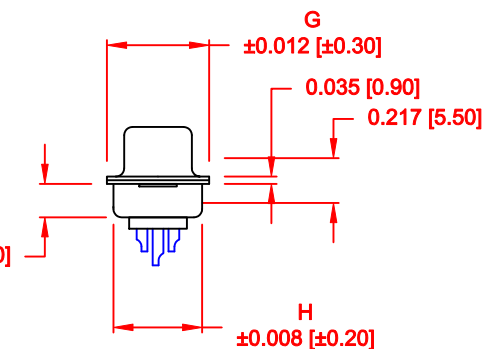
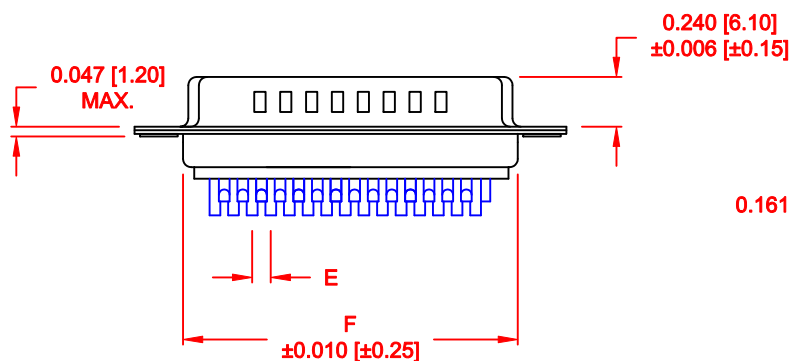
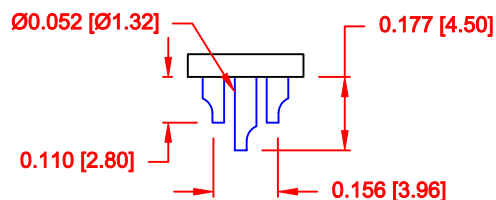
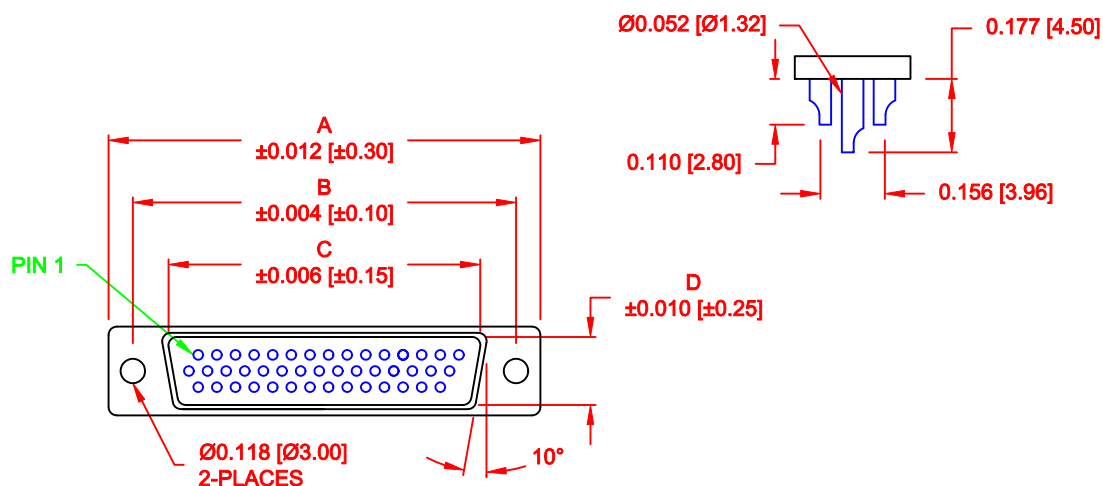

MATERIAL:

SHELL: STEEL, NICKEL PLATED
INSULATOR: PBT, UL 94V-O RATED,
+30% FIBER-GLASS OR NYLON-66
CONTACT: BRASS, GOLD PLATED OVER NICKEL
SEAL: F08 FLEXIBLE ADHESIVE

ELECTRICAL:

CURRENT RATING: 5 AMPS
CONTACT RESISTANCE: 15 mOhms Max.
INSULATION RESISTANCE: 1,000 MOhms min.
VOLTAGE: 500VAC FOR 1 MINUTE
TEMPERATURE: -50° C TO 100° C

RoHS COMPLIANT

MEETS IP66 STANDARDS

(SEE PAGE 2FOR SEALING DETAILS)

NOTE: WILL ACCEPT UP TO 24 AWG WIRE

DO NOT SCALE FROM DRAWING

No. OF PINS	DIMENSIONS							
	A	B	C	D	E	F	G	H
15	1.213	0.984	0.666	0.329	0.090	0.756	0.496	0.429
	30.80	24.99	16.92	8.36	2.29	19.20	12.60	10.90
26	1.543	1.312	0.978	0.329	0.090	1.091	0.496	0.429
	39.20	33.32	25.25	8.36	2.29	27.70	12.60	10.90
44	2.087	1.852	1.534	0.329	0.090	1.618	0.496	0.429
	53.00	47.04	38.85	8.36	2.29	41.10	12.60	10.90

680-YYY-103LYY1

SERIES
POSITIONS

015
026
044

GENDER
1 = MALE

TERMINATION
0 = SOLDER CUP

SHELL PLATING
3 = NICKEL (GROUND INDENTS)

RoHS COMPLIANT (230°C)
HARDWARE OPTIONS

00 = NO HARDWARE
01 = .098" CLINCH NUT (BOARD SIDE)
02 = .236" CLINCH NUT (BOARD SIDE)
03 = .236" CLINCH NUT (MATING SIDE)

PLATING OPTIONS
1 = GOLD FLASH
2 = 30u" GOLD



THESE DRAWINGS AND SPECIFICATIONS ARE THE PROPERTY OF NorComp AND SHALL NOT BE REPRODUCED, COPIED OR USED AS THE BASIS FOR THE MANUFACTURE OF SALE OF APPARATUS WITHOUT WRITTEN PERMISSION.

NorComp

DRAWN:
P. JENKINS

DATE:
11-24-11

CHECKED:

DATE:

SCALE:
1 : 1

SHEET
1 OF 2

REV
0

DWG NO. 680-YYY-103LYY1

DESCRIPTION: CLINCH NUT HARDWARE

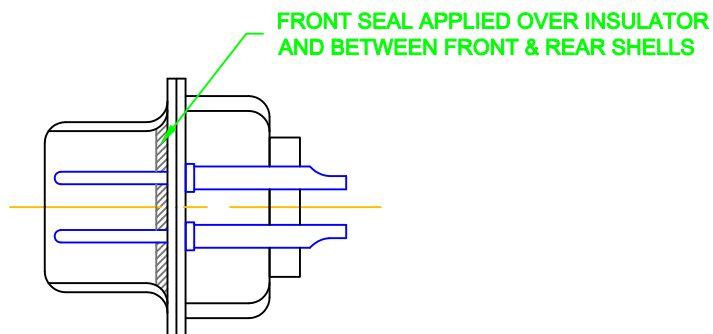
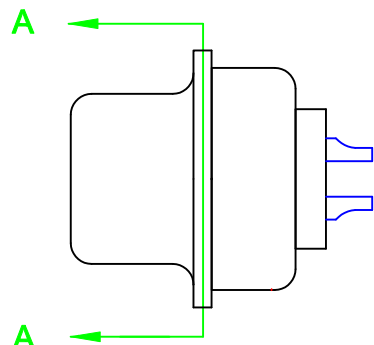

DETAIL A-A
SHOWN FOR REFERENCE ONLY

RoHS COMPLIANT

TOLERANCE:
ALL DIMENSIONS ARE ± 0.010

ALL CLINCH-NUTS ARE 4-40 INTERNAL THREADS

01X 0.098" (BOARD SIDE) - CN1

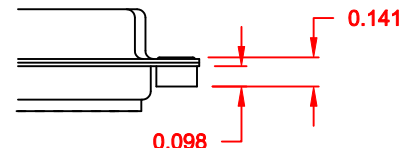

02X 0.236" (BOARD SIDE) - CN2

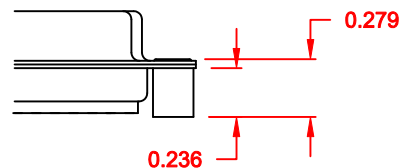

03X..... 0.236" (MATING SIDE) - CN8

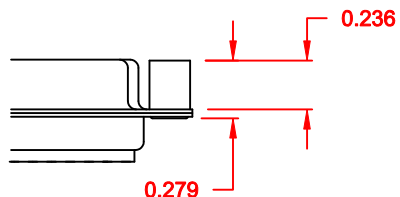

DO NOT SCALE FROM DRAWING



THESE DRAWINGS AND SPECIFICATIONS ARE THE PROPERTY OF NorComp AND SHALL NOT BE REPRODUCED, COPIED OR USED AS THE BASIS FOR THE MANUFACTURE OF SALE OF APPARATUS WITHOUT WRITTEN PERMISSION.

DRAWN: P. JENKINS		DATE: 11-24-11	
CHECKED:		DATE:	
SCALE: FULL	SHEET 2	OF 2	REV 0
DWG NO. 680-YYY-103LYY1			

NorComp