

4.3-10
SMA

Adaptor
4.3-10 plug – SMA jack

32K164-S00N1

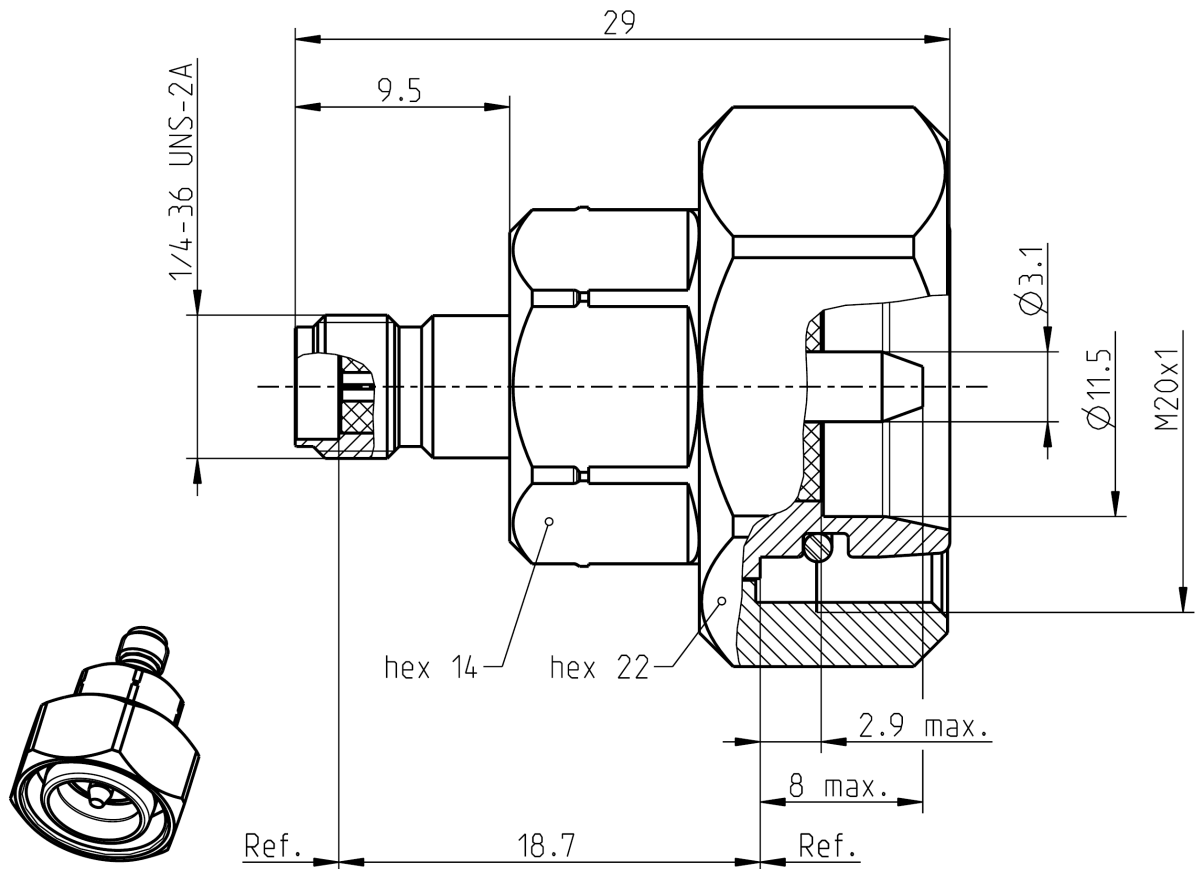

All dimensions are in mm; tolerances according to ISO 2768 m-H

Interface

| | | |
|--------------|--------------|---|
| According to | 4.3-10 side: | IEC 61169-54 |
| | SMA side: | IEC 60169-15, EN 122110, MIL-STD-348A, Fig. 310 |

Documents

| | |
|----------------------|-----|
| Assembly instruction | N/A |
|----------------------|-----|

Material and plating

Connector parts

| | | | | |
|----------------|--------------|----------|----------------|--|
| Center contact | 4.3-10 side: | Brass | Plating | Silver, 3-6 µm |
| Center contact | SMA side: | CuBe | | AuroDur®, gold plated |
| Body | | Brass | | Flash white bronze over silver(e.g. Optargen®) |
| Dielectric | | PTFE | | |
| Gasket | | Silicone | | |

Dieses Dokument ist urheberrechtlich geschützt • This document is protected by copyright • Rosenberger Hochfrequenztechnik GmbH & Co. KG

RF_35/05.10/6.0

