

DIMENSIONS: mm

101-H3B16-EV

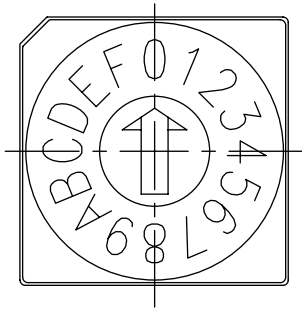

101-H3B10-EV

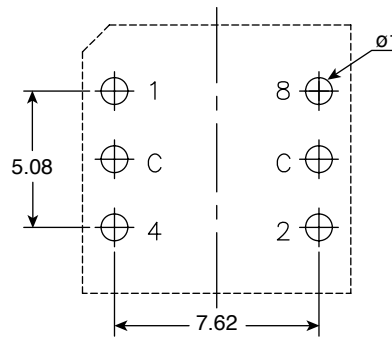
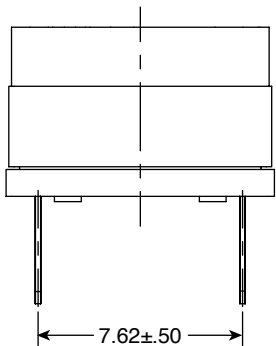
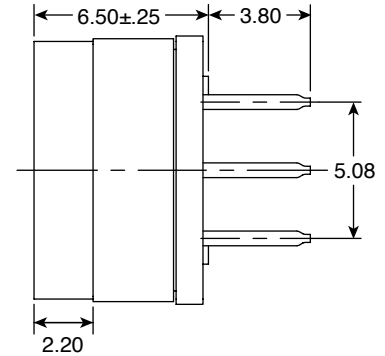
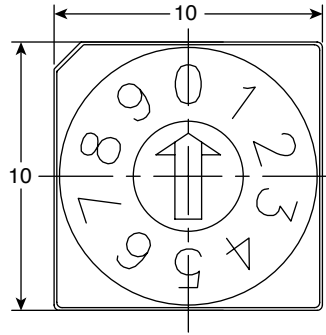

P.C.B. LAYOUT

| Type | Circuit Characteristics | | | | | | | | | | | | | | | |
|---------|-------------------------|----------|---|---|---|---|---|---|---|---|------|---|---|---|---|---|
| | Code | Position | | | | | | | | | x ON | | | | | |
| | 0 | 1 | 2 | 3 | 4 | 5 | 6 | 7 | 8 | 9 | A | B | C | D | E | F |
| 10 STEP | 1 | | x | | x | | x | | x | | x | | | | | |
| | 2 | | | x | x | | x | x | | | | | | | | |
| | 4 | | | | | x | x | x | x | | | | | | | |
| | 8 | | | | | | | | | x | x | | | | | |
| Type | Circuit Characteristics | | | | | | | | | | | | | | | |
| | Code | Position | | | | | | | | | x ON | | | | | |
| | 0 | 1 | 2 | 3 | 4 | 5 | 6 | 7 | 8 | 9 | A | B | C | D | E | F |
| 16 STEP | 1 | | x | | x | | x | | x | | x | | x | | x | |
| | 2 | | | x | x | | x | x | | | x | x | | x | x | |
| | 4 | | | | | x | x | x | x | | | | x | x | x | x |
| | 8 | | | | | | | | | x | x | x | x | x | x | x |

Electrical Specifications:

- Rating: Non-Switching Rating 400mA/24VDC
Switching Rating 150mA/24VDC
- Initial Contact Resistance: 100mΩ Max.
- Dielectric Strength: 250VAC 1 Minute
- Insulation Resistance: 100MΩ Min. (250VDC Megger)

Mechanical Specifications:

- Operating Force: 400gf cm Max.
- Operating Temperature: -60°C to 125°C

Note:

- RoHS Compliant

Coded Rotary Switches
101-H3B10-EV, 101-H3B16-EV

