

ORDERING CODE: M R J - 5 4 8 X - X B

SERIES, RUGGED RJ
 RECEPTACLE
 VERTICAL MOUNT
 NUMBER OF CONTACTS
 LED OPTION
 0=NONE
 1=GREEN LEFT, YELLOW RIGHT
 4=YELLOW LEFT, GREEN RIGHT
 5=GREEN LEFT, GREEN RIGHT
 CONTACT TAIL OPTION
 0=TAIL LENGTH A=2.54 [.100]
 B=TAIL LENGTH A=3.81 [.150]
 SINGLE PORT WITH GASKET
 FOR REAR PANEL MOUNT

SPECIAL CONNECTORS:

MANY UNIQUE FEATURES ARE READILY AVAILABLE TO
 SUIT CUSTOMER REQUIREMENTS. CONSULT WITH
 AMPHENOL CANADA FOR DETAILS

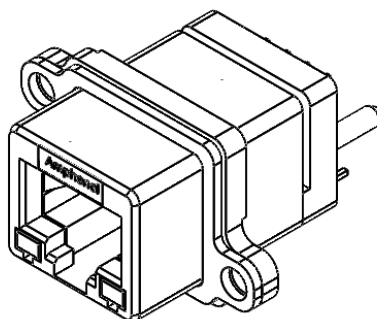
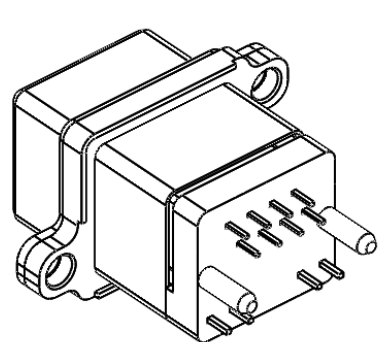
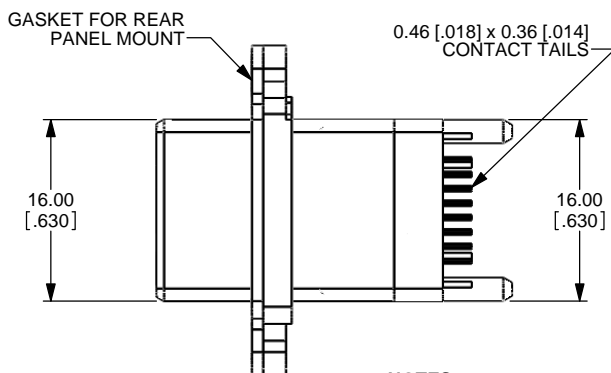

NOTES:

- MATERIAL:**
 ALL MATERIALS ARE RoHS COMPLIANT PER EU DIRECTIVE 2002/95/EC AND AMENDMENTS
 - SHELL - DIECAST ZINC, NICKEL PLATED
 - CONTACTS - PHOSPHOR BRONZE WITH 50 MICROINCHES (1.27 MICRONS) GOLD OVER 50 MICROINCHES (1.27 MICRONS) MINIMUM NICKEL ON THE MATING AREA AND MATTE TIN OVER NICKEL ON THE CONTACT TAILS.
 - INSERTS - ENGINEERING THERMOPLASTIC, UL FLAMMABILITY RATING 94V-0, REAR INSERTS: BLACK NYLON, FRONT INSERT: CLEAR POLYCARBONATE.
 - GASKET - SILICONE RUBBER
 - LED'S - EPOXY LENS, STEEL TAILS WITH TIN PLATING
- ENVIRONMENTAL PERFORMANCE PER IEC 60529 CODE IP67 FOR SEAL BETWEEN MATING AREA AND PCB SIDE OF CONNECTOR. GASKET PROVIDES FOR SEAL TO INSIDE FACE OF PANEL.
- CURRENT RATING: 1.5 AMPERES.
- CONTACT RESISTANCE: 30 MILLIOHMS MAXIMUM.
- OPERATING TEMPERATURE: -40°C TO +105°C.
- AVAILABLE MATING AREA COVERS PROVIDE ADDED PROTECTION. CONSULT WITH AMPHENOL CANADA FOR DETAILS.
- CUSTOMER TO VERIFY THAT ANY PROCESS CLEANERS USED ARE COMPATIBLE WITH POLYCARBONATE MATERIAL.



UNLESS SPECIFIED OTHERWISE	DRAWN	M.SHAH	JUL20/11
PRIMARY UNITS MILLIMETERS	CHECKED		
SECONDARY INCHES	M.E. APP'D		
REFERENCE IN PARENTHESES	Q.A. APP'D		
GENERAL TOLERANCES	DWG APPR.	K.LAMBIE	JUL20/11
1 DECIMAL PLACE	ENG. REL. NO.		
2 DECIMAL PLACES	REF.		
3 DECIMAL PLACES	THIRD ANGLE PROJECTION		
ANGULAR DEGREES	DO NOT SCALE DRAWING		

Amphenol Canada Corp. www.amphenolcanada.com MRJ SERIES RUGGED MODULAR JACK, 8 POSITION VERTICAL, LED AND TAIL LENGTH OPTIONS, REAR PANEL MOUNT, RoHS COMPLIANT			
P-MRJ-548X-XB			REV A
CODE ID NO. 03554	DWG SIZE: X	SCALE: 3:1	SHEET 1 OF 2

REVISIONS			
REV	DESCRIPTION, ECN, EAR NO.	DATE	APP'D
A	PRODUCT DRAWING (EAR 13915)	JUL20/11	K.L.

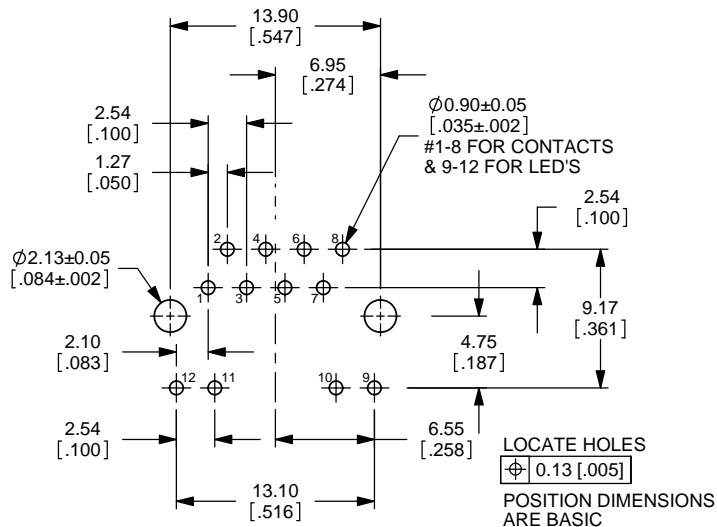

RECOMMENDED P.C.B. LAYOUT
(COMPONENT SIDE OF BOARD)

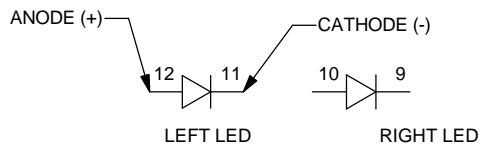

LED SCHEMATIC
(GREEN OR YELLOW)

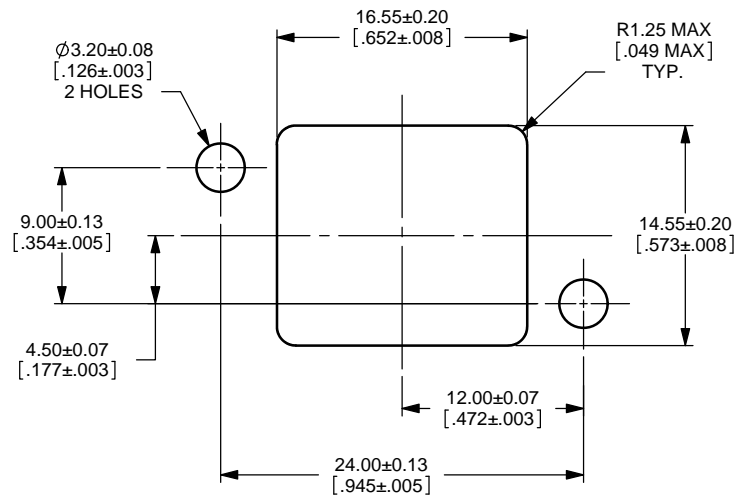

RECOMMENDED PANEL CUTOUT
(FRONT OF PANEL)



UNLESS SPECIFIED OTHERWISE	DRAWN	M.SHAH	JUL20/11
PRIMARY UNITS MILLIMETERS	CHECKED		
SECONDARY INCHES	M.E. APP'D		
REFERENCE IN PARENTHESES	Q.A. APP'D		
GENERAL TOLERANCES	DWG APPR.	K.LAMBIE	JUL20/11
1 DECIMAL PLACE	ENG. REL. NO.		
2 DECIMAL PLACES	REF.		
3 DECIMAL PLACES	THIRD ANGLE PROJECTION		
ANGULAR DEGREES	DO NOT SCALE DRAWING		

Amphenol Canada Corp. www.amphenolcanada.com			
MRJ SERIES RUGGED MODULAR JACK, 8 POSITION VERTICAL, LED AND TAIL LENGTH OPTIONS, REAR PANEL MOUNT, RoHS COMPLIANT			
P-MRJ-548X-XB			REV A
CODE ID NO. 03554	DWG SIZE: X	SCALE: 4:1	SHEET 2 OF 2