



**620-048**  
**Strain Relief**  
**Self-Locking Rotatable Coupling - Straight and 90°**

**CONNECTOR  
DESIGNATOR**

MIL-DTL-38999 Series I, II (F)  
MIL-DTL-38999 Series III and IV (H)

**F-H**

**SELF-LOCKING  
ROTATABLE  
COUPLING**

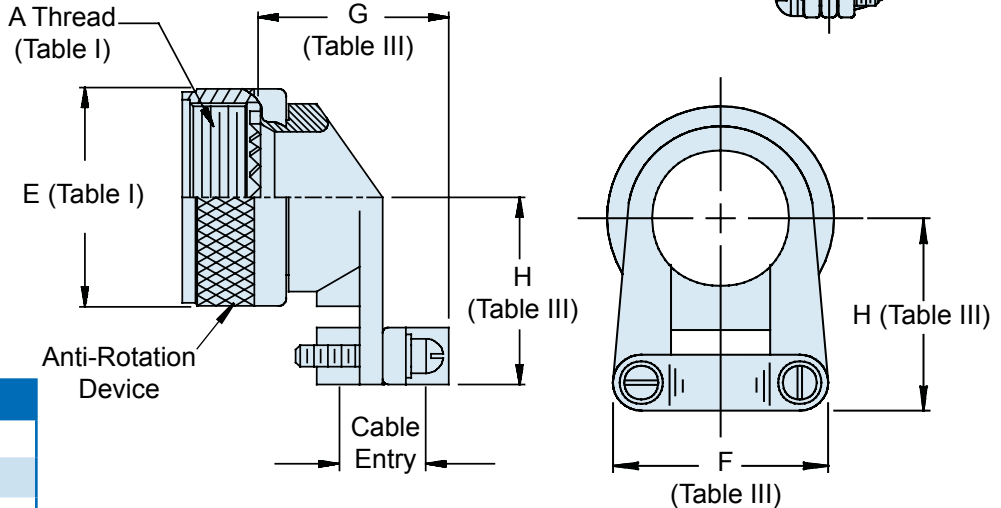
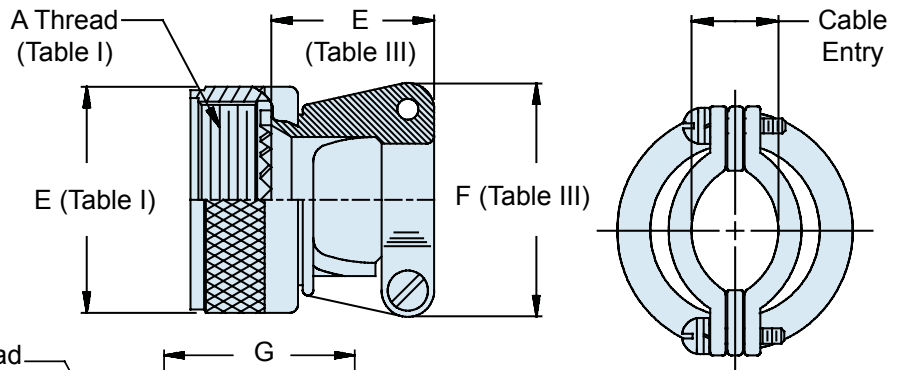
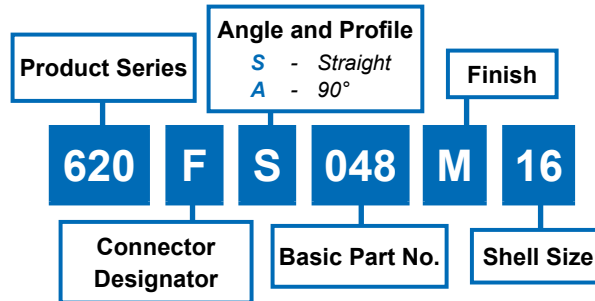

**APPLICATION NOTES**

1. Cable range is defined as the accommodation range for the wire bundle or cable. Dimensions shown are not intended for inspection criteria.
2. Metric dimensions (mm) are indicated in parentheses.

**TABLE II: FINISHES**

| Symbol | Finish  |
|--------|---|
| B      | Cadmium Plate, Olive Drab                         |
| C      | Anodize, Black                                    |
| G      | Hard Coat, Anodic                                 |
| GB     | Black Anodize, Hard Coat                          |
| M      | Electroless Nickel                                |
| N      | Cad Plate, Olive Drab over Electroless Nickel     |
| NF     | Cadmium Plate, Olive Drab over Electroless Nickel |
| MT     | Nickel Fluorocarbon Polymer                       |
| Z1     | Stainless Steel Passivate                         |
| ZN     | Zinc-Nickel                                       |

**TABLE III: CABLE ENTRY**

| Shell Size | Cable Range  |              | G Max        | H Max        | Cable Range |             |
|------------|--------------|--------------|--------------|--------------|-------------|-------------|
|            | E Max        | F Max        |              |              | Closed      | Open        |
| 08/09      | .830 (21.1)  | .780 (19.8)  | .704 (17.9)  | .808 (20.5)  | .098 (2.5)  | .234 (5.9)  |
| 10/11      | .850 (21.6)  | .832 (21.1)  | .786 (20.0)  | .867 (22.0)  | .153 (3.9)  | .234 (5.9)  |
| 12/13      | .900 (22.9)  | .988 (25.1)  | .979 (24.9)  | .929 (23.6)  | .190 (4.8)  | .328 (8.3)  |
| 14/15      | .900 (22.9)  | 1.046 (26.6) | 1.039 (26.4) | .992 (25.2)  | .260 (6.6)  | .457 (11.6) |
| 16/17      | .940 (23.9)  | 1.319 (33.5) | 1.188 (30.2) | 1.056 (26.8) | .283 (7.2)  | .614 (15.6) |
| 18/19      | 1.020 (25.9) | 1.451 (36.9) | 1.300 (33.0) | 1.233 (31.3) | .325 (8.3)  | .634 (16.1) |
| 20/21      | 1.070 (27.2) | 1.557 (39.5) | 1.425 (36.2) | 1.296 (32.9) | .343 (8.7)  | .698 (17.7) |
| 22/23      | 1.190 (30.2) | 1.653 (42.0) | 1.550 (39.4) | 1.358 (34.5) | .381 (9.7)  | .823 (20.9) |
| 24/25      | 1.220 (31.0) | 1.775 (45.1) | 1.675 (42.5) | 1.420 (36.1) | .418 (10.6) | .853 (21.7) |