

## DETAILS

Product Number	CA14434_MINNIE-LT-M
Family	Minnie
Type	RefAssy
Color	metal
Diameter	35 mm
Height	15.6 mm
Style	round
Optic Material	PC
Holder Material	
Fastening	tape
Status	ready
ROHS Compliant	Yes
Date Updated	7/08/2015



## OPTICAL PROPERTIES

LED	Viewing	Light	Efficiency	cd/lm	Connector
	Angle	Beam			
MK-R	21 deg	Medium	92 %	2.840	-
LUXEON M	21 deg	Medium	92 %	2.900	-
XHP50	28 deg	Medium	90 %	1.690	-
Duris S10	31 deg	Medium	91 %	1.800	-

Relative intensity of CA14434\_MINNIE-LT-M\_(MK-R)

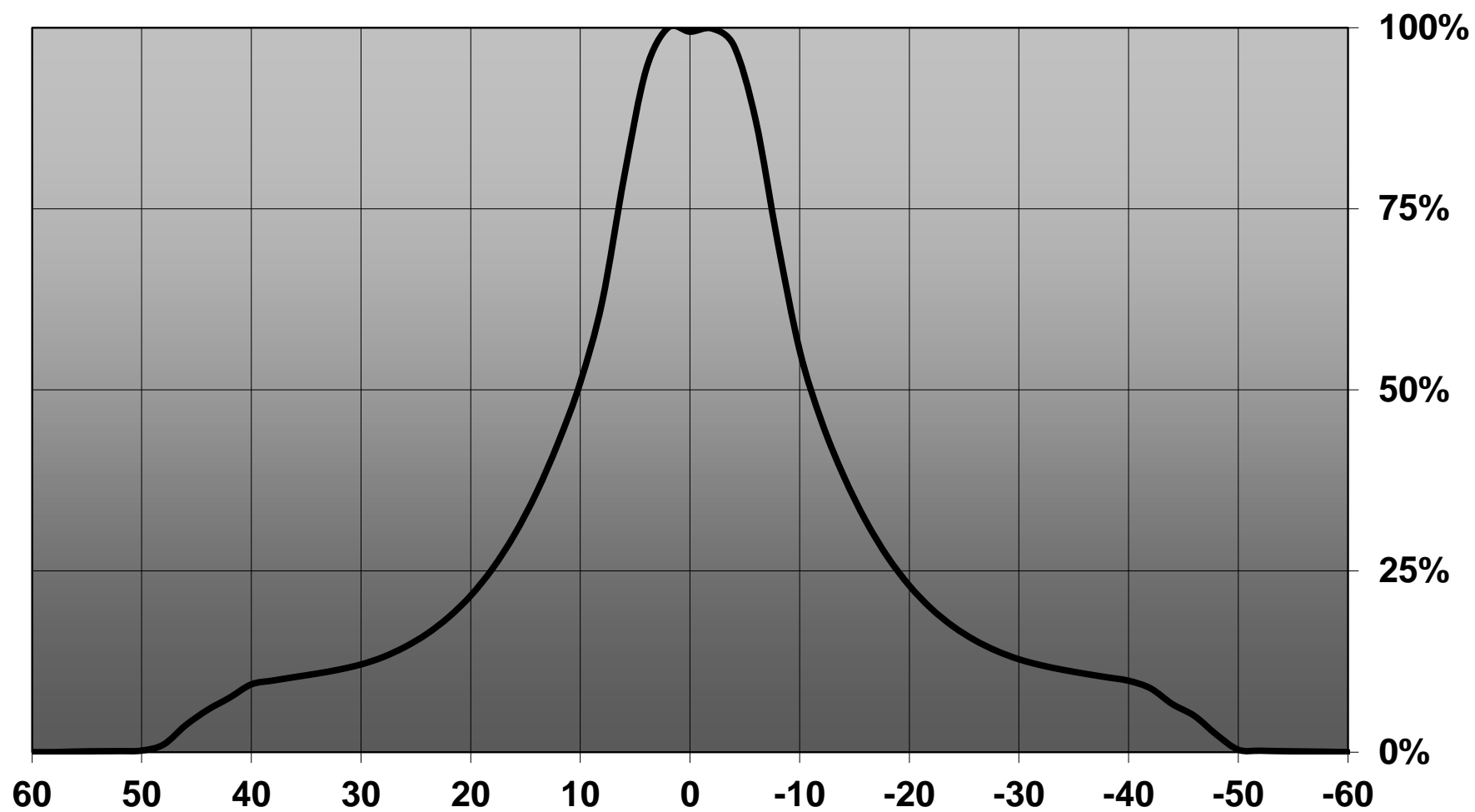

Relative intensity of CA14434\_MINNIE-LT-M\_(Luxeon\_M)

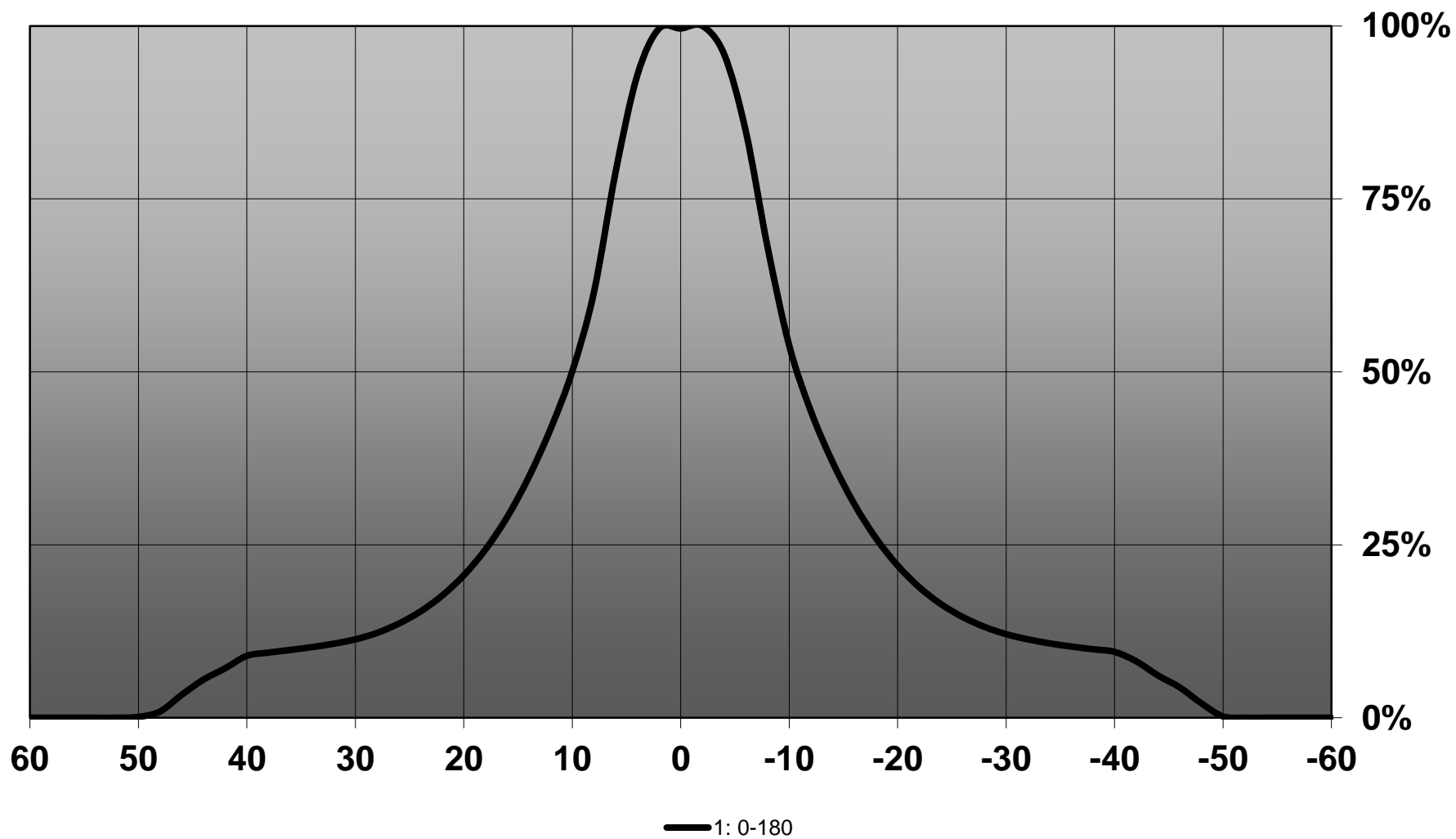

**Relative intensity of CA14434\_MINNIE-LT-M \_(XHP50)**

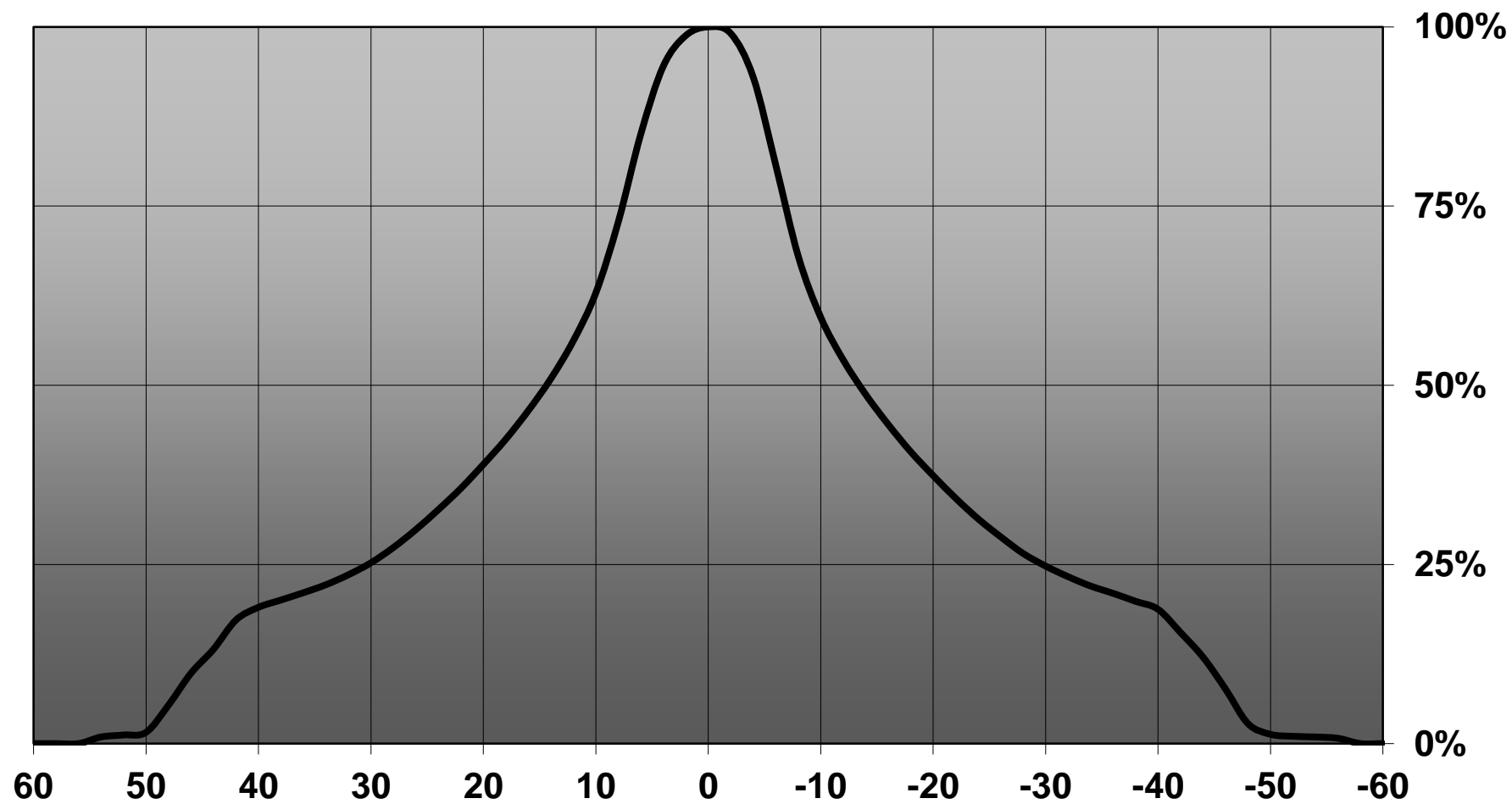

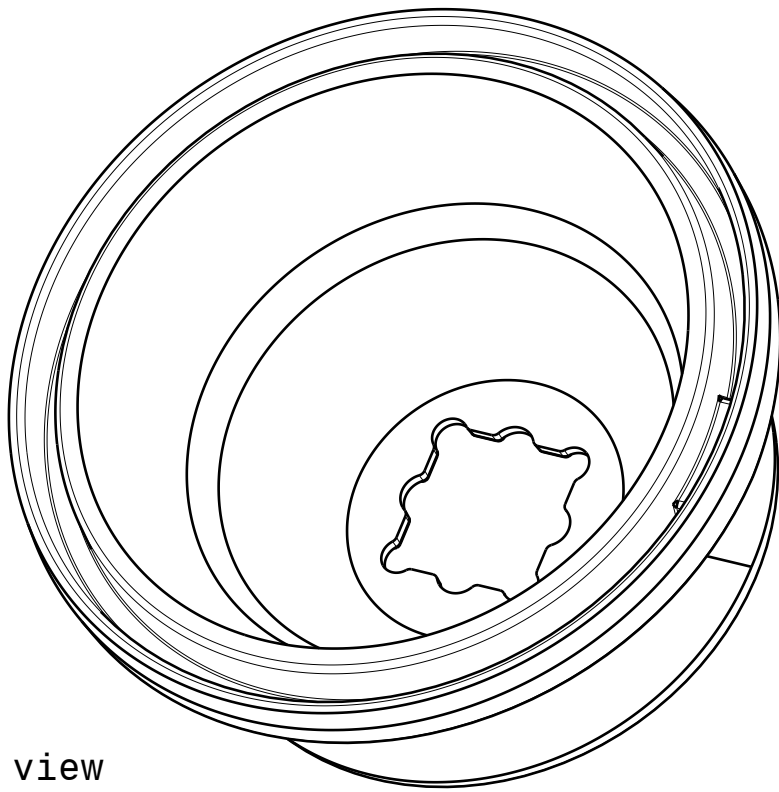
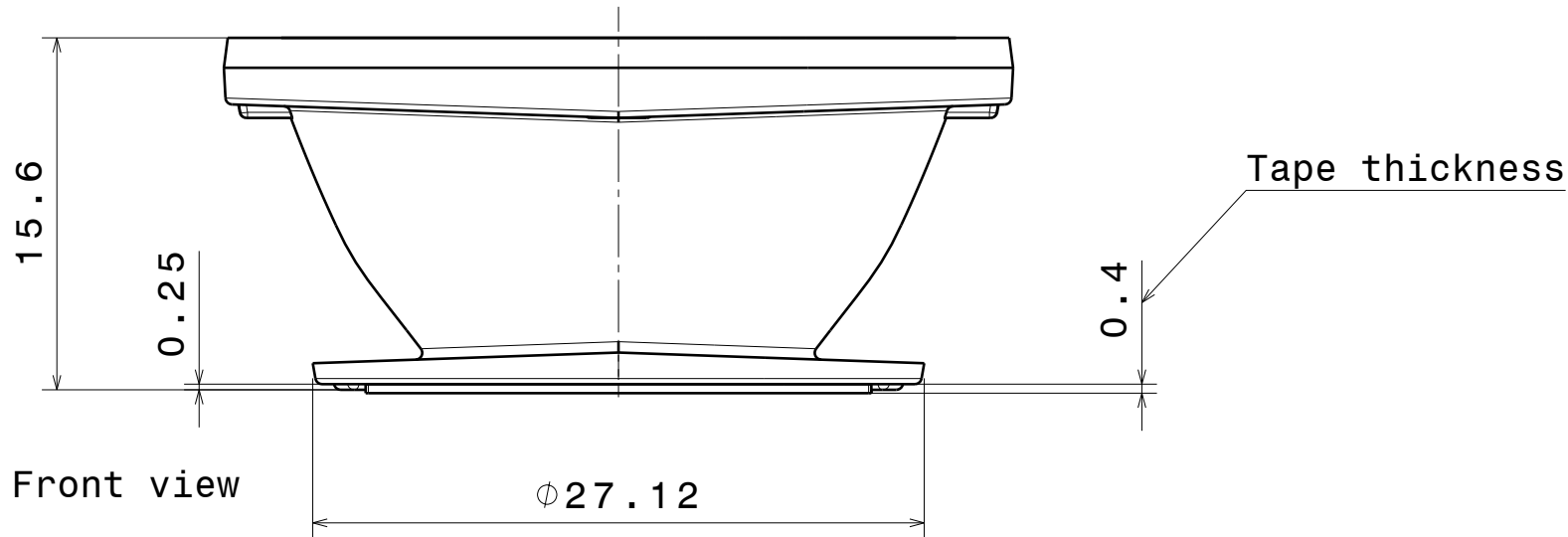

Isometric view

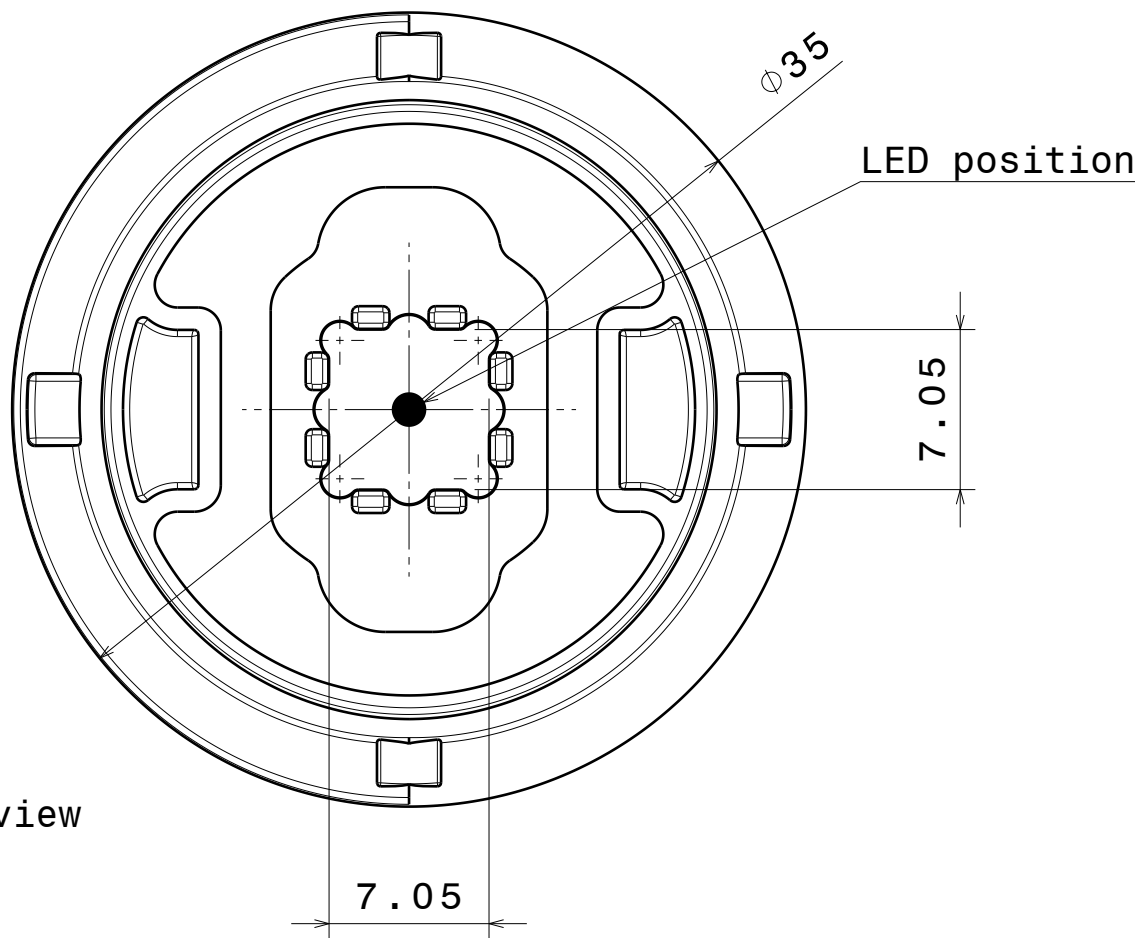

INDEX	PART NO	DESCRIPTION	MATERIAL	COLOUR
1	C14271	Reflector	PC	Metal
2	C10253	Tape	PU	Black

Tolerances if not otherwise shown  
According to DIN ISO 2768-1  
Linear measures: class C  
According to DIN ISO 2768-2  
Form and position: class L

LEDiL

Ledil Oy  
Salorankatu 10  
FIN 24240 SALO  
Finland

THIRD ANGLE PROJECTION:



DRAWING TITLE

CA14434\_MINNIE-LT-M

This drawing is the property  
of LEDiL Oy. It may not be  
reproduced, copied or  
communicated without a written  
agreement with LEDiL Oy.

SIZE

PART NUMBER

A3

CA14434

SCALE

3:1

WEIGHT

-

SHEET

1/1

Luminaire: LEDil Oy CA14434\_MINNIE-LT-M (Luxeon\_M)  
Lamps: 1 x Philips Lumileds Luxeon M (LXR7-SW30) 361.06lm @ 250mA CCT=3056K P=2.8W I=250mA

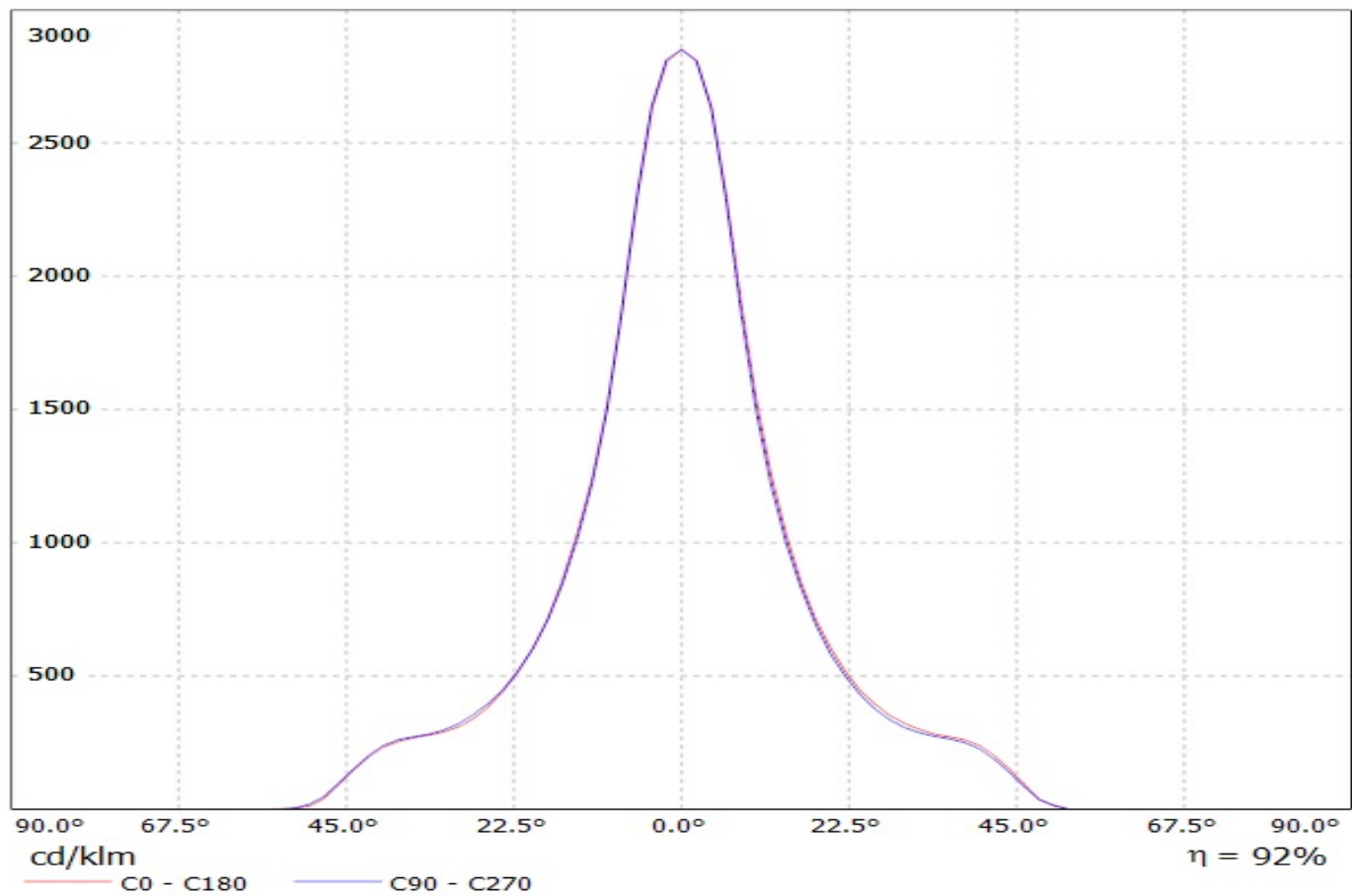

Luminaire: LEDil Oy CA14434\_MINNIE-LT-M\_(Luxeon\_M)  
Lamps: 1 x Philips Lumileds Luxeon M (LXR7-SW30) 361.06lm @ 250mA CCT=3056K P=2.8W I=250mA

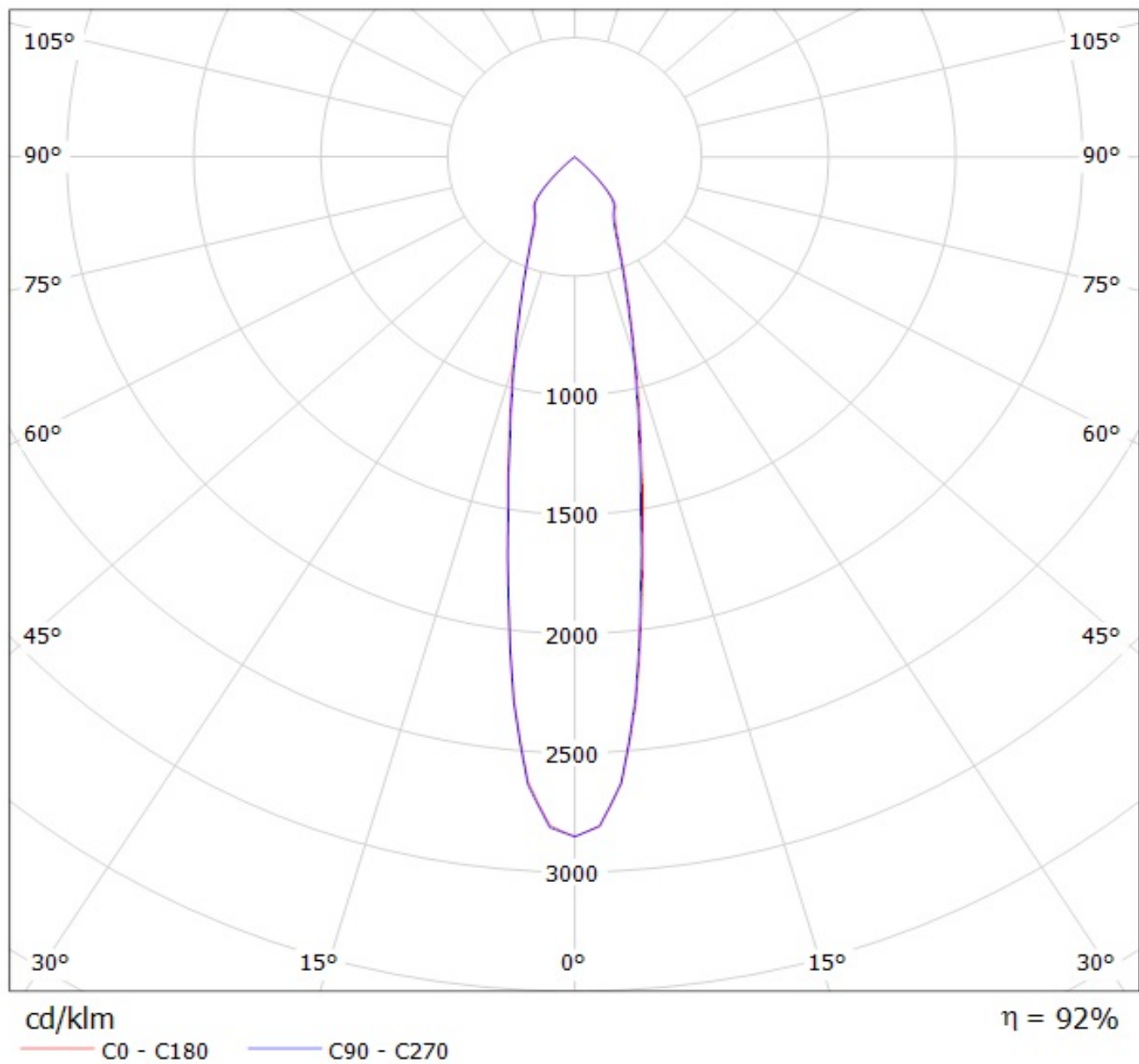

**NOTE:** The typical divergence will be changed by different color, chip size and chip position tolerance. The typical total divergence is the full angle measured where the luminous intensity is half of the peak value.

## **GENERAL INFORMATION**

- Product series especially designed & optimized for series of LEDs.
- Special care taken to make light distribution as uniform as possible.
- Fastening to heat sink with a PU foam adhesive tape of automotive grade. Please find fastening details by clicking link: [http://www.ledil.com/datasheets/DataSheet\\_TAPE.pdf](http://www.ledil.com/datasheets/DataSheet_TAPE.pdf)

**NOTE 1:** We advise customer to ensure the suitability and sufficiency of the bond in the end product. For example, mechanical stress, vibration and holes on the surface of the circuit board weaken the strength of the tape.

**NOTE 2:** Assembly to the surface must be made straight, so the tape bonds constant and balanced with fastening surface. Slanted assembly might cause unbalanced bond to the surface. All surfaces where tape is applied must be clean, dry and free from grease and dirt.

If cleaning of PCB surfaces is needed, please follow strictly the cleaning instructions of your LED manufacturer - this is important as cleaning shall under no circumstances damage LEDs or other electronics components on the PCB.

Further note that optical components shall not be cleaned with any chemicals - only micro fiber cloth may be used to remove fingerprints or other traces from handling.