



Micro Commercial Components



Micro Commercial Components
130 W Cochran St, Unit B
Simi Valley, CA 93065
Tel:818-701-4933

BCX56 BCX56-10 BCX56-16

NPN Plastic-Encapsulate Transistors

Features

- Halogen free available upon request by adding suffix "-HF"
- Lead Free Finish/RoHS Compliant ("P" Suffix designates RoHS Compliant. See ordering information)
- Power Dissipation: $P_{CM}=0.5W$ ($T_{amb}=25^{\circ}C$)
- Collector Current: $I_{CM}=1.0A$
- Collector-Base Voltage: $V_{(BR)CBO}=100V$
- Marking : BCX56=BH, BCX56-10=BK, BCX56-16=BL
- Epoxy meets UL 94 V-0 flammability rating
- Moisture Sensitivity Level 1

Maximum Ratings

Symbol	Rating	Value	Unit
$V_{(BR)CBO}$	Collector-Base Breakdown Voltage	100	V
$V_{(BR)CEO}$	Collector-Emitter Breakdown Voltage	80	V
$V_{(BR)EBO}$	Emitter-Base Breakdown Voltage	5	V
I_C	Collector Current DC	1.0	A
P_C	Collector Power Dissipation	0.5(Note1)	W
		0.95(Note2)	
		1.35(Note3)	
T_J	Junction Temperature Range	-55 to +150	$^{\circ}C$
T_{STG}	Storage Temperature Range	-55 to +150	$^{\circ}C$

- [1] Device mounted on an FR4 Printed-Circuit Board (PCB), single-sided copper, tin-plated and standard footprint.
 [2] Device mounted on an FR4 PCB, single-sided copper, tin-plated, mounting pad for collector 1 cm².
 [3] Device mounted on an FR4 PCB, single-sided copper, tin-plated, mounting pad for collector 6 cm².

Electrical Characteristics @ 25°C Unless Otherwise Specified

Symbol	Parameter	Min	Typ	Max	Units
--------	-----------	-----	-----	-----	-------

OFF CHARACTERISTICS

V_{CBO}	Collector-Base Voltage ($I_C=100\mu A$, $I_E=0$)	100	---	---	Vdc	
V_{CEO}	Collector-Emitter Voltage ($I_C=10mA$, $I_B=0$)	80	---	---	Vdc	
V_{EBO}	Emitter-Base Voltage ($I_E=10\mu A$, $I_C=0$)	5.0	---	---	Vdc	
I_{CBO}	Collector Cutoff Current ($V_{CB}=30V$, $I_E=0$)	---	---	0.1	μA	
I_{EBO}	Emitter Cutoff Current ($V_{EB}=5.0V$, $I_C=0$)	---	---	0.1	μA	
$h_{FE(1)}$	DC Current Gain ($V_{CE}=2.0V$, $I_C=150mA$)	BCX56	63	---	250	---
		BCX56-10	63	---	160	---
		BCX56-16	100	---	250	---
$h_{FE(2)}$	DC Current Gain ($V_{CE}=2.0V$, $I_C=5.0mA$)	40	---	---	---	
$h_{FE(3)}$	DC Current Gain ($V_{CE}=2.0V$, $I_C=500mA$)	25	---	---	---	
$V_{CE(sat)}$	Collector-Emitter Saturation Voltage ($I_C=500mA$, $I_B=50mA$)	---	---	0.5	Vdc	
V_{BE}	Base-Emitter Voltage ($I_C=500mA$, $V_{CE}=2.0V$)	---	---	1.0	Vdc	
f_T	Transition Frequency ($V_{CE}=100V$, $I_C=50mA$, $f=100MHz$)	130	---	---	MHz	

SOT-89

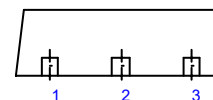
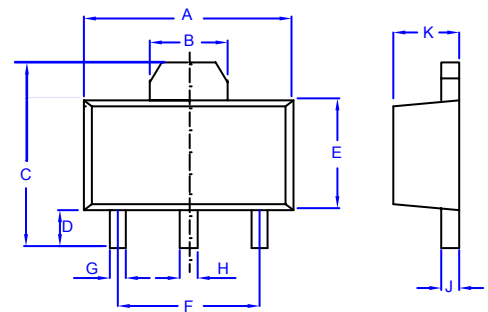

1. BASE
2. COLLECTOR
3. EMITTER

DIM	DIMENSIONS				NOTES
	INCHES		MM		
	MIN	MAX	MIN	MAX	
A	.173	.181	4.39	4.60	
B	.061	-----	1.55	-----	REF.
C	.154	.165	3.91	4.25	
D	.031	.039	0.80	1.00	
E	.092	.100	2.34	2.54	
F	.118	-----	3.00	-----	TYP
G	.013	.019	0.33	0.48	
H	.015	.021	0.38	0.53	
J	.015	.016	0.38	0.41	
K	.055	.063	1.40	1.60	

Typical Characteristics

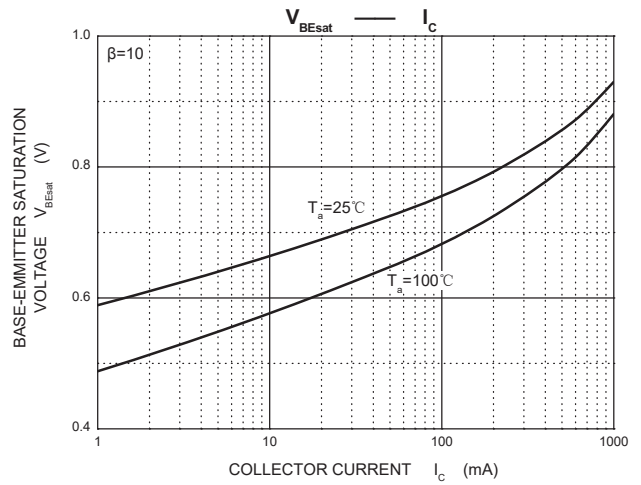
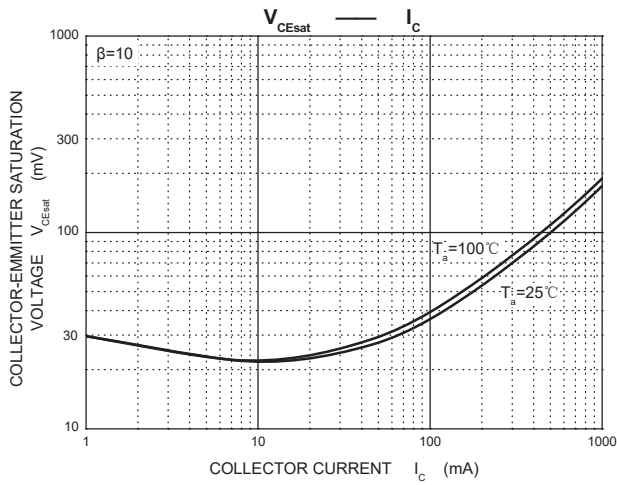
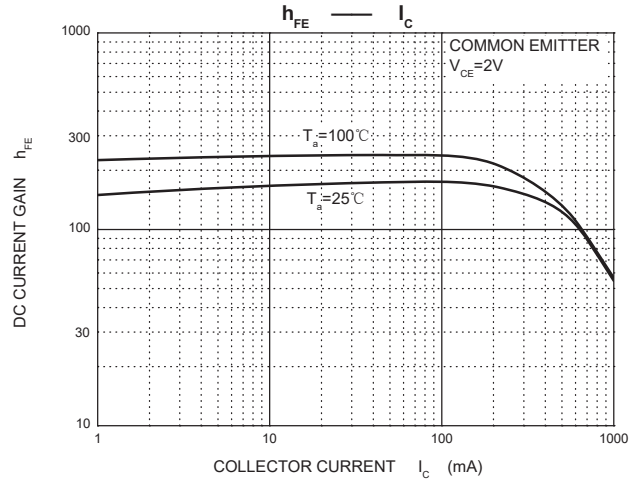
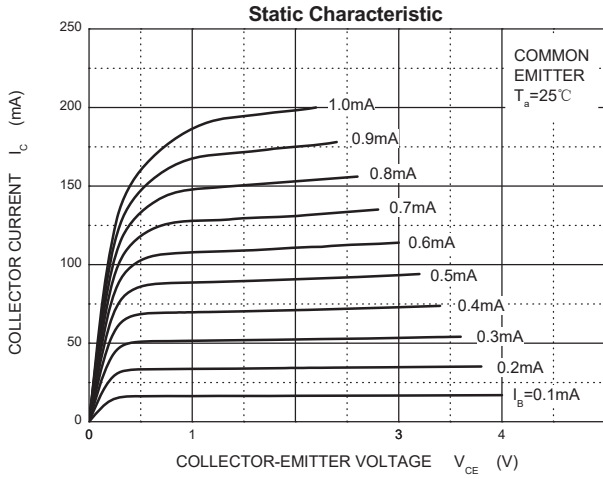

Typical Characteristics

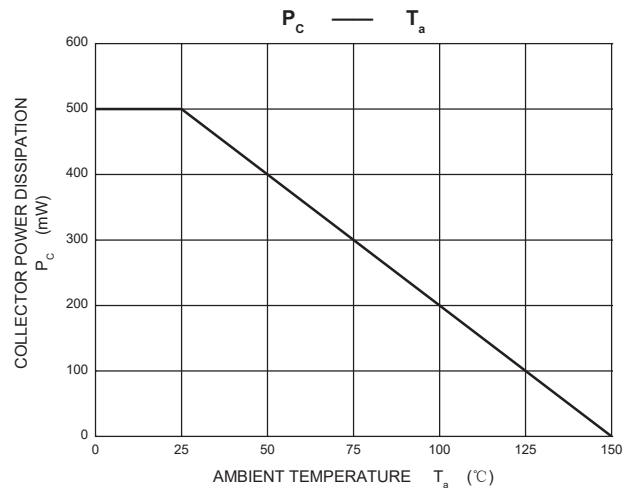
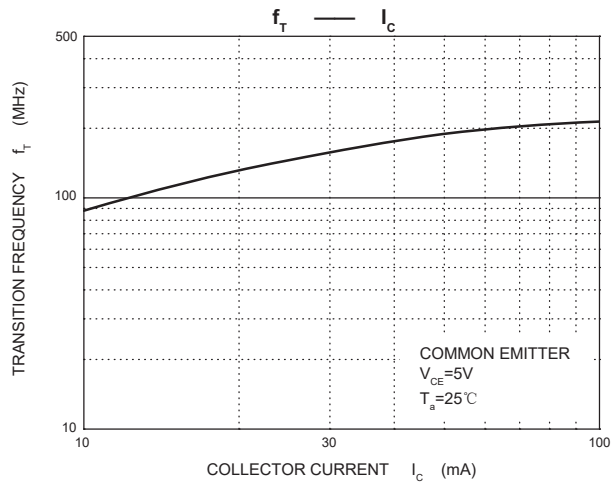
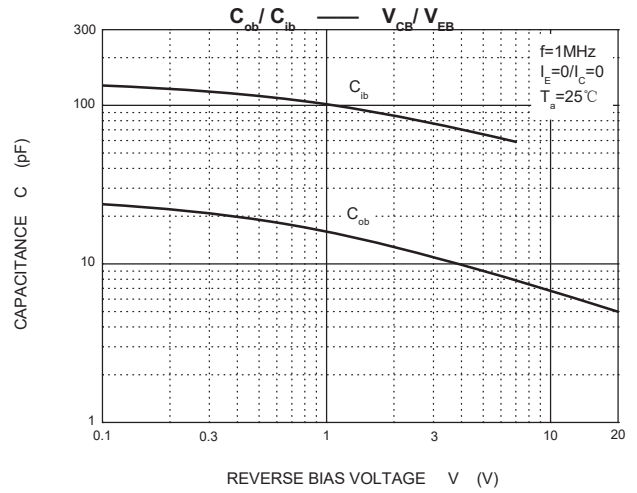
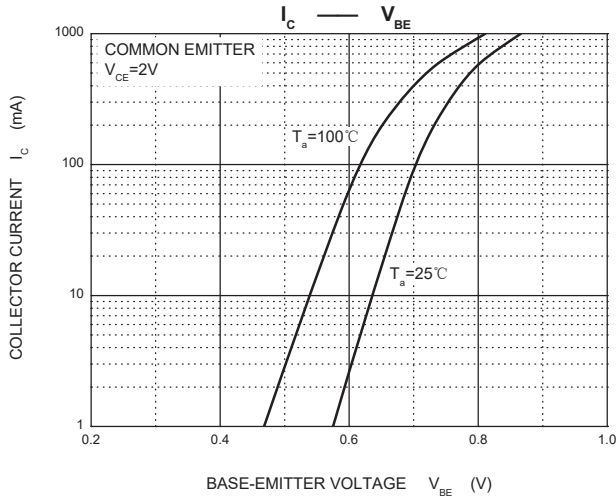



Micro Commercial Components

Ordering Information :

Device	Packing
Part Number-TP	Tape&Reel: 1Kpcs/Reel

Note : Adding "-HF" suffix for halogen free, eg. Part Number-TP-HF

IMPORTANT NOTICE

Micro Commercial Components Corp. reserves the right to make changes without further notice to any product herein to make corrections, modifications, enhancements, improvements, or other changes. **Micro Commercial Components Corp.** does not assume any liability arising out of the application or use of any product described herein; neither does it convey any license under its patent rights, nor the rights of others. The user of products in such applications shall assume all risks of such use and will agree to hold **Micro Commercial Components Corp.** and all the companies whose products are represented on our website, harmless against all damages.

LIFE SUPPORT

MCC's products are not authorized for use as critical components in life support devices or systems without the express written approval of Micro Commercial Components Corporation.

CUSTOMER AWARENESS

Counterfeiting of semiconductor parts is a growing problem in the industry. Micro Commercial Components (MCC) is taking strong measures to protect ourselves and our customers from the proliferation of counterfeit parts. MCC strongly encourages customers to purchase MCC parts either directly from MCC or from Authorized MCC Distributors who are listed by country on our web page cited below. Products customers buy either from MCC directly or from Authorized MCC Distributors are genuine parts, have full traceability, meet MCC's quality standards for handling and storage. **MCC will not provide any warranty coverage or other assistance for parts bought from Unauthorized Sources.** MCC is committed to combat this global problem and encourage our customers to do their part in stopping this practice by buying direct or from authorized distributors.

www.mccsemi.com