

PAGE 1/2	ISSUE 1425A	SERIES MMBX	PART NUMBER R223703180
----------	-------------	-------------	------------------------

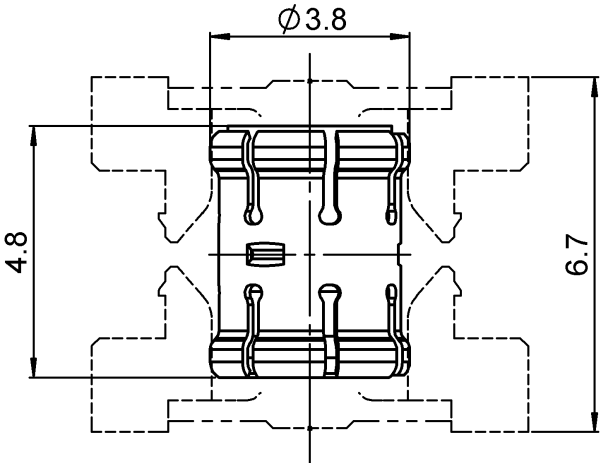

Scale 7:1

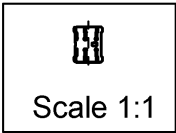

All dimensions are in mm.

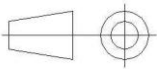
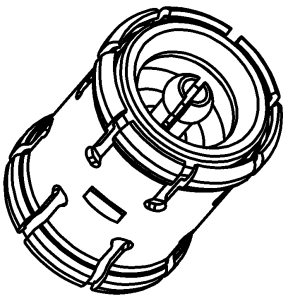

COMPONENTS	MATERIALS	PLATING (μm)
Body	<b>BERYLLIUM COPPER</b>	<b>NPGR</b>
Center contact	<b>BERYLLIUM COPPER</b>	<b>NPGR</b>
Outer contact	-	-
Insulator	<b>PTFE</b>	-
Gasket	-	-
Others parts	-	-
-	-	-
-	-	-

PAGE 2/2

ISSUE 1425A

SERIES MMBX

PART NUMBER R223703180

## PACKAGING

Standard	Unit	Other
100	Contact us	Contact us

## ELECTRICAL CHARACTERISTICS

Impedance		50	Ω
Frequency		0-12.4	GHz
VSWR	1.083* +	0.0000	x F(GHz) Maxi
Insertion loss		0.12	√F(GHz) dB Maxi
RF leakage	- (	100**	- F(GHz)) dB Maxi
Voltage rating		330	Veff Maxi
Dielectric withstanding voltage		1000	Veff mini
Insulation resistance		1000	MΩ mini

## MECHANICAL CHARACTERISTICS

Center contact retention			
Axial force – Mating End		10	N mini
Axial force – Opposite end		10	N mini
Torque		NA	N.cm mini

### Recommended torque

Mating	NA	N.cm
Panel nut	NA	N.cm

Mating life	100	Cycles mini
Weight	0.0940	g

## ENVIRONMENTAL

Operating temperature	-55/+155	°C
Hermetic seal	NA	Atm.cm3/s
Panel leakage	NA	

## SPECIFICATION

## OTHER CHARACTERISTICS

Assembly instruction: NA

Others:

\* To 6 GHz

\*\* Interface MMBX only, up to 2.5 GHz

PCB to PCB -45dB up to 2.5GHz