

REV.	DATE	DESCRIPTION
A	03/27/05	UPDATE DRAWING FORMAT
B	05/12/05	MODIFY BODY DIMENSIONS

STAMP 4 POINTS (SEE REMARKS 1,2)

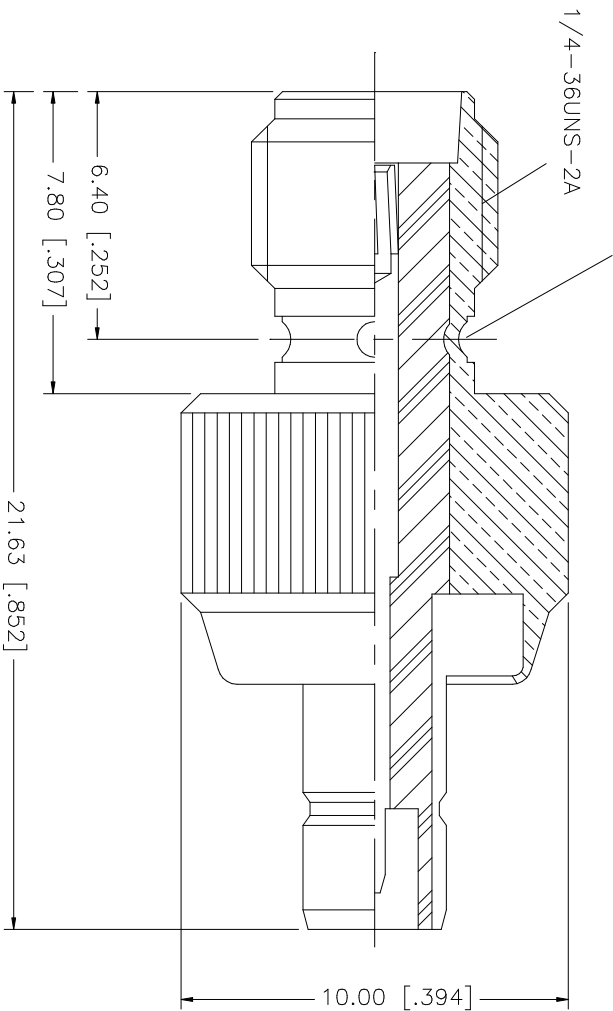

REMARKS:

1. NO.2 MUST WITHSTAND A 6LBS. MIN. PUSHOUT FORCE FROM NO.2 AFTER STAMPING OPERATION.
2. REMARK 1. IS MAINTAINED BY STAMPING THE FOUR POINTS SHOWN ON THE DRAWING WITHOUT PUNCTURING NO.1

NO.	DESCRIPTION	MATERIAL	FINISH	QTY	UNLESS OTHERWISE SPECIFIED DIMENSIONS ARE IN INCHES AND FOR CUSTOMER REFERENCE ONLY. TOLERANCES FOR MILLIMETERS ARE: 0.5 - 8mm ± 0.20mm 8 - 30mm ± 0.40mm 30 - 120mm ± 0.50mm UNLESS OTHERWISE SPECIFIED TOLERANCES FOR INCHES ARE: .020 - .315 = ± 0.007" .315 - 1.180 = ± 0.015" 1.180 - 4.724 = ± 0.020"	APPROVALS	DATE	PART DESCRIPTION							
8						DRAWN	G.R.S.	05/12/05	<p>Amphenol Connex</p> <p>SMA JACK TO SMB JACK ADAPTER</p> <p>242147</p>						
7						CHECKED									
6						ISSUED									
5						SHEET	1 OF 1								
4	CONTACT PIN	BER. COPPER	GOLD	1											
3	INSULATOR	TEFLON	NATURAL	1											
2	BODY	BRASS	GOLD	1											
1	DESCRIPTION	MATERIAL	FINISH	QTY	DO NOT SCALE DRAWING	CAD FILE	C:/242/242147.DWG	DWG. NO.	242147.DWG	REV.	B	SIZE	A	SCALE	NA