

THIS COPY IS PROVIDED ON A RESTRICTED BASIS AND IS NOT TO BE USED IN ANY WAY DETRIMENTAL TO THE INTERESTS OF PANDUIT CORP.

PANDUIT PART NO.	MAX BUNDLE DIA.	PACKAGE QTY	LENGTH "L" ±.3 [7]
MLT2.7WS-LP	2.7" [69]	50	10.2" [259]
MLT4WS-LP	4" [102]	50	14.3" [362]
MLT6WS-LP	6" [152]	50	20.5" [521]
MLT8WS-LP	8" [203]	50	26.8" [679]

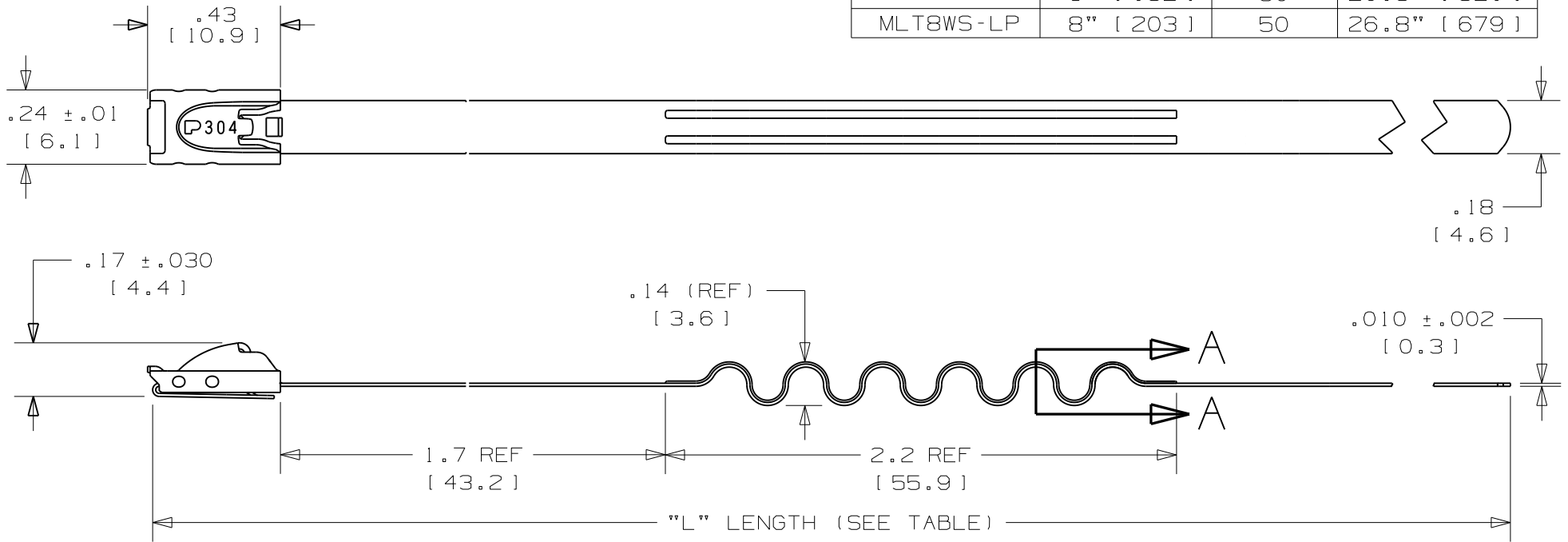

NOTES:

- APPLICATION TOOLS - GS4MT,PPTMT,ST2MT,ST3MT,HTMT
- MINIMUM LOOP TENSILE STRENGTH - 200 LBS (890 NEWTONS) WHEN TESTED ON A 3" MANDREL. PART NO. MLT2.7WS-LP TESTED ON A 1 1/2" MANDREL.
- BRACKETS [] DENOTE DIMENSIONS IN MILLIMETERS, AND ARE SHOWN FOR REFERENCE ONLY
- TOLERANCES:
 .XXX = ±.010 [.25] .XX = ±.02 [.5]
 .X = ±.03 [.8] ANGLES = ±2°
- MATERIAL: 304 STAINLESS STEEL

FULLY ROUNDED
EDGES ALONG
STRAP BODY

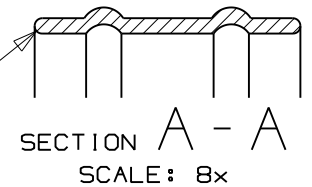

08A	2/12	MIM	RGRO	NOTE #3 METRIC DIMENSIONS NOTED AS BEING SHOWN FOR REFERENCE ONLY
REV	DATE	BY	CHK	DESCRIPTION

PANDUIT

CORP.

TINLEY PARK, ILLINOIS

WAVE-TY
STANDARD SERIES- 304 STAINLESS STEEL

DRAWN BY JAMB	CHK'D DPN	SCALE 2x	DRAWING NO. N41124BS_DC
------------------	--------------	-------------	----------------------------