

Test Jacks 4 mm System

Type

BU 20

4mm panel mount test jack, nickel plated brass, M6 thread screw/ solder terminal. max. panel thickness 13.5mm

Pin Diameter

4 mm

PART NO. / Housing color

930177000



BIL 20 / BIL 20 Au

4mm panel mount test jack, tin/ gold plated brass, M6 thread screw/ solder terminal, max. panel thickness 2mm

4 mm

Nickel Plated

- 930176100
- 930176101
- 930176102
- 930176103
- 930176104
- 930176105
- 930176106
- 930176107
- 930176109

Gold Plated

- 930176700
- 930176701
- 930176702
- 930176703
- 930176704
- 930176705
- 930176706
- 930176707
- 930176709

Technical Data

Contact Type	jack Ø 4 mm
Connection Type	M6 thread, solder terminal
Voltage Rating	30 VAC / 60 VDC
Measurement Category (IEC61010)	CAT I
Current Rating*	16 A
Contact Resistance	5 mOhm
Mounting Type	screw thread M6
Material Specifications	
Jack Body	nickel plated brass
Contact Spring	nickel
Housing	-
Environmental Conditions	
Temperature Range	-25°C to +70 °C (-13 to 158°F)
Flamability Rating	
Housing	-

Contact Type	jack Ø 4 mm
Connection Type	M6 thread, solder terminal
Voltage Rating	30 VAC / 60 VDC
Measurement Category (IEC61010)	CAT I
Current Rating*	32 A
Contact Resistance	5 mOhm
Mounting Type	screw thread M6
Material Specifications	
Jack Body	tin / gold plated brass
Contact Spring	-
Housing	Polyamide
Environmental Conditions	
Temperature Range	-25°C to +70 °C (-13 to 158°F)
Flamability Rating	
Housing	UL 94 V-2

Drawing

Measurements are shown in millimeters. Multiply by 0.03937 to convert to inches.

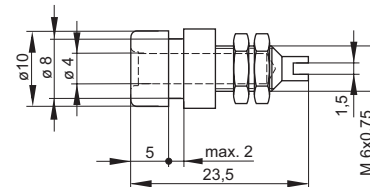
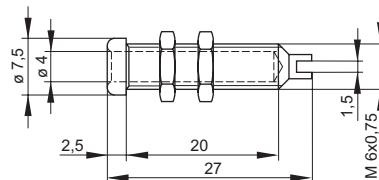

* Please consider derating graph on page 80.