

REVISIONS			
REV	DESCRIPTION, ECN, EAR NO.	DATE	APP'D
A	PRODUCT DRAWING (EAR 14478)	AUG10/16	K.L.

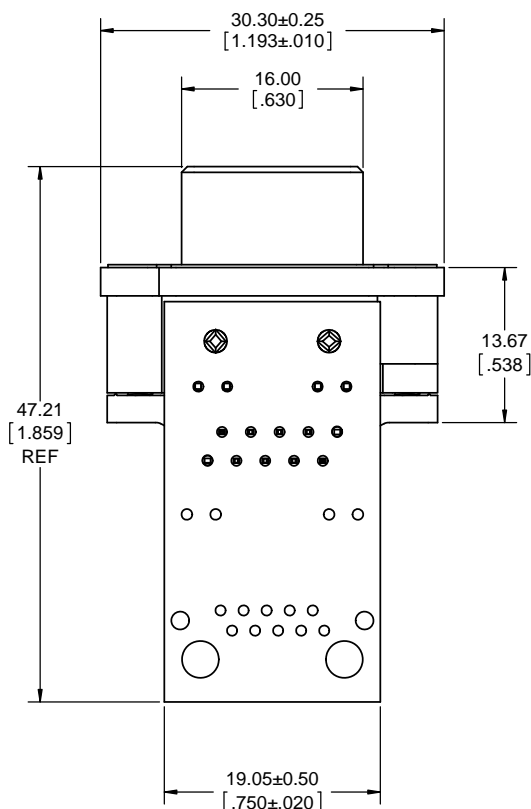
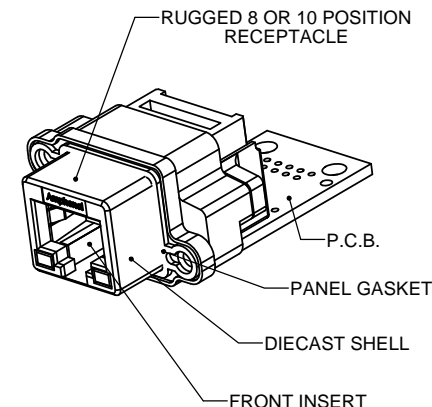

ORDERING CODE: MRJR-6CXX-X1

SERIES, RUGGED RJ
 FILTERED RECEPTACLE, RIGHT ANGLE ON PCB WITH HOLES FOR WIRING
 NUMBER OF CONTACTS:
 8 = 8
 A = 10
 LED OPTION:
 0 = NONE
 1 = LEFT GREEN, RIGHT YELLOW
 4 = LEFT YELLOW, RIGHT GREEN
 5 = LEFT GREEN, RIGHT GREEN
 MOUNTING HOLE THREAD OPTION:
 0 = #4-40 UNC THREAD
 M = M3 X 0.5 THREAD
 SINGLE PORT

SPECIAL CONNECTORS
 MANY UNIQUE FEATURES ARE READILY AVAILABLE TO SUIT CUSTOMER REQUIREMENTS. CONSULT WITH AMPHENOL CANADA FOR DETAILS.

NOTES:

- MATERIAL:
ALL MATERIALS ARE RoHS COMPLIANT PER EU DIRECTIVE 2011/65/EU AND AMENDMENTS
 - SHELL - DIECAST ZINC, NICKEL PLATED
 - CONTACTS - PHOSPHOR BRONZE WITH 1.27µm [50µ"] GOLD OVER 1.27µm [50µ"] MINIMUM NICKEL ON THE MATING AREA AND MATTE TIN OVER NICKEL ON THE CONTACT TAILS.
 - INSERTS - ENGINEERING THERMOPLASTIC, UL94V-0 FLAMMABILITY RATING, REAR INSERTS: BLACK NYLON, FRONT INSERT: CLEAR POLYCARBONATE
 - PANEL GASKET - CONDUCTIVE SILICONE RUBBER, BLACK
 - LED'S - EPOXY LENS, STEEL TAILS WITH TIN PLATING
 - FERRITE: NICKEL ZINC IRON OXIDE
 - PCB - FR-4 FIBERGLASS, LEAD FREE
- ENVIRONMENTAL PERFORMANCE PER IEC 60529 CODE IP67 FOR SEAL BETWEEN MATING AREA AND PCB SIDE OF CONNECTOR. GASKET PROVIDES SEAL TO INSIDE FACE OF PANEL.
- CURRENT RATING: 1.5 AMPERES
- CONTACT RESISTANCE: 80 MILLIOHMS MAXIMUM (SUBJECT TO VERIFICATION)
- OPERATING TEMPERATURE: -40C TO +105C
- LED CHARACTERISTICS: FORWARD DC CURRENT 25 mA MAX, FORWARD VOLTAGE 2.5 V MAX @ 2 mA
- MINIMUM IMPEDANCE (FERRITE): 38 OHMS @ 25 MHz
- AVAILABLE MATING AREA COVERS PROVIDE ADDED PROTECTION. CONSULT WITH AMPHENOL CANADA FOR DETAILS.
- RECOMMENDED TORQUE FOR PANEL MOUNT SCREWS: 0.45 TO 0.65 Nm [4.0 TO 5.75 IN-LBS] FOR STEEL SCREWS WITH 3.00 [.118] THREAD ENGAGEMENT.
- CUSTOMER TO VERIFY THAT ALL PROCESS CLEANERS ARE COMPATIBLE WITH POLYCARBONATE MATERIAL.



UNLESS SPECIFIED OTHERWISE	DRAWN	J.BADALOO	AUG10/16
PRIMARY UNITS MILLIMETERS	CHECKED		
SECONDARY INCHES	M.E. APP'D		
REFERENCE IN PARENTHESES	Q.A. APP'D		
GENERAL TOLERANCES	DWG APPR.	K.LAMBIE	AUG10/16
1 DECIMAL PLACE	ENG. REL. NO.	EAR 14478	
2 DECIMAL PLACES ±0.15	REF.		
3 DECIMAL PLACES	THIRD ANGLE PROJECTION		
ANGULAR DEGREES	DO NOT SCALE DRAWING		

Amphenol Canada Corp. www.amphenolcanada.com			
MRJR SERIES RUGGED MODULAR JACK, 8 & 10 POSITION, EMI FILTERED, RIGHT ANGLE, ON PCB WITH HOLES FOR WIRING, LED & THREAD OPTIONS, RoHS COMPLIANT			
P-MRJR-6CXX-X1			REV A
CODE ID NO. 03554	DWG SIZE: X	SCALE: 3:1	SHEET 1 OF 2

PCB HOLE #1
PCB HOLE #11
PCB HOLE #14
PCB HOLE #13
PCB HOLE #10
PCB HOLE #12
PCB HOLE #15
PCB HOLE #16

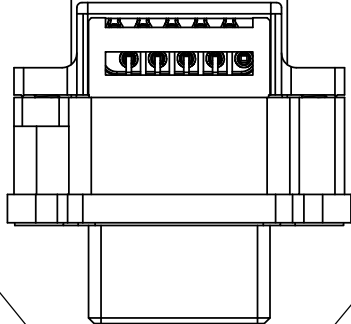

CONTACT 1 FOR 8 POSITION
CONTACT 1 FOR 10 POSITION
CONTACT 8 FOR 8 POSITION
CONTACT 10 FOR 10 POSITION

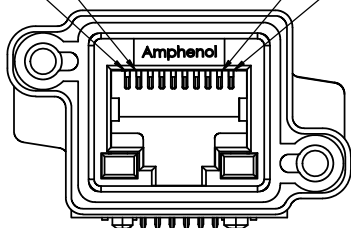

LED POSITION #1
LED POSITION #4
MRJR SHELL/GROUND POSITIONS
 $\phi 0.95$ [.037]
14 PLCS FOR UP TO 22 AWG WIRE
 $\phi 1.57$ [.062]
2 PLCS FOR UP TO 18 AWG WIRE
 $\phi 3.25$ [.128]
MAY BE SUITABLE FOR TIE WRAP USE

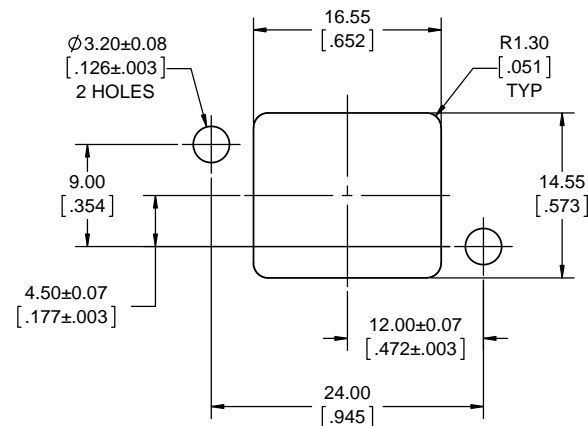
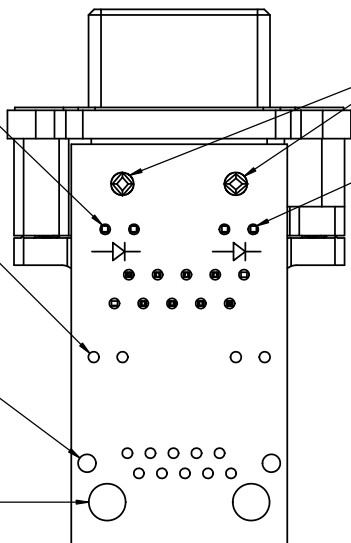

RECOMMENDED PANEL CUTOUT
OUTSIDE PANEL VIEW

MRJR TO PCB HOLE CONNECTIONS TABLE

MRJR CONNECTOR STYLE		PCB HOLE NUMBER
8 POSITION	10 POSITION	
SHELL/GROUND	SHELL/GROUND	11 & 12
-	1	1
1	2	2
2	3	3
3	4	4
4	5	5
5	6	6
6	7	7
7	8	8
8	9	9
-	10	10
LED 1	LED 1	13
LED 2	LED 2	14
LED 3	LED 3	15
LED 4	LED 4	16



UNLESS SPECIFIED OTHERWISE	DRAWN	J.BADALOO	AUG10/16
PRIMARY UNITS MILLIMETERS	CHECKED		
SECONDARY UNITS INCHES	M.E. APP'D		
REFERENCE IN PARENTHESES	Q.A. APP'D		
GENERAL TOLERANCES	DWG APPR.	K.LAMBIE	AUG10/16
1 DECIMAL PLACE	ENG. REL. NO.	EAR 14478	
2 DECIMAL PLACES ±0.15	REF.		
3 DECIMAL PLACES	THIRD ANGLE PROJECTION		
ANGULAR DEGREES			

Amphenol Canada Corp. www.amphenolcanada.com			
MRJR SERIES RUGGED MODULAR JACK, 8 & 10 POSITION, EMI FILTERED, RIGHT ANGLE, ON PCB WITH HOLES FOR WIRING, LED & THREAD OPTIONS, RoHS COMPLIANT			
P-MRJR-6CXX-X1			REV A
CODE ID NO. 03554	DWG SIZE: X	SCALE: 3:1	SHEET 2 OF 2