

**667-118**  
**Protective Receptacle Cover**  
**for MIL-DTL-5015 Series Connectors**  
**with Anti-Decoupling Device**

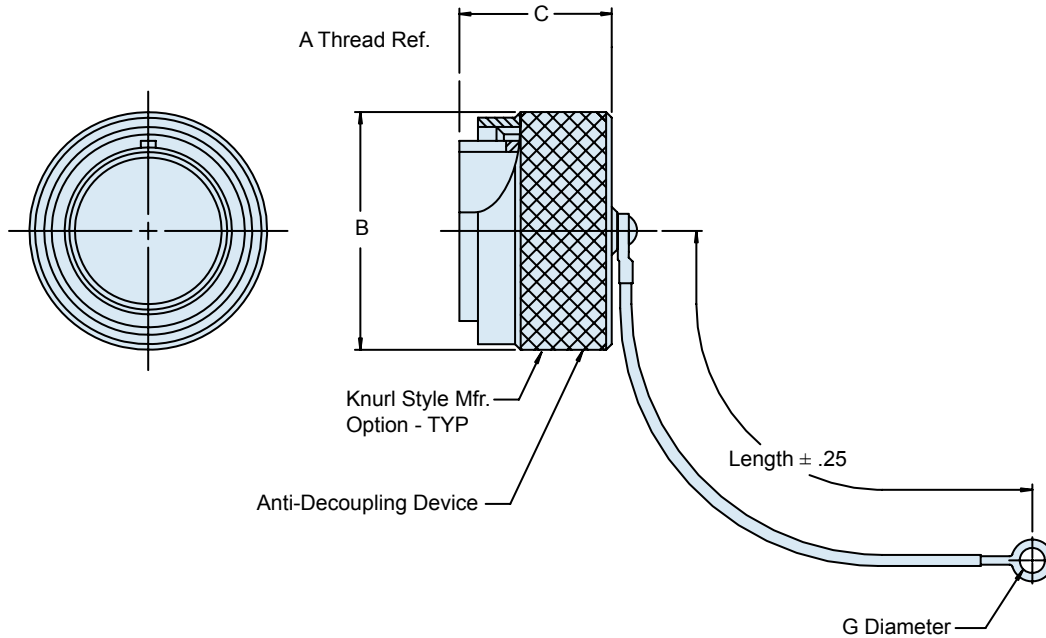

**66 & 78**

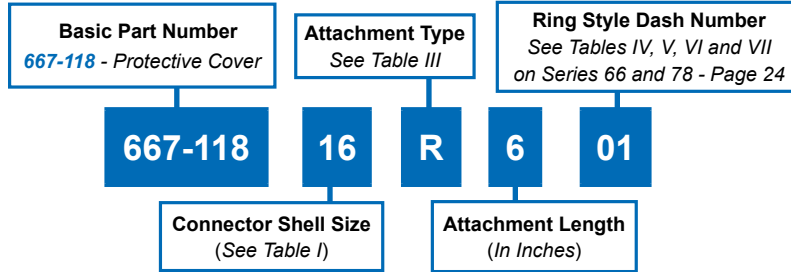

**TABLE I: CONNECTOR SHELL SIZE**

Shell Size	A Thread	B Max	C Max
08	1/2-28	.844	1.13
10	5/8-24	.969	
12	3/4-20	1.062	
14	7/8-20	1.156	
16	1-20	1.250	
18	1 1/8-18	1.344	
20	1 1/4-18	1.469	
22	1 3/8-18	1.549	
24	1 1/2-18	1.719	
28	1 3/4-18	1.969	

**TABLE III: ATTACHMENT**

Symbol	Attachment
F	Wire Rope, Nylon Jacket w/ Terminal
G	.094 Diameter Nylon Cord (black) w/ Loop Ends
H	Wire Rope, Teflon Jacket w/ Terminal
N	Attachment Omitted
R	Wire Rope, PVC Jacket w/ Terminal
T	Wire Rope, NO Jacket, w/ Terminal
K	Nylon Rope

Metric dimensions (mm) are in parentheses and are for reference only.

**B**