

PART NUMBER	SSI-LXR1612IDQ7511	REV.	D
DATE	E.C.N. NUMBER AND REVISION COMMENTS		REV.
05.04.01	E.C.N. #10735.		A
10.18.01	E.C.N. #10BRDR. & REDRAWN.		B
07.14.11	E.C.N. #10BRDR. & REDRAWN.		C
12.12.11	E.C.N. #11781.		D

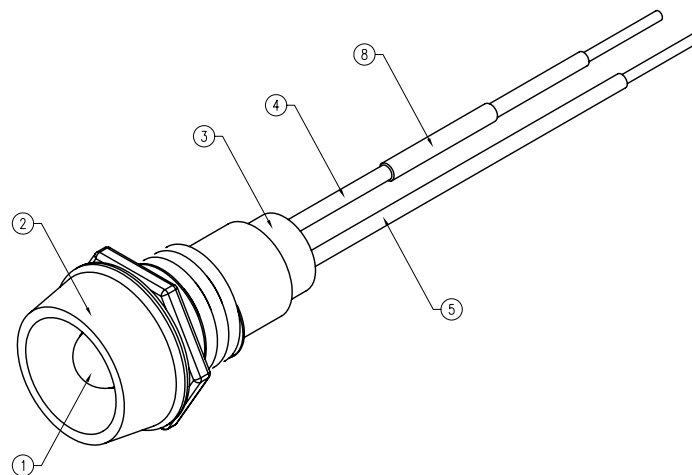
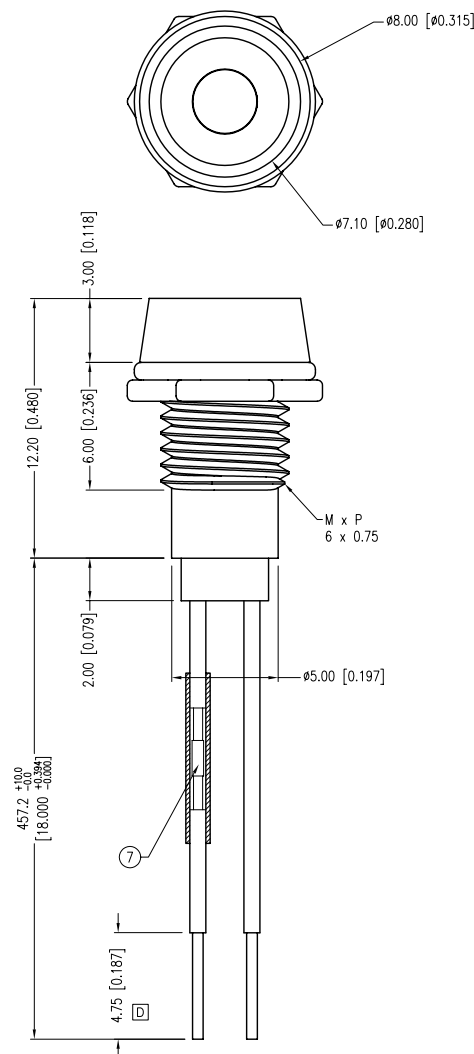

PCB PANEL CUTOUT

 $\varnothing 6.20$  [0.244]

ELECTRO-OPTICAL CHARACTERISTICS $T_a=25^\circ\text{C}$			$V_f=24\text{V}$		
PARAMETER	MIN	TYP	MAX	UNITS	UNITS
PEAK WAVELENGTH		635		nm	
FORWARD VOLTAGE		24	28	$V_f$	
REVERSE VOLTAGE	5.0			$V_r$	$I_r=100\mu\text{A}$
AXIAL INTENSITY		30		mcd	$V_f=24\text{V}$
VIEWING ANGLE		60		2x theta	
EMITTED COLOR:	RED				
EPOXY LENS FINISH:	RED DIFFUSED				

LIMITS OF SAFE OPERATION AT $25^\circ\text{C}$		
PARAMETER	MAX	UNITS
PEAK FORWARD VOLTAGE	28	V
STEADY CURRENT	22	mA
POWER DISSIPATION	310	mW
DERATE FROM $25^\circ\text{C}$	-1.6	$\text{mW}/^\circ\text{C}$
OPERATING TEMP.	-40 TO +85	$^\circ\text{C}$
STORAGE TEMP.	-40 TO +85	$^\circ\text{C}$
SOLDERING TEMP.	+260	$^\circ\text{C}$
2.0mm FROM BODY	3	SEC. MAX.

## [A] NOTES:

1. SSL-LX3054ID, RED LED. TRIM LED LEADS TO 5mm.
2. SSI-LXR1612 CHROME HOUSING.
3. SSH-LXH1612BSG, BUSHING, INSERT AND CRIMP.
4. ANODE LEAD: LXP-WST26RDT, 26 AWG, STRANDED, RED INSULATION. CUT 45mm LONG, STRIP BOTH ENDS 2mm. CUT 408.2mm LONG, STRIP 2mm AND 4.75mm.
5. CATHODE LEAD: LXP-WST26BLT, 26 AWG, STRANDED, BLACK INSULATION. CUT 465mm LONG, STRIP END 2mm AND 4.75mm.
6. SOLDER LEAD WIRES TO LED LEADS.
7. LXP-RES 1000 1/2W, 1K OHM 1/2 WATT RESISTOR. TRIM LEADS OF RESISTOR 18mm END TO END.
8. INSULATE RESISTOR AND CRIMPS WITH HEATSHRINK. (1/8" x 1" LONG).

UNCONTROLLED DOCUMENT

\*UNLESS OTHERWISE SPECIFIED TOLERANCES PER DECIMAL PRECISION ARE: X=±1 (±0.039), X.X=±0.5 (±0.020), X.XX=±0.25 (±0.010), X.XXX=±0.127 (±0.005). LEAD SIZE=±0.05 (±0.002), LEAD LENGTH=±0.75 (±0.030). MIN=  $\begin{smallmatrix} +\text{DECIMAL PRECISION} \\ -0.00 \end{smallmatrix}$  MAX.=  $\begin{smallmatrix} +\text{DECIMAL PRECISION} \\ -\text{DECIMAL PRECISION} \end{smallmatrix}$

<b>LUMEX</b> Creating LED and LCD Solutions Together™	290 E. HELEN ROAD PALATINE, IL 60067-6976 PHONE: +1.847.359.2790 FAX: +1.847.359.6538 WEB: WWW.LUMEX.COM	T-3mm (T-1) 635nm RED LED PANEL INDICATOR, RED DIFFUSED, 18" WIRE LEADS, 24V OPERATION.	DATE: 07.14.11	DRAWN BY: AB
			PAGE: 1 OF 1	CHKD BY: SS
			SCALE: NTS	APRVD BY: JD
			UNIT: mm [INCH]	Ⓟ

\*\*THE SPECIFICATIONS MAY CHANGE AT ANY TIME WITHOUT NOTICE DUE TO NEW MATERIALS OR PRODUCT IMPROVEMENT.\*\*

CONFIDENTIAL INFORMATION  
 THE INFORMATION CONTAINED IN THIS DOCUMENT IS THE PROPERTY OF LUMEX INC. EXCEPT AS SPECIFICALLY AUTHORIZED IN WRITING BY LUMEX INC., THE HOLDER OF THIS DOCUMENT SHALL KEEP ALL INFORMATION CONTAINED HEREIN CONFIDENTIAL AND SHALL PROTECT SAME IN WHOLE OR IN PART FROM DISCLOSURE AND DISSEMINATION TO ALL THIRD PARTIES.