

A non-insulated terminal binding post, manufactured from nickel plated brass, rated at 30 Amps, with a non-captive 2 BA nut. Can be used on a maximum of 12,5mm panel thickness.

Dimensions

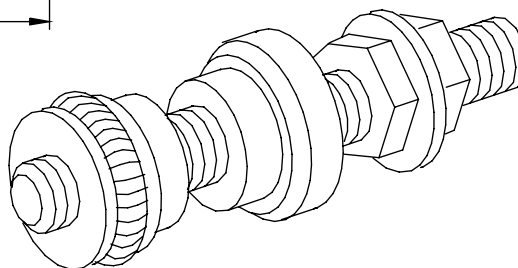
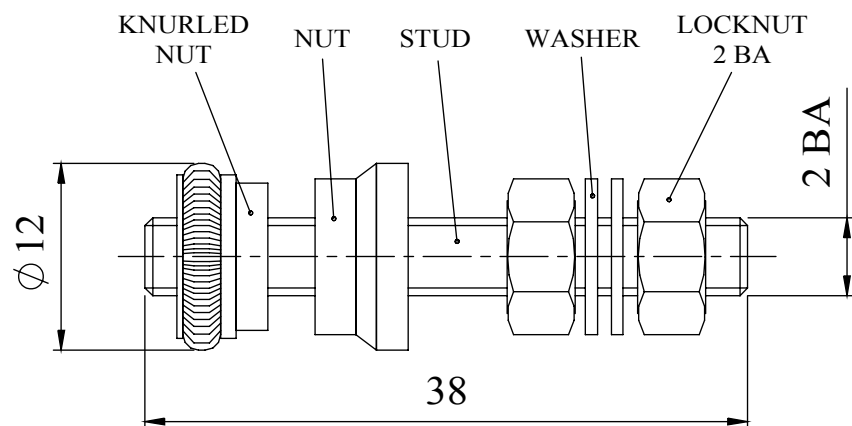

MATERIAL
LOCKNUT

: Brass, bright nickel plate

WASHER
STUD
NUT
KNURLED
NUT

: Brass, bright nickel plate
: Brass, bright nickel plate
: Brass, bright nickel plate
: Brass, bright nickel plate

Maximum
Current
Rating

: 30 Amps

Tel No. +44(0)1724 273200 Website www.dem-uk.com



PROPRIETARY AND CONFIDENTIAL
THE INFORMATION CONTAINED IN THIS DRAWING IS THE SOLE PROPERTY OF
ALPHA 3 MANUFACTURING.
ANY REPRODUCTION IN PART OR AS A WHOLE WITHOUT THE WRITTEN PERMISSION OF
ALPHA 3 MANUFACTURING IS PROHIBITED.

DEM Manufacturing, Deltron Emcon House
Hargreaves Way, Sawcliffe Ind. Park,
Scunthorpe, North Lincolnshire, DN15 8RF, UK

UNLESS OTHERWISE SPECIFIED:
DIMENSIONS ARE IN MILLIMETRES
LINEAR TOLERANCE:
NO DECIMAL PLACES $\pm 0.5\text{mm}$
1 DECIMAL PLACE $\pm 0.25\text{mm}$
2 DECIMAL PLACES $\pm 0.125\text{mm}$
ANGULAR TOLERANCE: $\pm 1^\circ$

FINISH TERMINAL BINDING POST
DEBURR AND BREAK SHARP EDGES
IF IN DOUBT ASK
DO NOT SCALE DRAWING
MATERIAL SEE NOTE

DRAWN BY
APPROVED BY
THIRD ANGLE PROJECTION

SPB
WC
SHEET 1 OF 1
SCALE 1:1
A4

TITLE GENERAL SPECIFICATION
FOR
351-0000
DRAWING NO. 351-0000
ISSUE 02
Release