

REVISIONS				
SYM	ZONE	ECN, ERN NO.	DATE	APPRD.
B		PRODUCT DRAWING	03/09/11	ATP

THIS IS A CAD DRAWING. DO NOT MANUALLY REVISE.

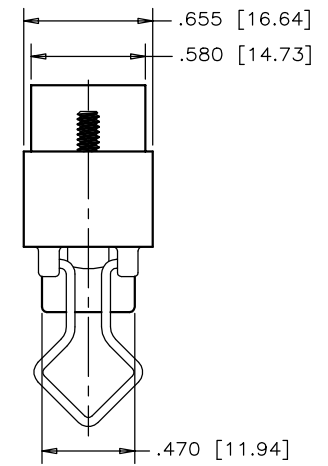
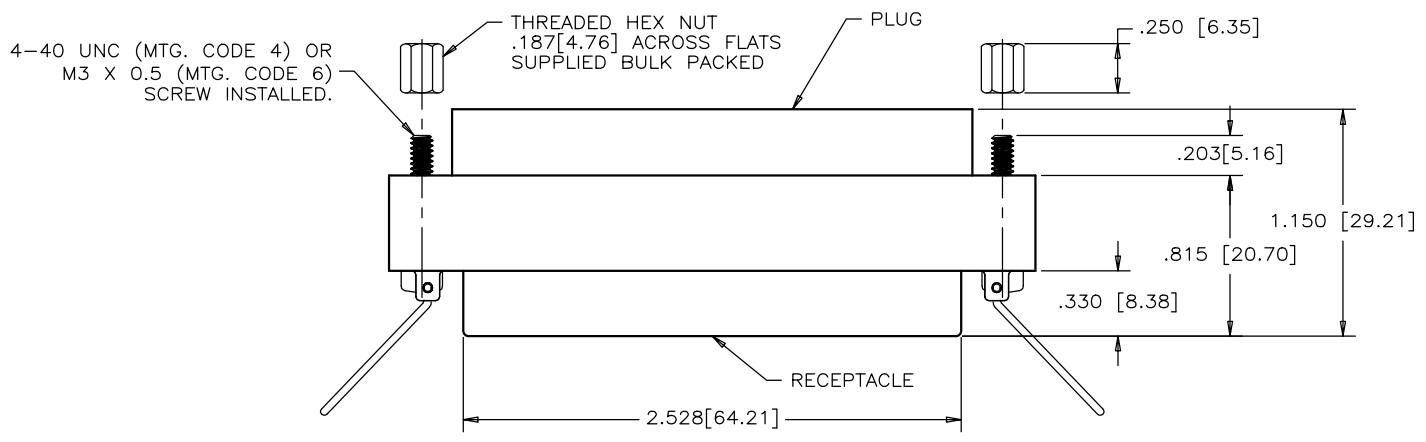
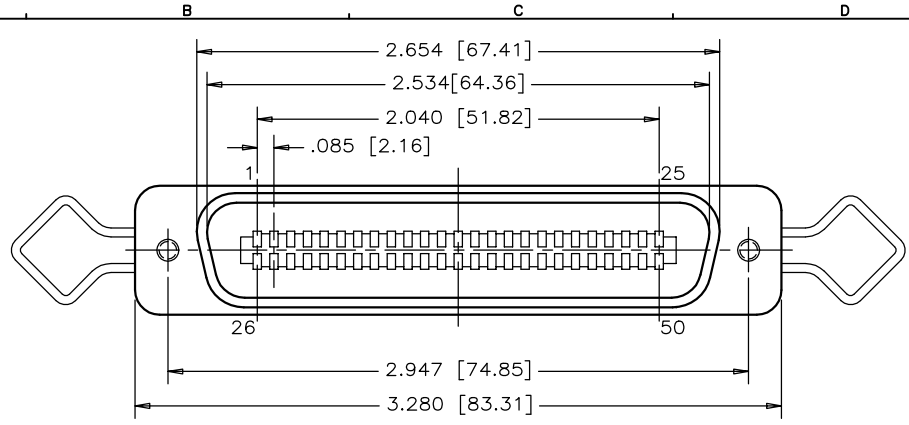

ORDERING CODE:

PART NUMBER F C C 5 7 - 0 9 5 0 0 - 4 1 0

SERIES _____ MODIFIER (0=STANDARD)

STYLE _____ CAPACITANCE

09=ADAPTER D=50 pF 5=1000 pF

NUMBER OF CONTACTS _____ B=100 pF 7=1200 pF

0=180 pF E=2200 pF

1=470 pF 9=5600 pF

3=820 pF 8=47000 pF

REFER TO AMPHENOL CATALOGUE FOR FILTER PERFORMANCE CHARACTERISTICS

MOUNTING OPTION _____

4=#4-40 UNC THREADED SCREW & HEX NUT

6=M3 - 0.5 THREADED SCREW & HEX NUT

MATERIALS:

SHELL: ALUMINUM DIECAST, TIN PLATED.

CONTACTS: PHOSPHOR BRONZE, 30 MICROINCHES [0.76 MICRONS] OF GOLD PLATED OVER NICKEL ON CONTACT MATING AREAS.

INSERT: HIGH STRENGTH THERMOPLASTIC POLYESTER FLAMMABILITY RATING UL 94V-0, BLACK.

THIS DOCUMENT CONTAINS PROPRIETARY INFORMATION AND SUCH INFORMATION MAY NOT BE DISCLOSED TO OTHERS FOR ANY PURPOSE OR USED FOR MANUFACTURING PURPOSES WITHOUT WRITTEN PERMISSION FROM AMPHENOL CANADA CORP.

MATERIAL -----	DRAWN <u>I.ESSAJEE</u>	DATE <u>00/01/05</u>	Amphenol Canada Corp.	
	DESIGNED			
FINISH -----	CHECKED <u>K.LAMBIE</u>	DATE <u>00/01/13</u>	TITLE FCC57 FILTERED MICRO-RIBBON CONNECTOR, PLUG/RECEPTACLE ADAPTER, 50 SIZE, WITH LATCH SPRINGS & MOUNTING HARDWARE	
	I. E. APPRD.			
	Q. A. APPRD.		DWG	DRAWING NO.
	DWG. APPRD.		C	P-FCC57-09500-XX0
	ENG. REL. NO.		SCALE	2/1
	REF. <u>EAR C10929</u>		WT.	-----
	DIMENSIONS ARE IN <u>INCHES [mm]</u>	CODE ID. NO. <u>03554</u>	SURF.	-----
			SHEET	1 OF 1
			REV.	B