

| REVISIONS | | | |
|-----------|------------------------------|----------|-------|
| REV | DESCRIPTION, ECN, EAR NO. | DATE | APP'D |
| A | PROPOSAL DRAWING (EAR 14440) | APR15/16 | K.L. |

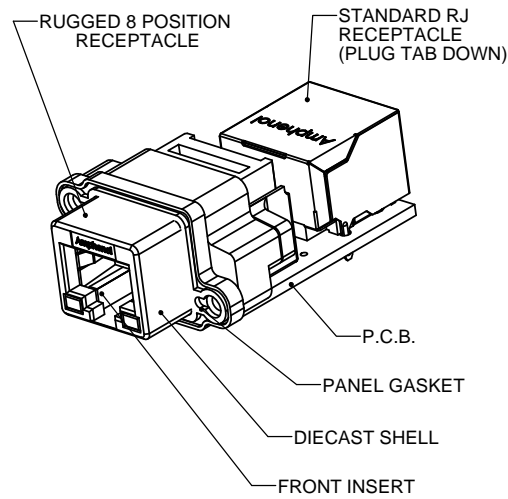
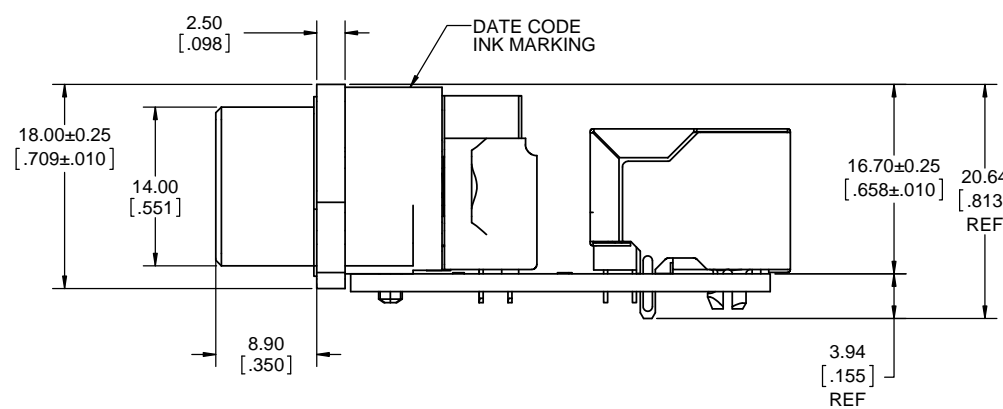
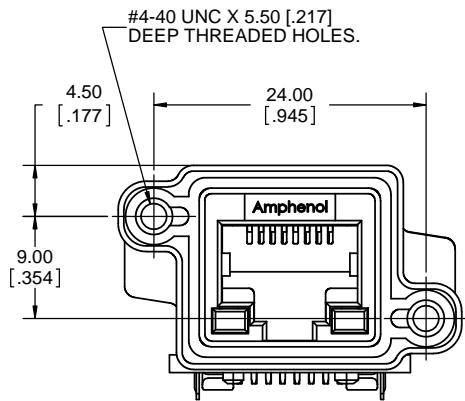

ORDERING CODE: **MRJR-5780-011**

SERIES, RUGGED RJ

RECEPTACLE, RIGHT ANGLE, ON PCB WITH STANDARD RJ, 8 CONTACTS

LED OPTION: 0 = NONE

MOUNTING HOLE THREAD OPTION: 0 = #4-40 UNC THREAD

SINGLE PORT

UNIQUE SPECIAL CODE WITH RJSBE CONNECTOR ON PCB TO ALLOW PLUG LATCH ORIENTATION IN DOWNWARD DIRECTION

NOTES:

- MATERIAL:
ALL MATERIALS ARE RoHS COMPLIANT PER EU DIRECTIVE 2011/65/EU AND AMENDMENTS
 - SHELL - DIECAST ZINC, NICKEL PLATED
 - CONTACTS - PHOSPHOR BRONZE WITH 1.27µm [50µ"] GOLD OVER 1.27µm [50µ"] MINIMUM NICKEL ON THE MATING AREA AND MATTE TIN OVER NICKEL ON THE CONTACT TAILS.
 - INSERTS - ENGINEERING THERMOPLASTIC, UL94V-0 FLAMMABILITY RATING,
 - REAR INSERTS: BLACK NYLON, FRONT INSERT: CLEAR POLYCARBONATE
 - PANEL GASKET - CONDUCTIVE SILICONE RUBBER, BLACK
 - PCB - FR-4 FIBERGLASS, LEAD FREE, UL94V-0 FLAMMABILITY RATING.
 - STANDARD RJ RECEPTACLE: AMPHENOL P/N RJSBE-5F80-C1, PHOSPHOR BRONZE CONTACTS WITH 1.27µm [50µ"], GOLD OVER NICKEL ON MATING AREA, BLACK NYLON INSERT AND COPPER ALLOY SHIELD WITH NICKEL PLATING
- ENVIRONMENTAL PERFORMANCE PER IEC 60529 CODE IP67 FOR SEAL BETWEEN MATING AREA AND PCB SIDE OF CONNECTOR. GASKET PROVIDES SEAL TO INSIDE FACE OF PANEL.
- CURRENT RATING: 1.5 AMPERES
- CONTACT RESISTANCE: 80 MILLIOHMS MAXIMUM (SUBJECT TO VERIFICATION)
- OPERATING TEMPERATURE: -55°C TO +105°C
- AVAILABLE MATING AREA COVERS PROVIDE ADDED PROTECTION. CONSULT WITH AMPHENOL CANADA FOR DETAILS.
- CUSTOMER TO VERIFY THAT ALL PROCESS CLEANERS ARE COMPATIBLE WITH POLYCARBONATE MATERIAL.

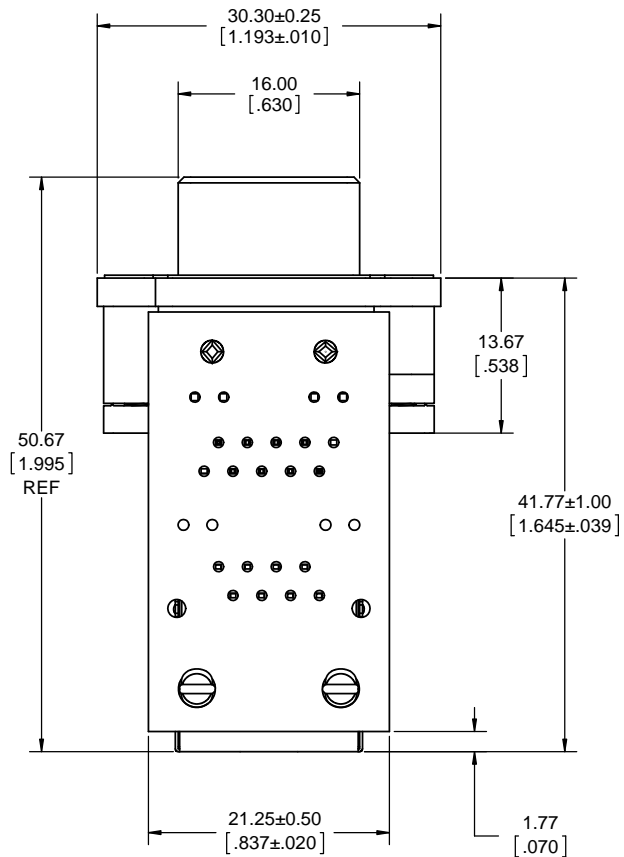

| | | | |
|----------------------------|------------------------|-----------|----------|
| UNLESS SPECIFIED OTHERWISE | DRAWN | K.PYO | APR14/16 |
| PRIMARY UNITS MILLIMETERS | CHECKED | | |
| SECONDARY UNITS INCHES | M.E. APP'D | | |
| REFERENCE IN PARENTHESES | Q.A. APP'D | | |
| GENERAL TOLERANCES | DWG APPR. | K.LAMBIE | APR15/16 |
| 1 DECIMAL PLACE | ENG. REL. NO. | EAR 14440 | |
| 2 DECIMAL PLACES ±0.15 | REF. | | |
| 3 DECIMAL PLACES | THIRD ANGLE PROJECTION | | |
| ANGULAR DEGREES | | | |

Amphenol Canada Corp.
www.amphenolcanada.com

MRJR RUGGED 8P8C MODULAR JACK, ON PCB WITH "PLUG TAB DOWN" STANDARD RJ, #4-40 THREAD, RoHS COMPLIANT

DWG. NO. **P-MRJR-5780-011** REV **A**

CODE ID NO. 03554 DWG SIZE: X SCALE: 3:1 SHEET 1 OF 2

| REVISIONS | | | |
|-----------|------------------------------|----------|-------|
| REV | DESCRIPTION, ECN, EAR NO. | DATE | APP'D |
| A | PROPOSAL DRAWING (EAR 14440) | APR15/16 | K.L. |

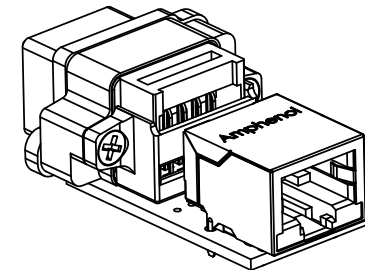
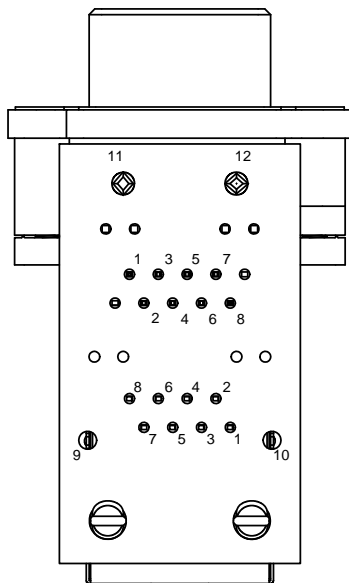
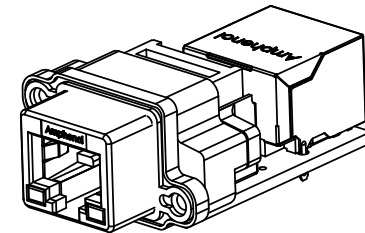
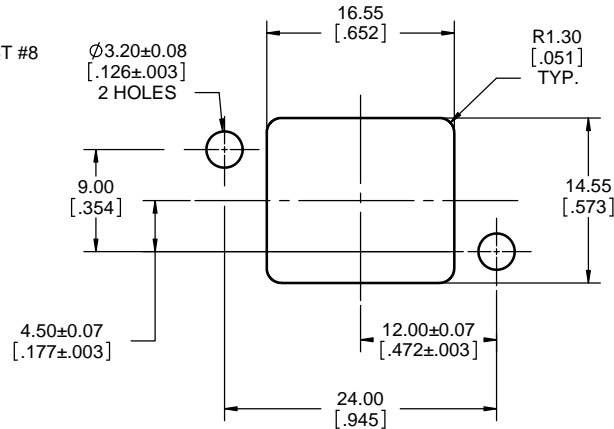
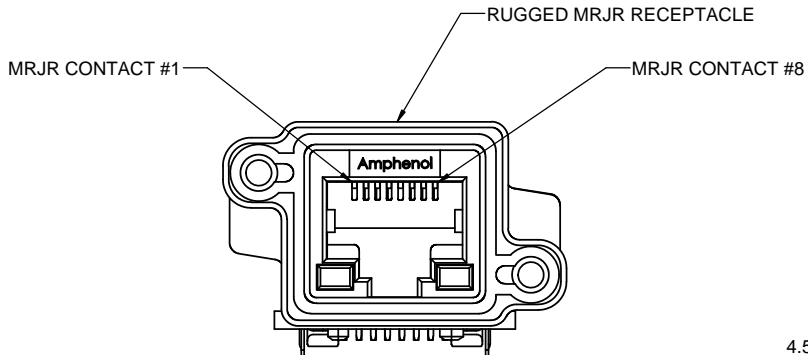

RECOMMENDED PANEL CUTOUT
OUTSIDE PANEL VIEW

| RUGGED MRJR TO STANDARD RJ CONNECTIONS | |
|--|---------------------|
| MRJR CONTACT | STANDARD RJ CONTACT |
| 1 | 1 |
| 2 | 2 |
| 3 | 3 |
| 4 | 4 |
| 5 | 5 |
| 6 | 6 |
| 7 | 7 |
| 8 | 8 |
| MRJR GROUND | RJ GROUND |
| 11 & 12 | 9 & 10 |

STANDARD RJ RECEPTACLE

STANDARD RJ CONTACT #8

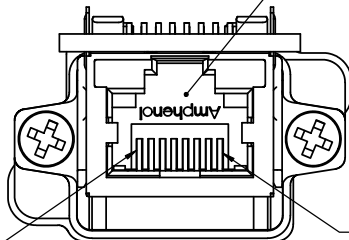

STANDARD RJ CONTACT #1



| | | | |
|----------------------------|------------------------|-----------|----------|
| UNLESS SPECIFIED OTHERWISE | DRAWN | K.PYO | APR14/16 |
| PRIMARY UNITS MILLIMETERS | CHECKED | | |
| SECONDARY INCHES | M.E. APP'D | | |
| REFERENCE IN PARENTHESES | Q.A. APP'D | | |
| GENERAL TOLERANCES | DWG APPR. | K.LAMBIE | APR15/16 |
| 1 DECIMAL PLACE | ENG. REL. NO. | EAR 14440 | |
| 2 DECIMAL PLACES ±0.15 | REF. | | |
| 3 DECIMAL PLACES | THIRD ANGLE PROJECTION | | |
| ANGULAR DEGREES | DO NOT SCALE DRAWING | | |

Amphenol Canada Corp.
www.amphenolcanada.com

**MRJR RUGGED 8P8C MODULAR JACK,
ON PCB WITH "PLUG TAB DOWN"
STANDARD RJ, #4-40 THREAD, RoHS
COMPLIANT**

DWG. NO. **P-MRJR-5780-011** REV **A**

CODE ID NO. 03554 DWG SIZE: X SCALE: 3:1 SHEET 2 OF 2