

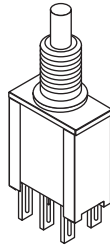

Dimensions: mm (in.)



POS. 1	POS. 2
	
ON	MOM
1-3, 4-6	1-2, 4-5
	

SWITCH FUNCTION

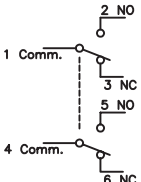
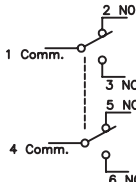
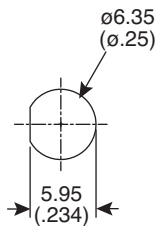
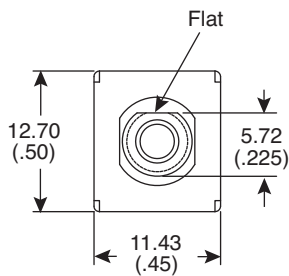

Without locking ring.

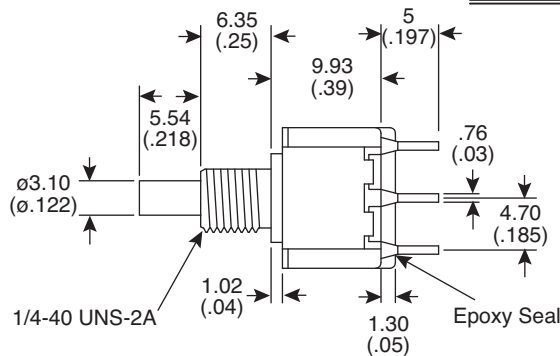

With standard locking ring.

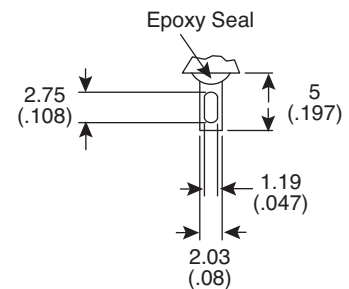
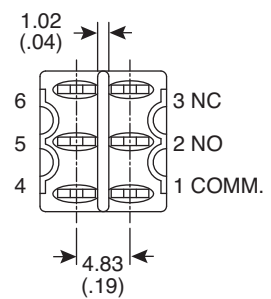

SOLDER LUG

PANEL MOUNTING

Electrical Specifications:

- Rating: 1A/250VAC, 3A/120VAC or 28VDC
- Contact Resistance: 20mΩmax. initial @ 2-4VDC 100mA
- Insulation Resistance: 1,000MΩmin.
- Dielectric Strength: 1,000 V RMS@ sea level

Mechanical Specifications:

- Mechanical Life: 50,000 make-and-break cycles.
- Operating Temperature: -30°C to 85°C

Materials:

- Case: Dially phthalate (DAP) (UL94V-0)
- Plunger: Glass filled Nylon or Glass filled polyester
- Bushing: Brass, nickel plated
- Housing: Stainless steel.
- Contact: Silver plated.

Note:

- RoHS Compliant by Exemption

Snap-Acting Pushbutton Switch
107-3009-EVX

Mountain
Switch