

## DETAILS

Product Number	FCN14933_SAGA-S-WHT
Family	Saga
Type	Lens
Color	white
Diameter	50 mm
Height	13,7 mm
Style	round
Optic Material	HRPC
Holder Material	
Fastening	screw
Status	sample approved
ROHS Compliant	Yes
Date Updated	2/06/2016



## OPTICAL PROPERTIES

LED	Viewing Angle	Light Beam	Effi- ciency	cd/lm	Connector
LC040C	sim: 44	Spot	sim: 87 %	sim: 1.400	Bender Wirth: 480 Typ L6
CXA/B 13xx	sim: 15	Spot	sim: 94 %	sim: 7.100	-
LC010C	sim: 30	Spot	sim: 91 %	sim: 3.400	Bender Wirth: 479 Typ L6
LC020C	sim: 36	Spot	sim: 88 %	sim: 2.200	Bender Wirth: 479 Typ L6
CXA/B 15xx	26 deg	Spot	94 %	2.700	-
CXA/B 1816 & CXA/B 1820 & CXA 1850 34 deg		Spot	94 %	1.650	-

D

C

B

A

NOTE: Maximum recommended tightening  
torque for SAGA-FRAME is 0,4Nm

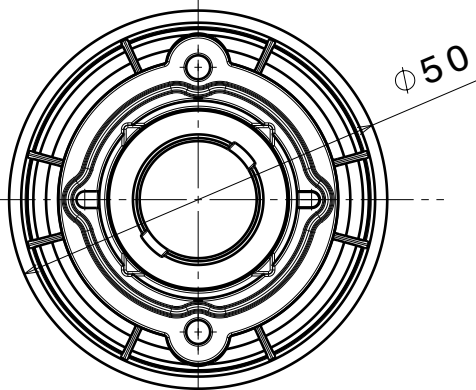
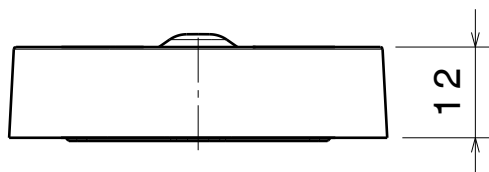
 $\varnothing 50$ 

12

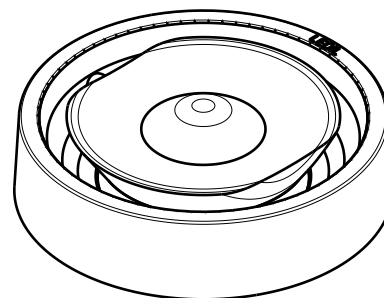

Isometric view  
Scale: 1:1

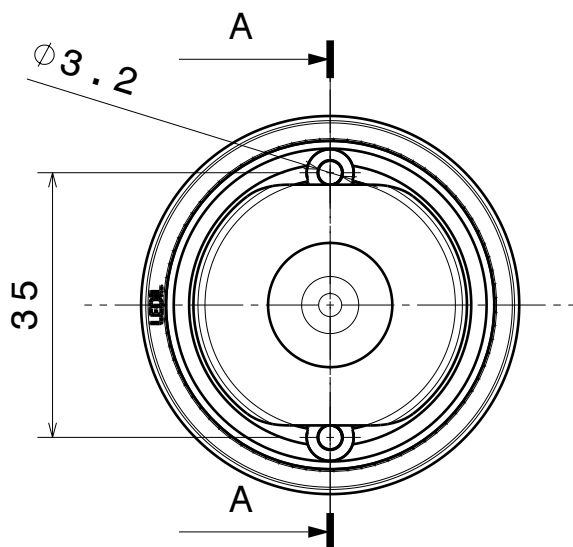

35

13.9

INDEX	PART NO	DESCRIPTION	MATERIAL	COLOUR
1	F14908	SAGA-S	Optical grade LSR	clear
2	C13591	SAGA-FRAME-WHT	HRPC	white

Tolerances if not otherwise shown  
According to DIN ISO 2768-1  
Linear measures:  
Up to 30mm class M, otherwise class C.  
According to DIN ISO 2768-2  
Form and position: class L

**LEDiL**

Ledil Oy  
Salorankatu 10  
FIN 24240 SALO  
Finland

THIRD ANGLE PROJECTION:



DRAWING TITLE

FCN14933\_SAGA-S-WHT

This drawing is the property  
of LEDiL Oy. It may not be  
reproduced, copied or  
communicated without a written  
agreement with LEDiL Oy.

SIZE

A4

PART NUMBER

SAGA-S-WHT

SCALE

1:1

WEIGHT

19,69 g

SHEET

1/1

D

A

Luminaire: Ledil Oy FCN14933\_SAGA-S-WHT\_(LC040C)\_(B+W\_480\_Typ\_L6)\_SIMULATED  
Lamps: 1 x Samsung LC040C + Bender & Wirth Bender & Wirth 480 Typ L6

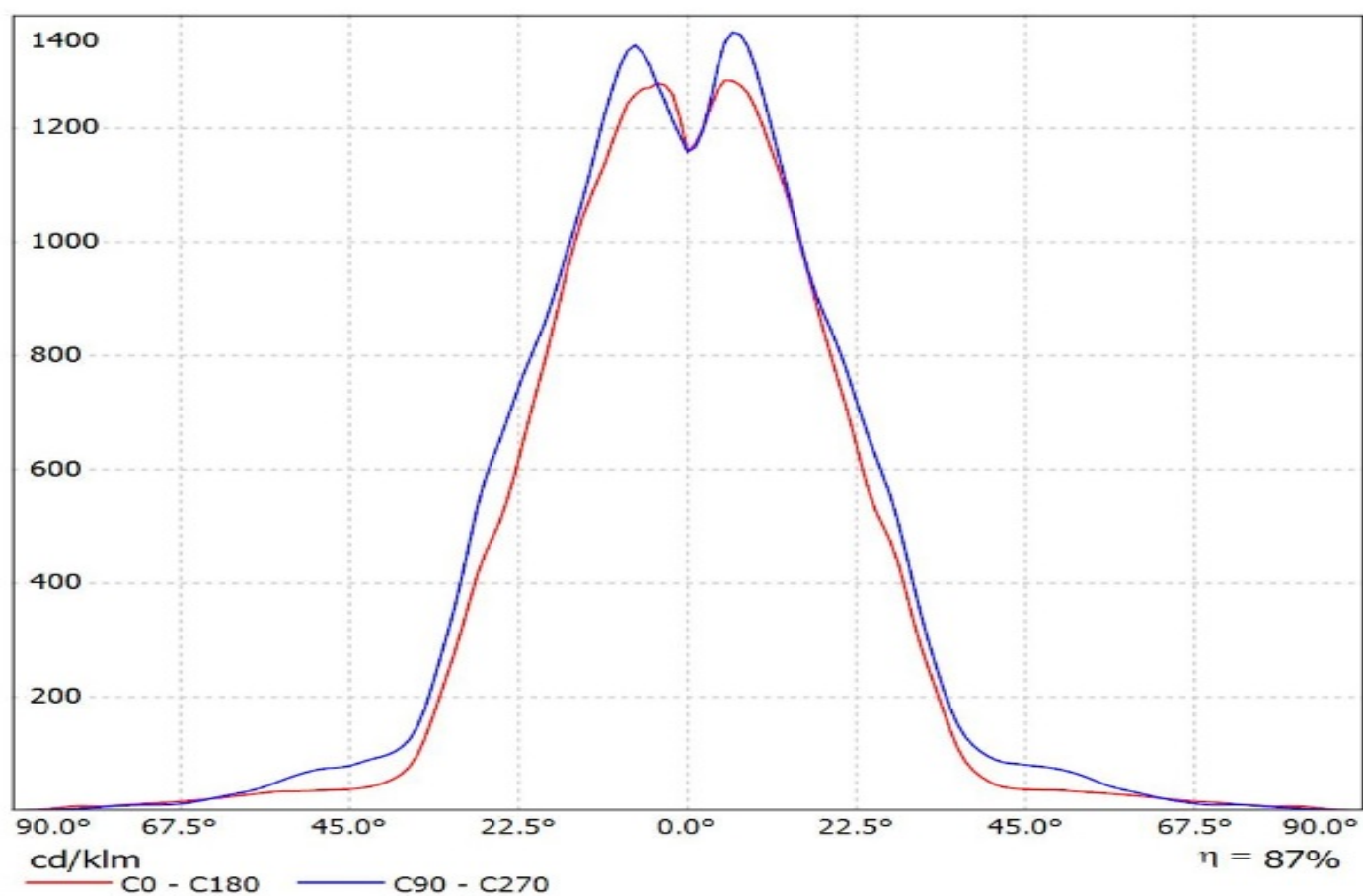

Luminaire: Ledil Oy FCN14933\_SAGA-S-WHT\_(CXB1310)\_SIMULATED  
Lamps: 1 x Cree CXB1310

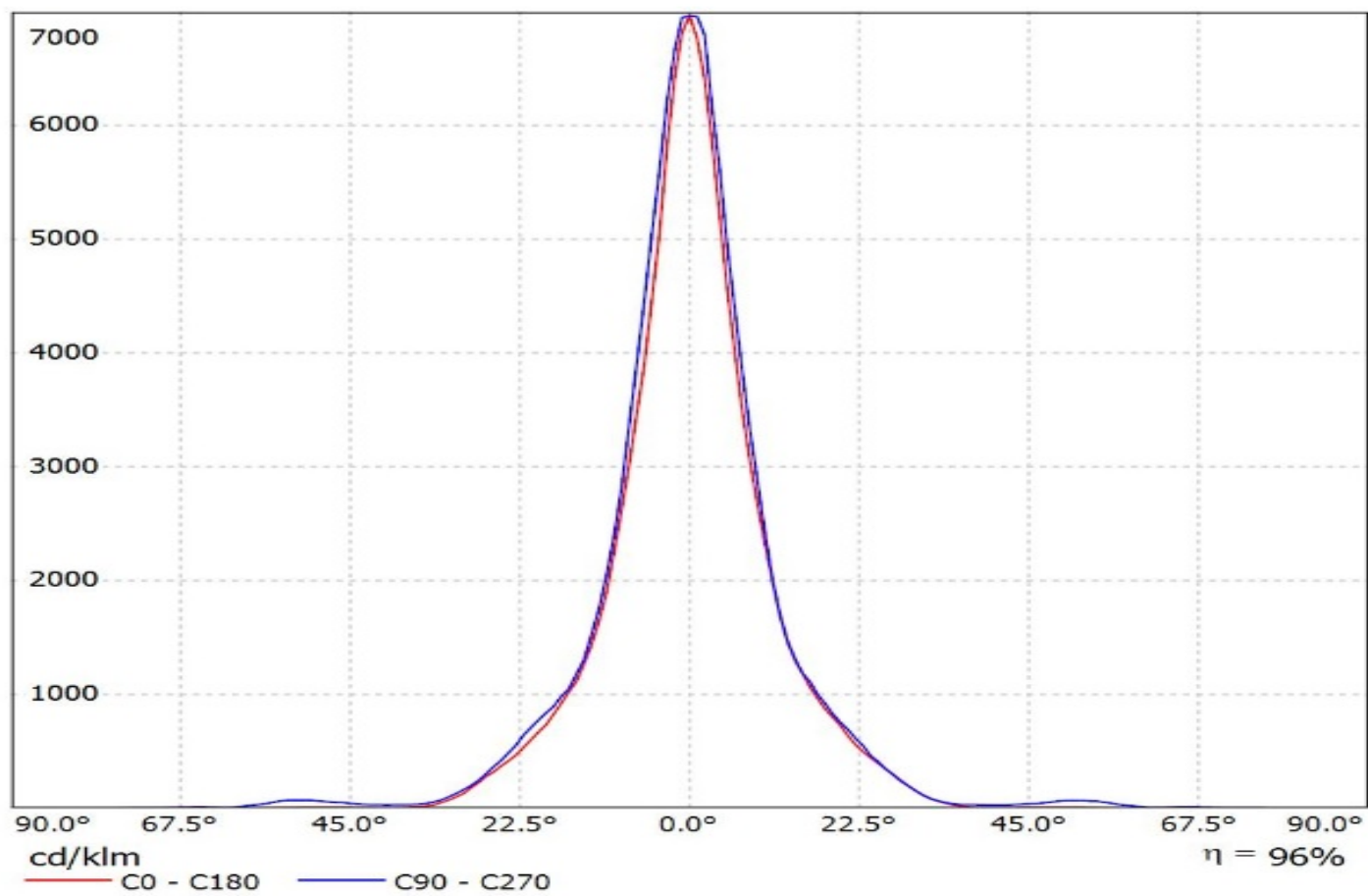

Luminaire: Ledil Oy FCN14933\_SAGA-S-WHT\_(LC010C)\_(B+W\_479\_Typ\_L6)\_SIMULATED  
Lamps: 1 x Samsung LC010C + Bender & Wirth 479 Type L6

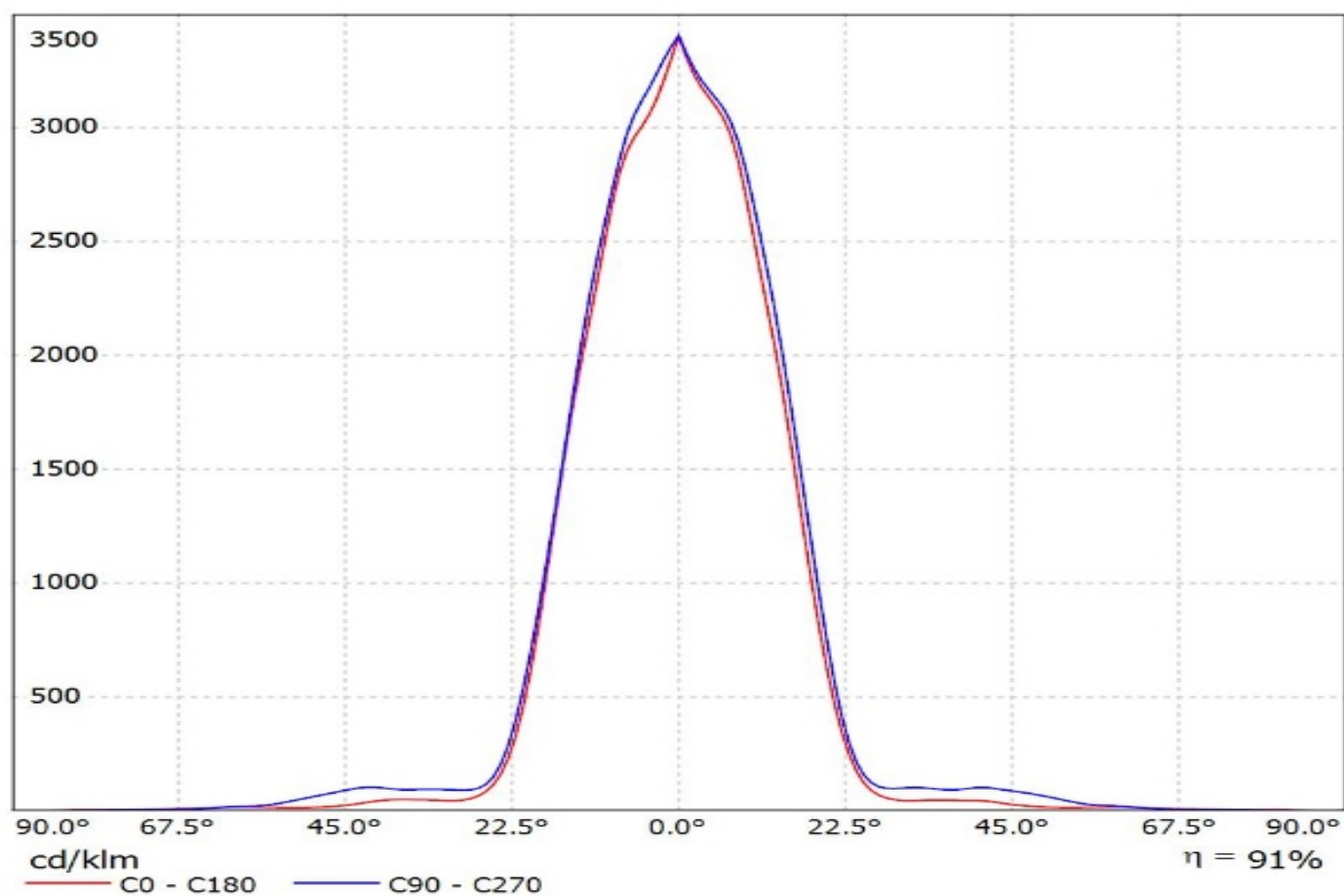

Luminaire: Ledil Oy FCN14933\_SAGA-S-WHT\_(LC020C)\_(B+W\_479\_Typ\_L6)\_SIMULATED  
Lamps: 1 x Samsung LC020C + Bender & Wirth Bender & Wirth 479 TYP L6

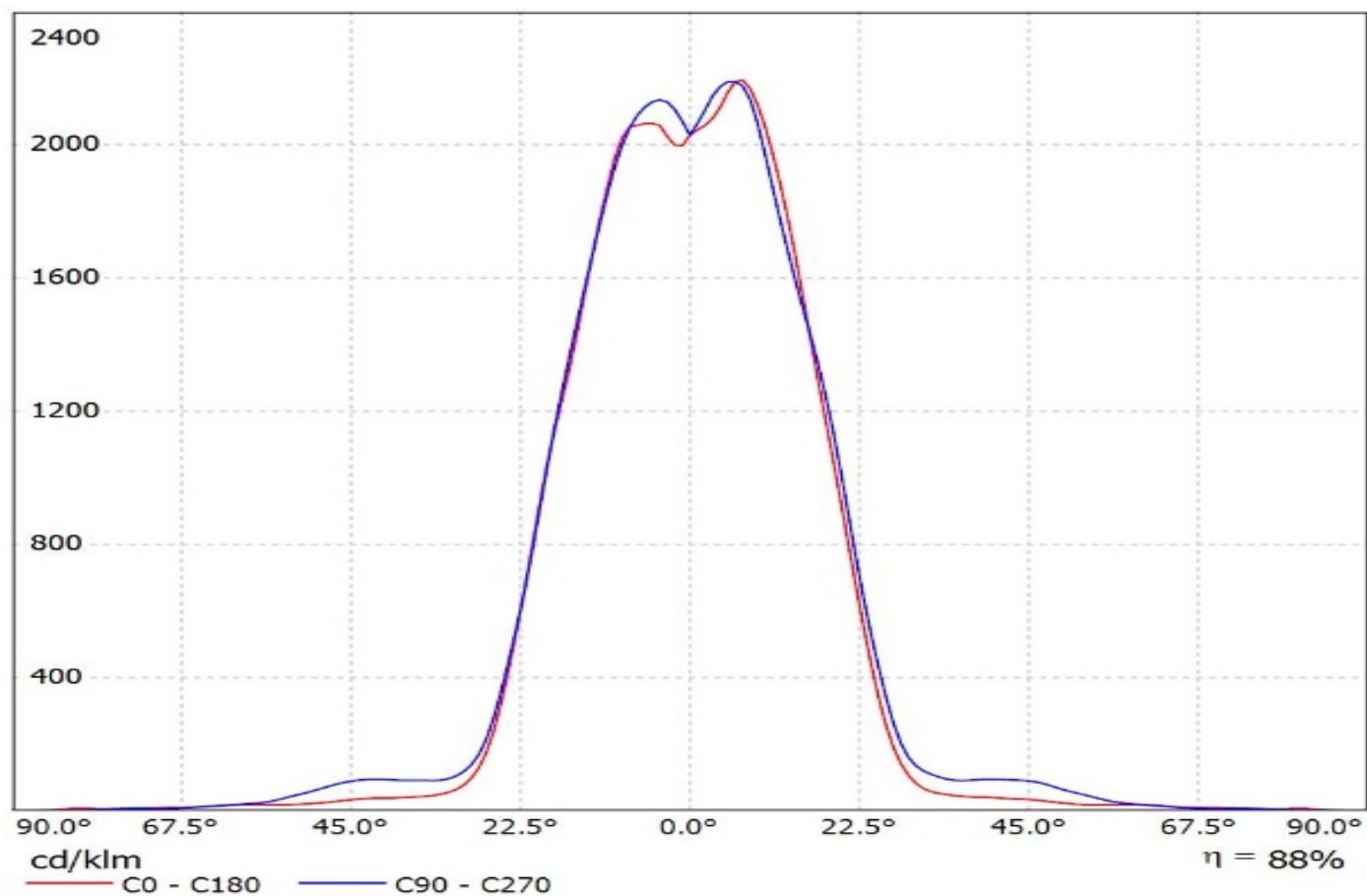

Luminaire: LEDiL Oy F14908\_SAGA-S\_(CXA1520)\_C1  
Lamps: 1 x Cree\_CXA1520\_(CXA1520-30F-N4-N0H-0001)\_915.861lm@250mA\_P=8.27837W\_I=0.250A

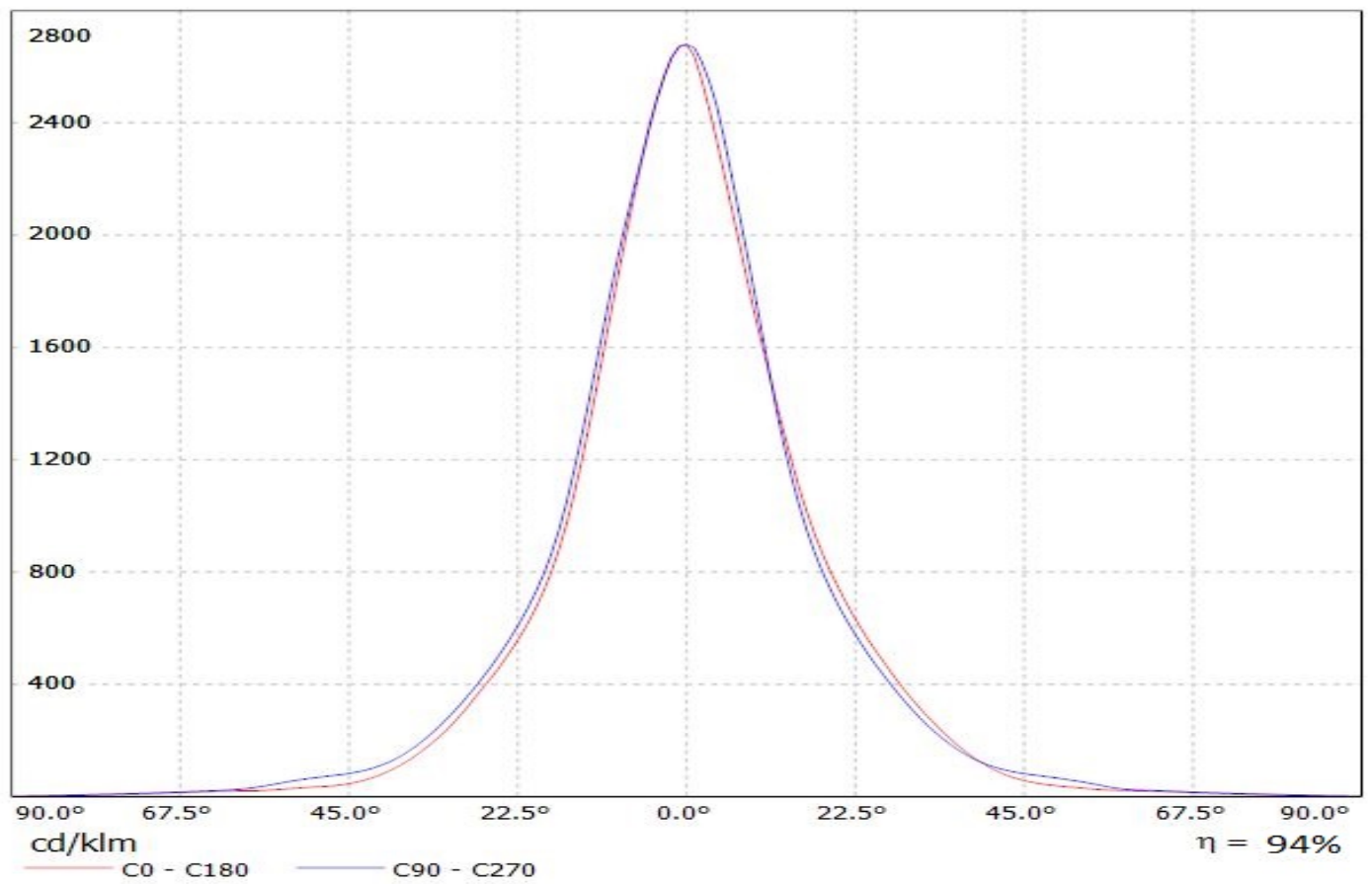

Luminaire: LEDiL Oy F14908\_SAGA-S\_(CXA1816)\_C1

Lamps: 1 x CXA1816\_(CXA1816\_(SOF-P4-N0H-00001))\_1117.67lm@250mA\_P=8.61635W\_I=0.250A

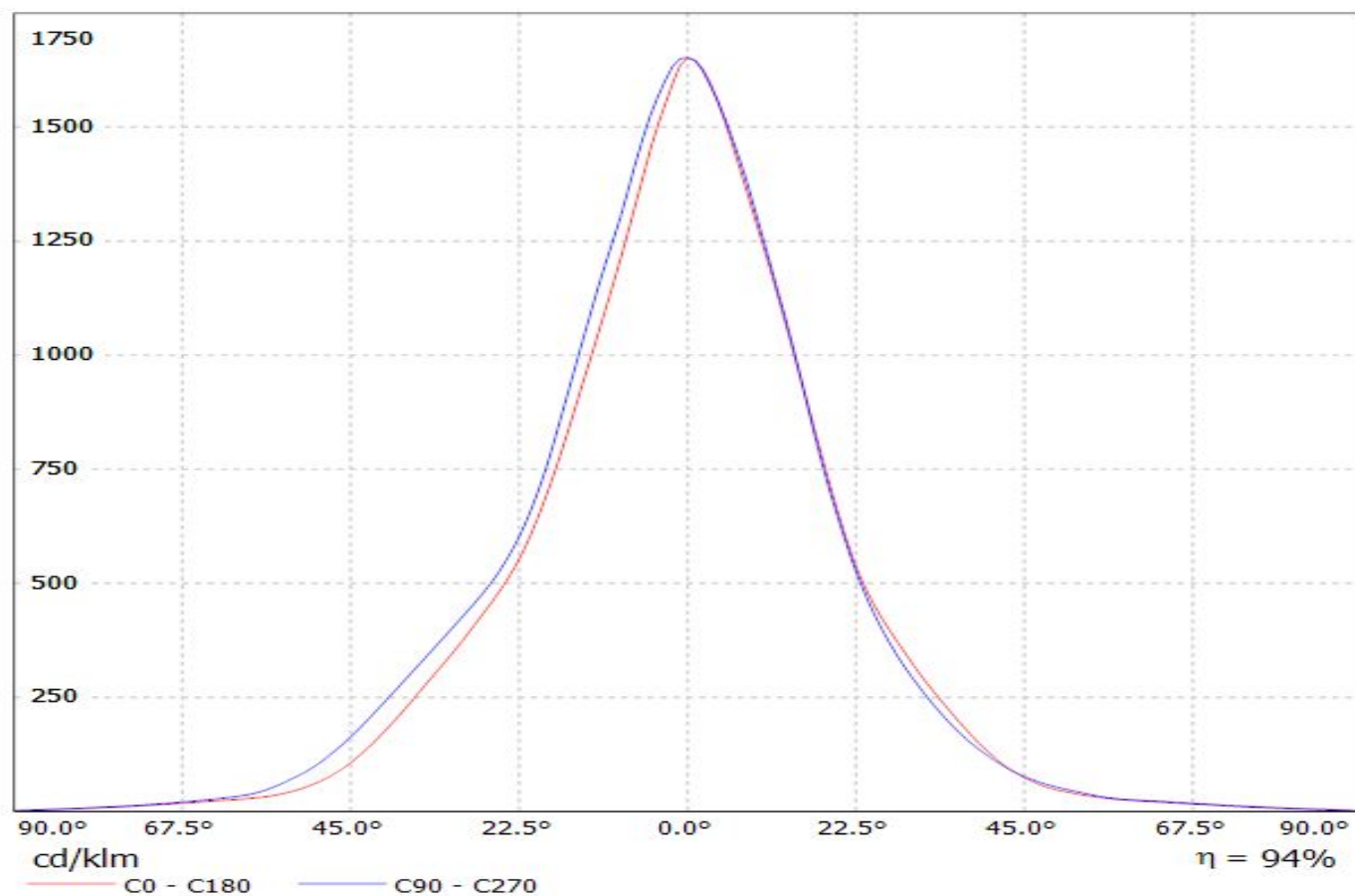



Luminaire: Ledil Oy FCN14933\_SAGA-S-WHT\_(LC040C)\_(B+W\_480\_Typ\_L6)\_SIMULATED  
Lamps: 1 x Samsung LC040C + Bender & Wirth Bender & Wirth 480 TYP L6

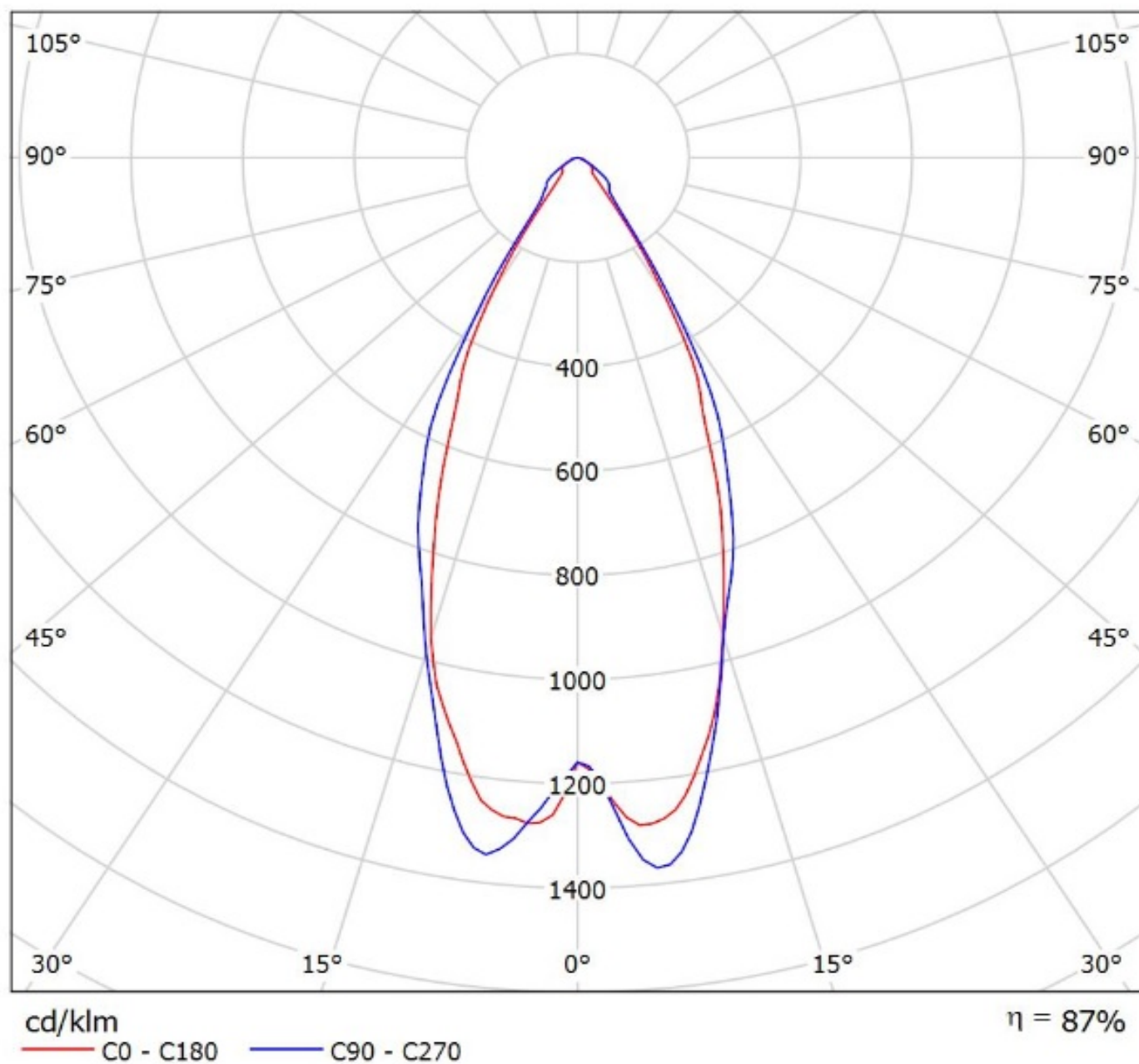

Luminaire: Ledil Oy FCN14933\_SAGA-S-WHT\_(CXB1310)\_SIMULATED  
Lamps: 1 x Cree CXB1310

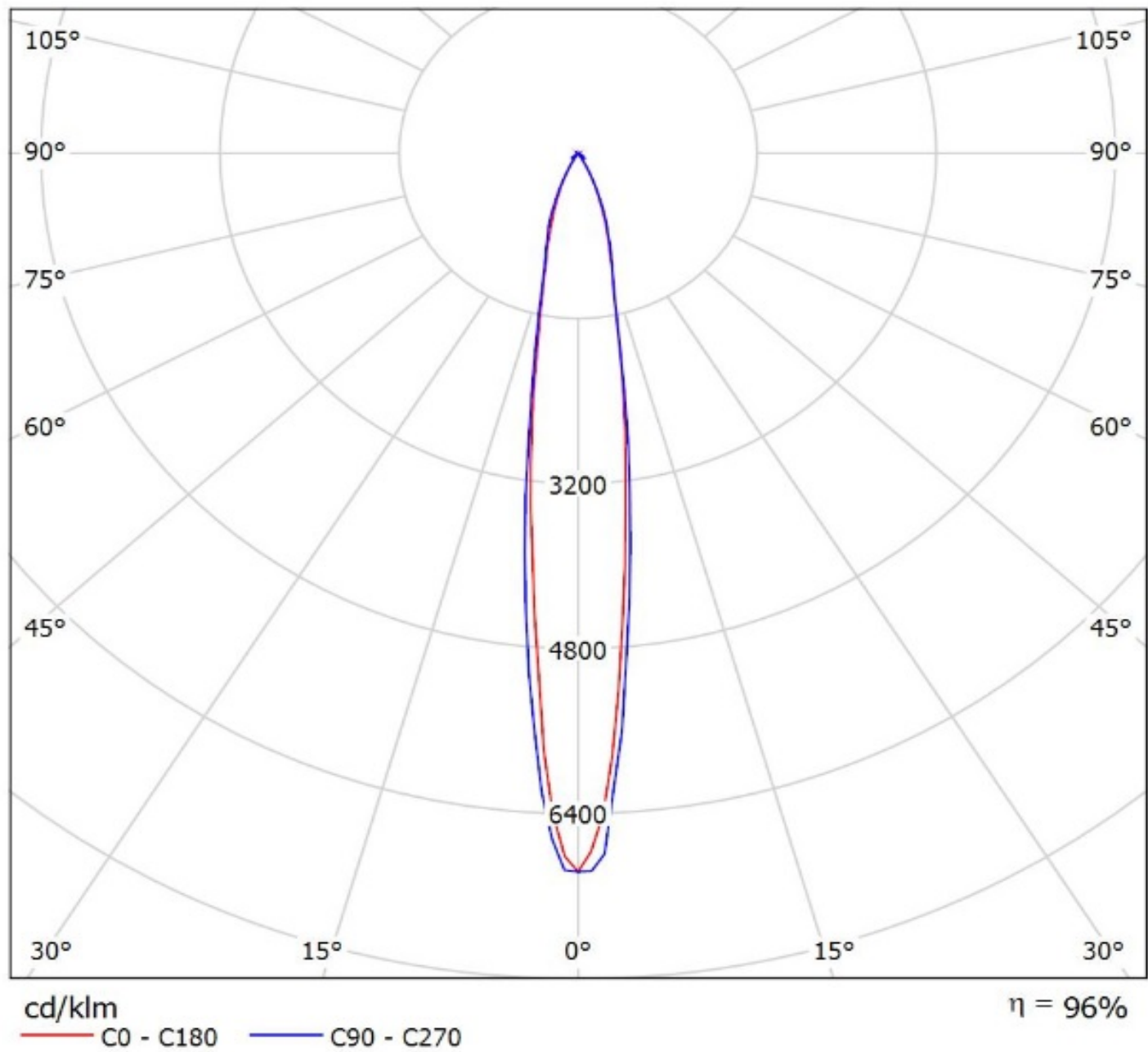

Luminaire: Ledil Oy FCN14933\_SAGA-S-WHT\_(LC010C)\_(B+W\_479\_Typ\_L6)\_SIMULATED  
Lamps: 1 x Samsung LC010C + Bender & Wirth 479 Type L6

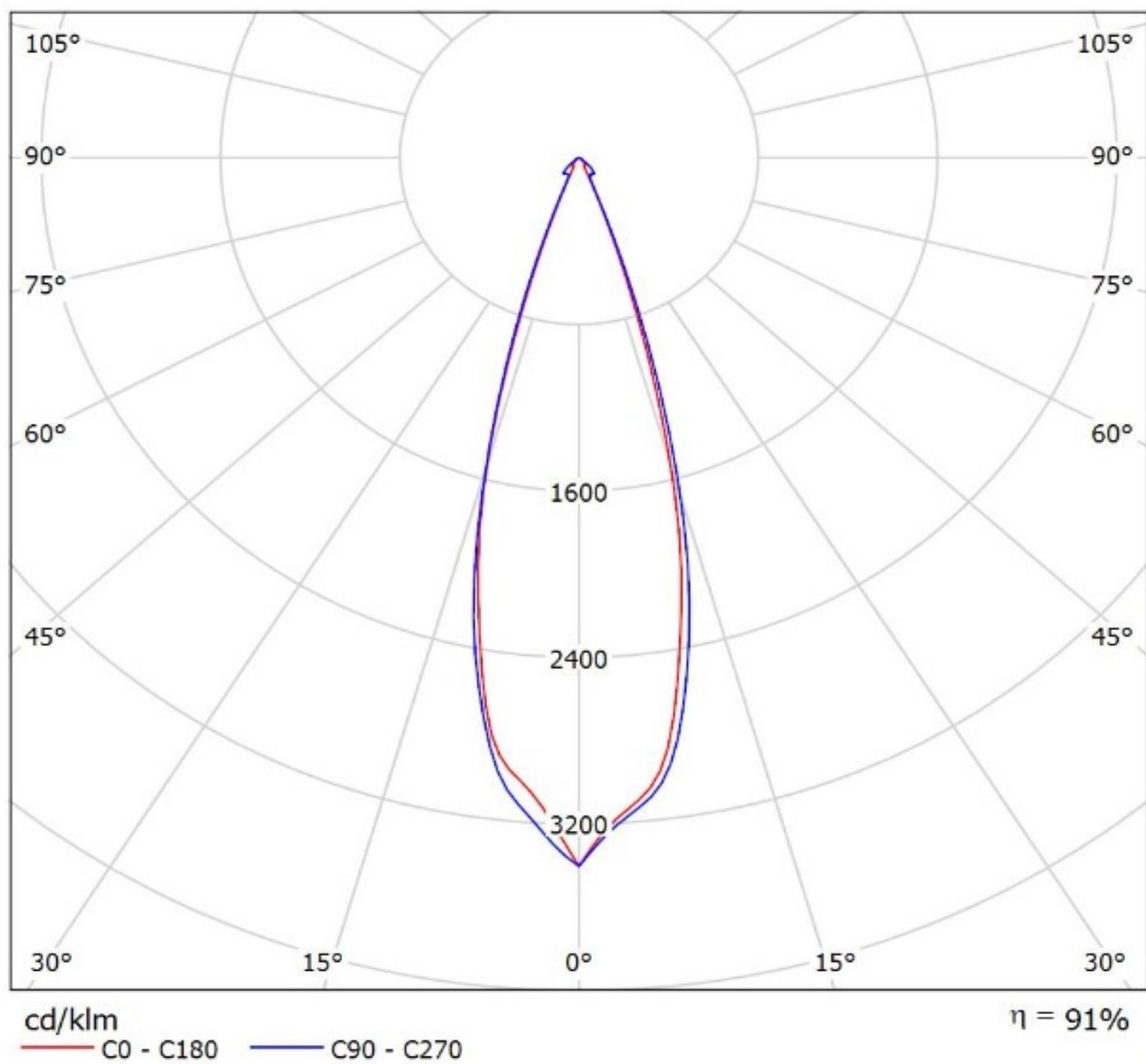

Luminaire: Ledil Oy FCN14933\_SAGA-S-WHT\_(LC020C)\_(B+W\_479\_Typ\_L6)\_SIMULATED  
Lamps: 1 x Samsung LC020C + Bender & Wirth Bender & Wirth 479 Typ L6

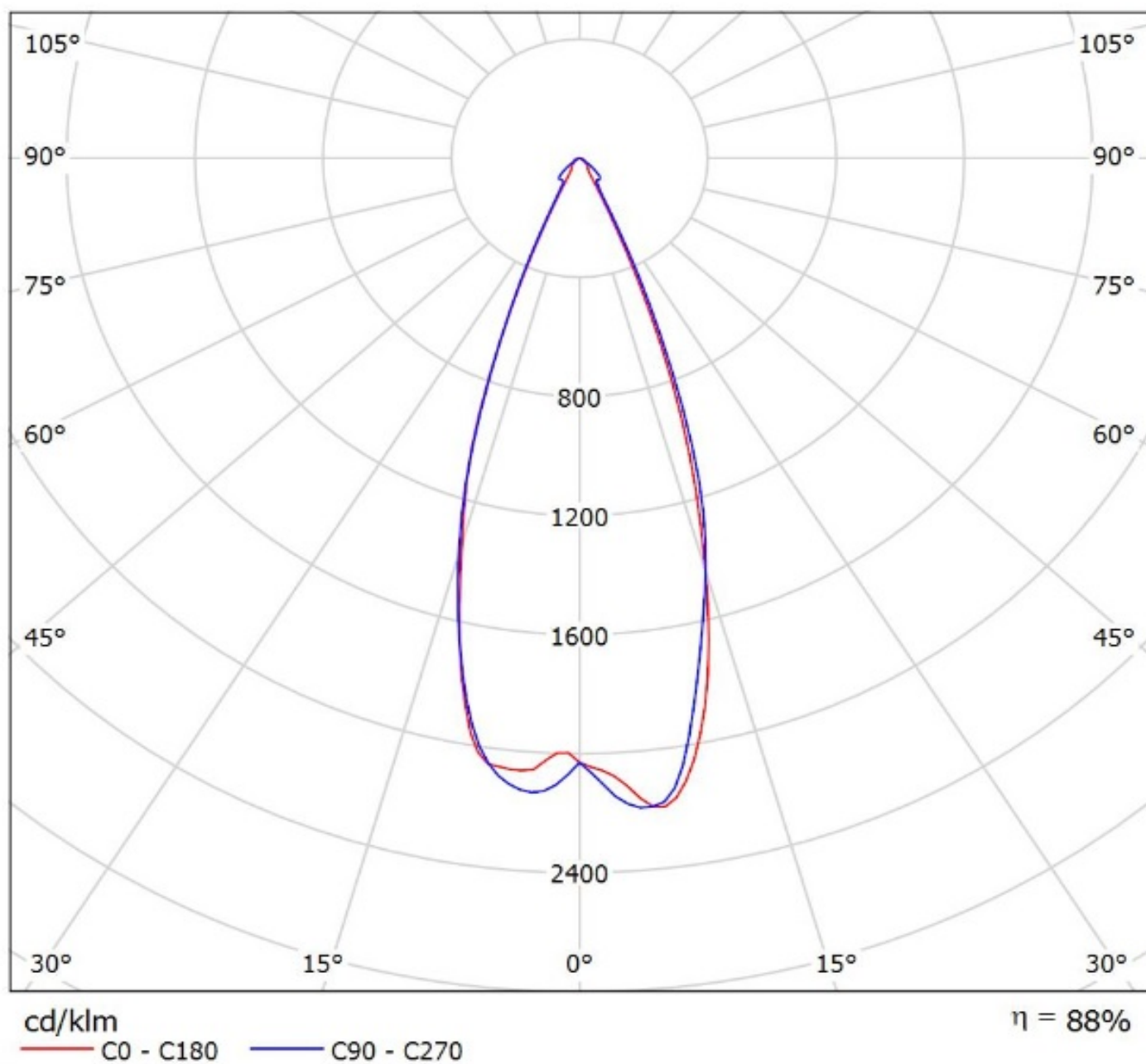

Luminaire: LEDiL Oy F14908\_SAGA-S\_(CXA1520)\_C1

Lamps: 1 x Cree\_CXA1520\_(CXA1520-30F-N4-N0H-0001)\_915.86lm@250mA\_P=8.27837W\_I=0.250A

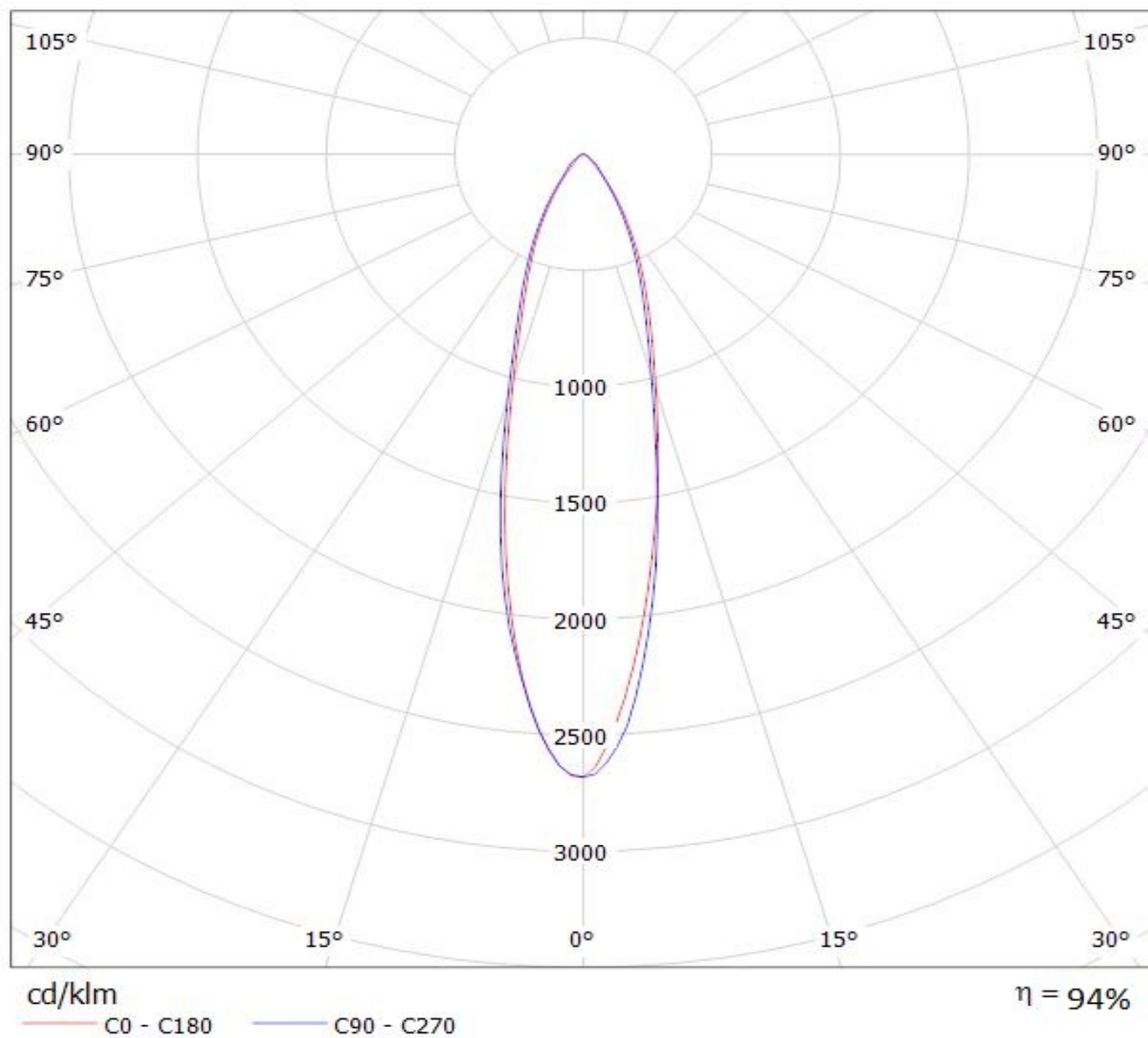

Luminaire: LEDiL Oy F14908\_SAGA-S\_(CXA1816)\_C1

Lamps: 1 x CXA1816\_(CXA1816\_(SOF-P4-N0H-00001))\_1117.67lm@250mA\_P=8.61635W\_I=0.250A

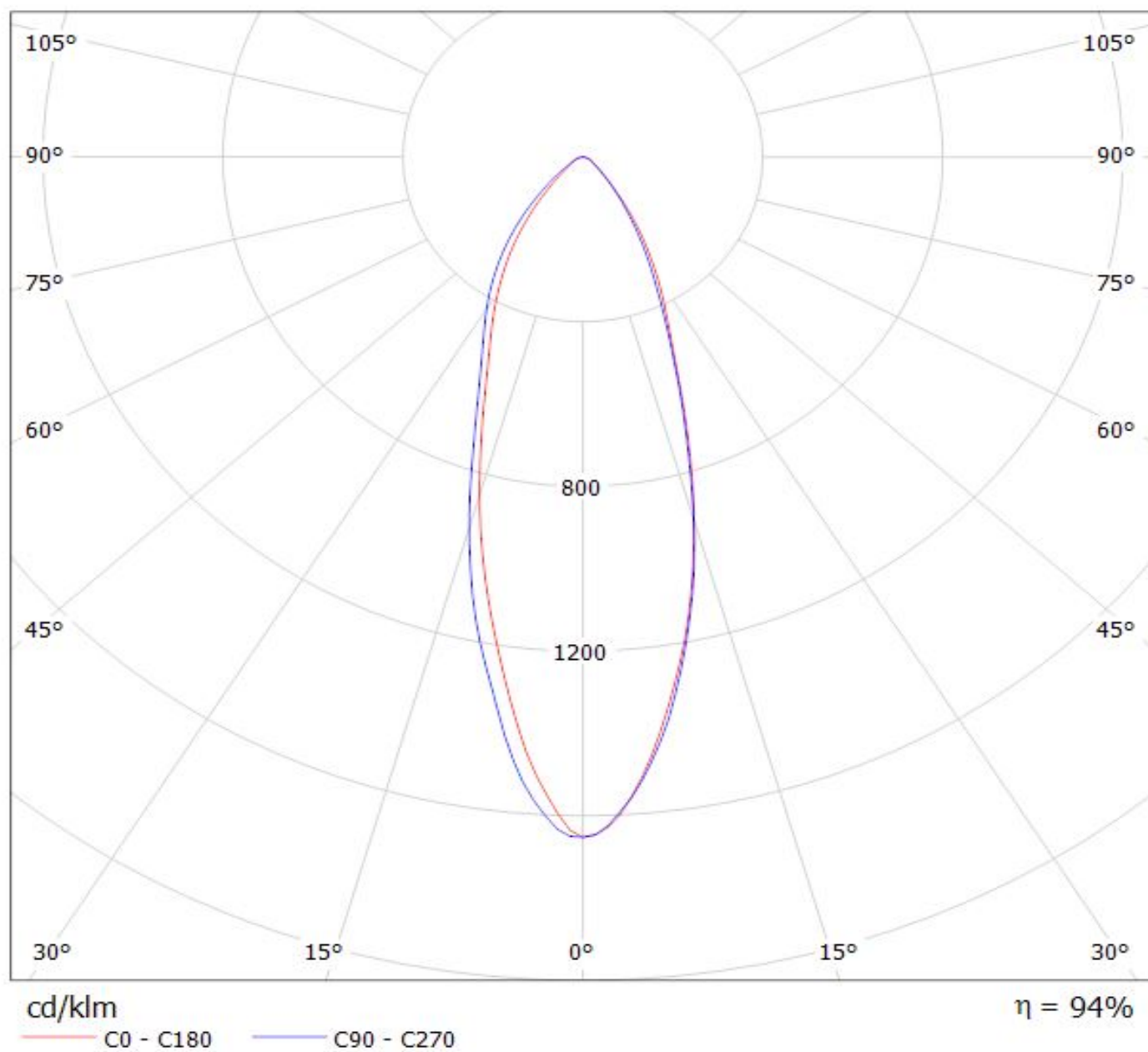

**NOTE: The typical divergence will be changed by different color, chip size and chip position tolerance. The typical total divergence is the full angle measured where the luminous intensity is half of the peak value.**

#### **GENERAL INFORMATION**

- Product series especially designed & optimized for series of LEDs.
- Special care taken to make light distribution as uniform as possible.

Note! Due to use of high power COB's with this product, special attention to proper thermal design is highly recommended. LEDiL has no liability for direct, indirect or consecutive damages arising from the LEDiL products being used outside of the recommended temperature range.