

SMA Male Plug to BMA Female Jack

Model Number

ADT-2768-SM-BMF-02

SPECIFICATIONS

Frequency: DC - 18.0 GHz
VSWR: 1.05 + .005 f (GHz)
Impedance: 50 Ohms
Finish: Passivated Stainless Steel

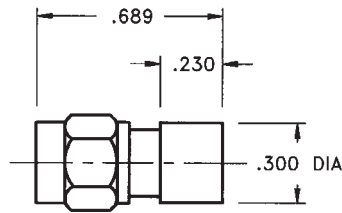

SMA Bulkhead Female Jack to BMA Female Jack

Model Number

ADT-2805-SF-BMF-02

SPECIFICATIONS

Frequency: DC - 18.0 GHz
VSWR: 1.05 + .005 f (GHz)
Impedance: 50 Ohms
Finish: Passivated Stainless Steel

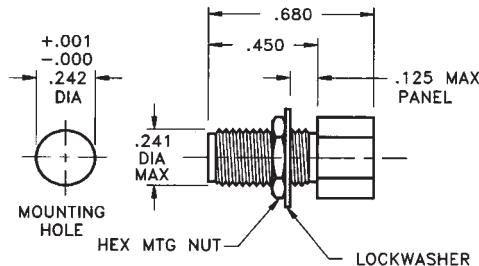

SMA Female Jack to BMA Female Jack - Bulkhead Mount

Model Number

ADT-2806-SF-BMF-02

SPECIFICATIONS

Frequency: DC - 18.0 GHz
VSWR: 1.05 + .005 f (GHz)
Impedance: 50 Ohms
Finish: Passivated Stainless Steel

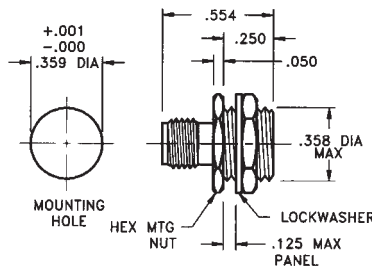

SMA Male Plug to BMA Female Jack - Bulkhead Mount

Model Number

ADT-2807-SM-BMF-02

SPECIFICATIONS

Frequency: DC - 18.0 GHz
VSWR: 1.05 + .005 f (GHz)
Impedance: 50 Ohms
Finish: Passivated Stainless Steel

