

ELECTRO-OPTICAL CHARACTERISTICS TA =25°C					VF=24V DC	
PARAMETER	MIN	TYP.	MAX	UNITS	TEST COND	
INPUT VOLTAGE		24		V DC		
ENERGY USED		2.5		W		
TOTAL LUMENS		150		LUMENS	VF=24V DC	
VIEWING ANGLE		120		2x theta		
COLOR TEMP.	2600		3000	°K		
COLOR RENDERING INDEX (CRI)		80				
OPERATING TEMP.	-20		45	°C		
STORAGE TEMP.	-20		40	°C		
LIFE HOURS			20,000	HRS		
EMITTED COLOR:	WARM WHITE					
EPOXY LENS FINISH:	WATER CLEAR					

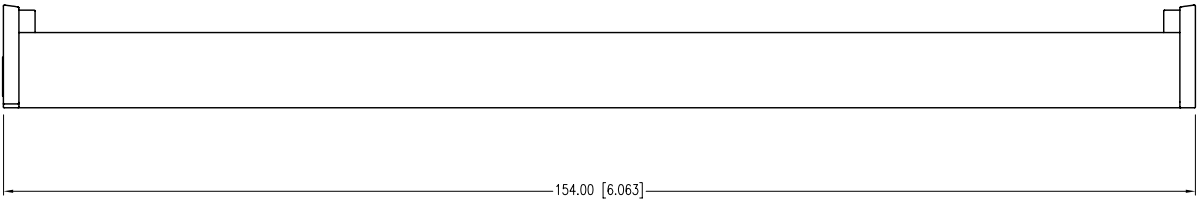

154.00 [6.063]

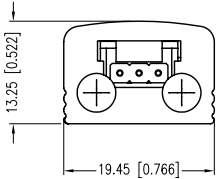

13.25 [0.522]

19.45 [0.766]

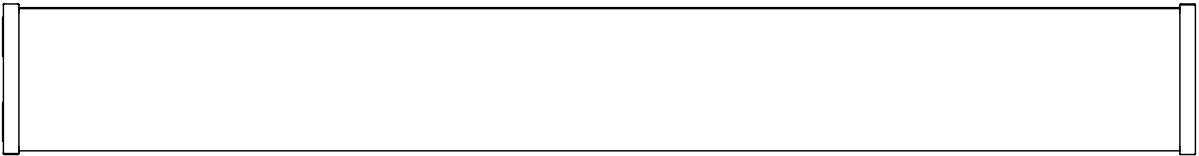

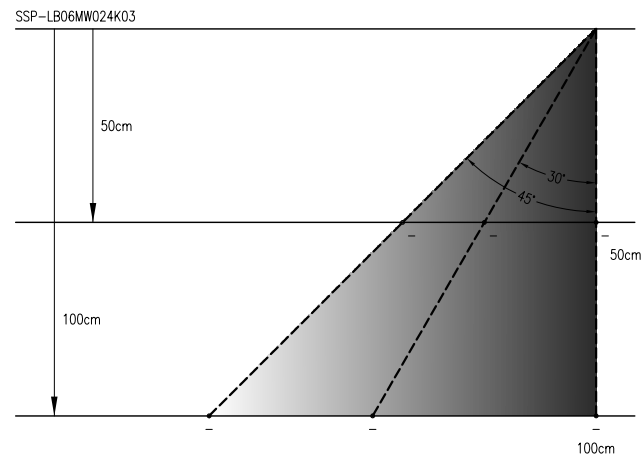

\*UNLESS OTHERWISE SPECIFIED TOLERANCES PER DECIMAL PRECISION ARE: X=±1 (±0.039), X.X=±0.5 (±0.020), X.XX=±0.25 (±0.010), X.XXX=±0.127 (±0.005). LEAD SIZE=±0.05 (±0.002), LEAD LENGTH=±0.75 (±0.030). MIN=  $\frac{+0.00}{-0.00}$  DECIMAL PRECISION MAX=  $\frac{+0.00}{-0.00}$  DECIMAL PRECISION

UNCONTROLLED DOCUMENT



290 E. HELEN ROAD  
PALATINE, IL 60067-6976  
PHONE: +1.847.359.2790  
FAX: +1.847.359.6538  
WEB: WWW.LUMEX.COM

LED LIGHT BAR, 6", WARM WHITE, 24V D.C., 120", 2.5W.

\*\*THE SPECIFICATIONS MAY CHANGE AT ANY TIME WITHOUT NOTICE DUE TO NEW MATERIALS OR PRODUCT IMPROVEMENT.\*\*

## CONFIDENTIAL INFORMATION

THE INFORMATION CONTAINED IN THIS DOCUMENT IS THE PROPERTY OF LUMEX INC. EXCEPT AS SPECIFICALLY AUTHORIZED IN WRITING BY LUMEX INC., THE HOLDER OF THIS DOCUMENT SHALL KEEP ALL INFORMATION CONTAINED HEREIN CONFIDENTIAL AND SHALL PROTECT SAME IN WHOLE OR IN PART FROM DISCLOSURE AND DISSEMINATION TO ALL THIRD PARTIES.

DATE:	07.13.11	DRAWN BY:	AB
PAGE:	2 OF 2	CHKD BY:	DT
SCALE:	NTS	APRVD BY:	SS
UNIT:	mm [INCH]		Ⓟ