

Table with 6 columns: PART NUMBER, REV, FIRST USED, POWER UNIT, FEED TYPE, DESCRIPTION. Rows include 1385507-1 through 7-1385507-7.

- RECOMMENDED SPARE PARTS.
GREASE LIGHTLY.
GUARD MUST BE IN PLACE WHEN OPERATING APPLICATOR IN A BENCH MACHINE.
LUBRICATE DAILY USING NO. 20 MACHINE OIL.
ITEMS WITH QTY OF REF SPECIFIED (EXCEPT ITEMS 78 AND 79) ARE USED ON ITEM 46.
THIS APPLICATOR APPLIES TERMINAL WITH A SEAL.
APPLY TORQ-SEAL IN ALLEN SOCKET TO FILL HOLE AFTER FLAT HD HAS BEEN ADJUSTED TO CORRECT HEIGHT AT QUALIFICATION. APPLY PN 1-23419-5 LOC-TITE TO THREADS.

Terminal Specifications Table with columns: AMP TERM PN, MFR TERM PN, PACKARD TERMINAL, PACKARD CRIMP SPECS, WIRE STRIP LENGTH, TERM APPL SPEC, FEED, APPL INSTRUCION, SET UP GAGE, LAYOUT.

Main Parts List Table with columns: QTY, REF, PART NO, DESCRIPTION, ITEM NO.

Large Parts List Table with columns: QTY, REF, PART NO, DESCRIPTION, ITEM NO.

THIS DRAWING IS A CONTROLLED DOCUMENT.

RELEASING FOR PUBLICATION... BY AMP INCORPORATED. ALL RIGHTS RESERVED.

LOC A, DIST 66

REVISION RECORD, DIMENSIONS IN INCHES, TOLERANCES UNLESS OTHERWISE SPECIFIED, DR B.HIGMAN, APP T.ELBIN, AMP Tyco Electronics, SIDE FEED HDM APPLICATOR, MACHINE REF MINI APPL, SCALE, DWG NO 1385507, SHEET 1 OF 2, REV B1

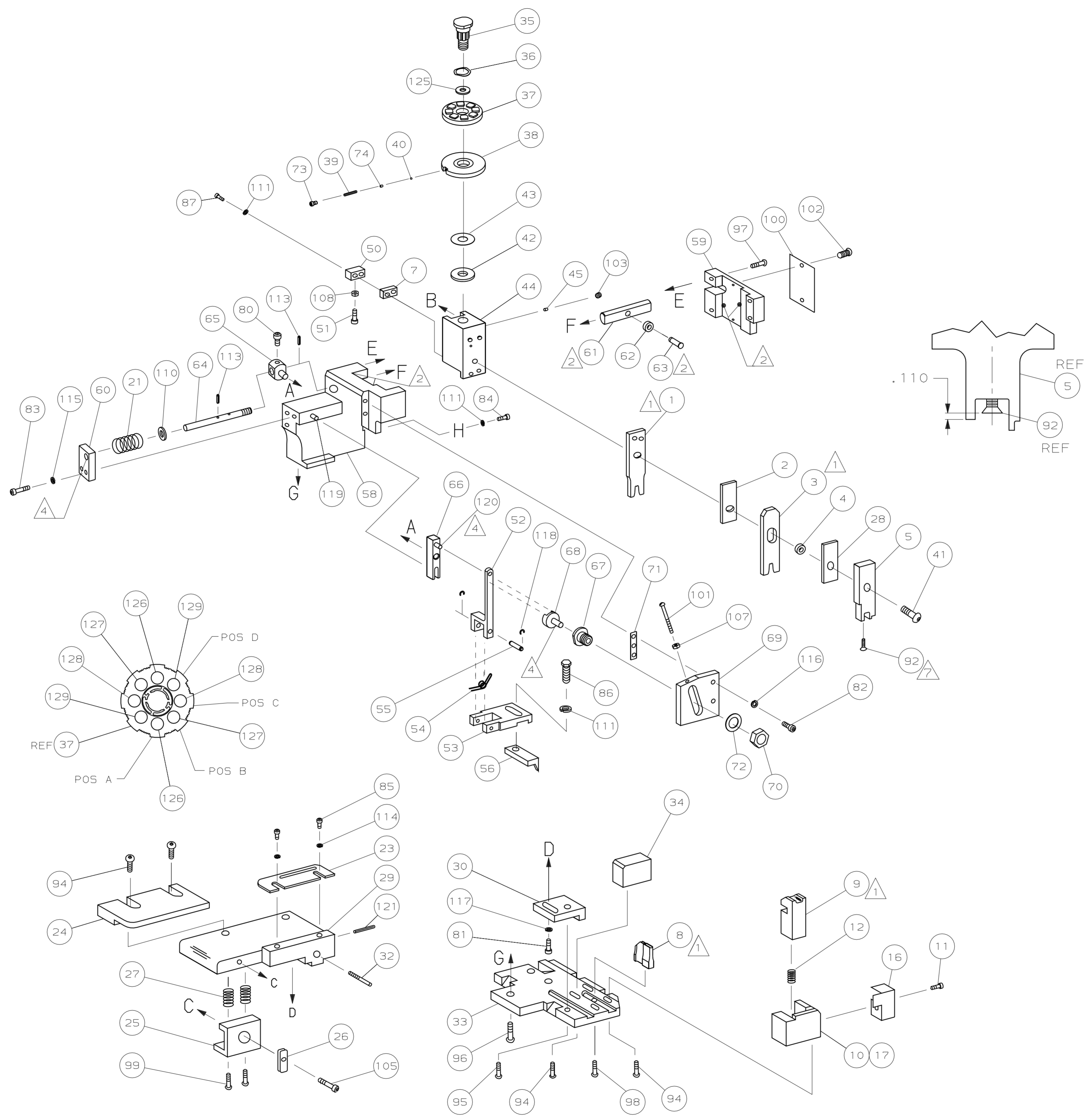
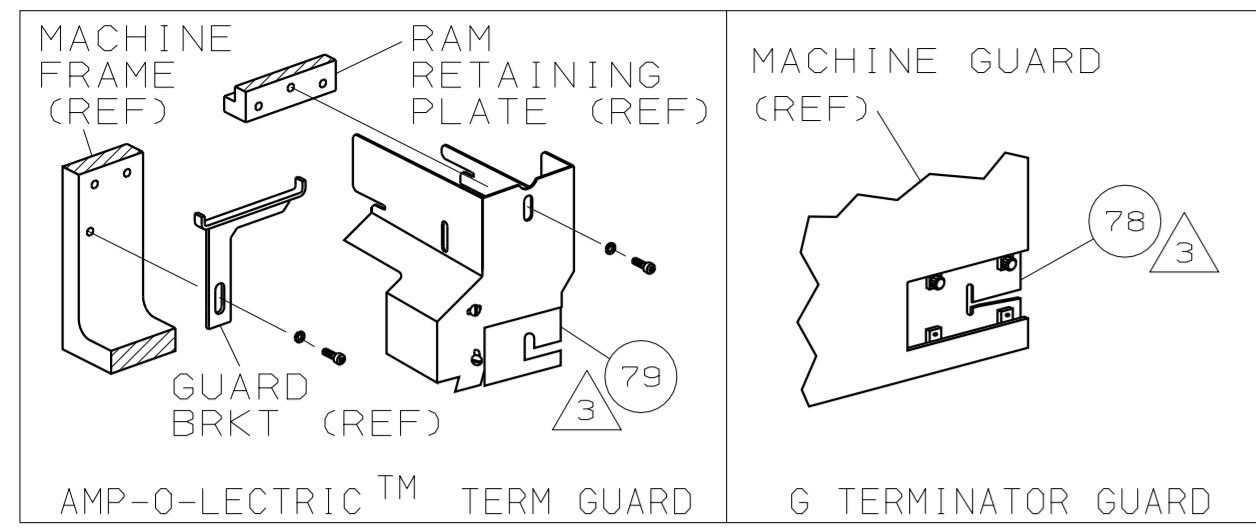

POST FEED 1 5/8 STROKE	PRE FEED 1 1/8 STROKE	PRE FEED 1 5/8 STROKE
ROTATED 180° B	ROTATED 180° B	ROTATED 180° B
LEADMAKER	K TERMINATOR	G TERMINATOR

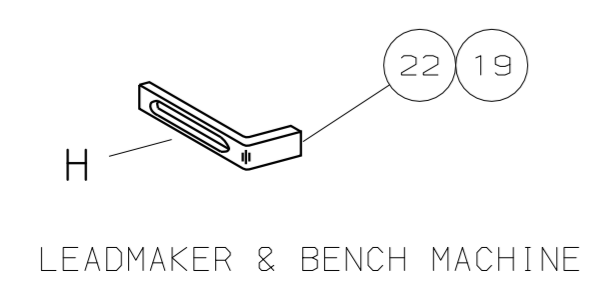

DWG SIZE	PART NO	DESCRIPTION	ITEM NO
REVISION OF EACH ASSY NO (WHEN BLANK, USE DWG REVISION)			
QTY REQD PER ASSY		PARTS LIST	
MATL	HT TR	FIN	
DIMENSIONS IN INCHES. DO NOT SCALE PRINT.			
TOLERANCES UNLESS OTHERWISE SPECIFIED:			
DR	20DEC06	APP	21DEC06
R.O.WILSON		T.BENCHOFF	
2 PLC DEC ±			
3 PLC DEC ±			
4 PLC DEC ±			
ANGLES ±			
SURF TEXTURE:			
REMOVE BURRS, BREAK SHARP EDGES R.015 MAX			
SCALE	DWG NO	1385507	SHEET 2 OF 2
CAGE CODE	00779	CUSTOMER AND ASSEMBLY DRAWING	REV B1

REV	DATE	APP	DATE
SEE SHEET 1			

THIS DRAWING IS A CONTROLLED DOCUMENT.

THIS DRAWING IS UNPUBLISHED. RELEASED FOR PUBLICATION BY AMP INCORPORATED. ALL RIGHTS RESERVED. AMP 1756 REV 3-92

LOC A
DIST 66

1385507

D

C

B

A