

1-stage filter for 3-phase systems with neutral conductor



Description

- Terminals for three phases, neutral conductor and ground
- High symmetrical and asymmetrical attenuation
- In the frequency range from 10kHz up to 300MHz

Standards

- IEC 60939
- UL 1283, Edition 5, CSA 22.2 No. 8-M1986, @ Ta 75 °C

Approvals

- VDE Certificate Number: pending
- UL File Number: E72928

Applications

- Voltage rating 480 VAC for world wide acceptance
- Protection against interference voltage from the mains
- For standard and industrial applications
- Qualified for use in equipment according IEC/EN 60950

Weblinks

[pdf-datasheet](#), [html-datasheet](#), [General Product Information](#), [Approvals](#), [CE declaration of conformity](#), [RoHS](#), [CHINA-RoHS](#), [e-Shop](#), [SCHURTER-Stock-Check](#), [Distributor-Stock-Check](#), [Detailed request for product](#)

Technical Data

Rated Current	6 - 550A
Rated voltage	277/480VAC, 50/60 Hz
Approval for	6 - 550A @ 40 (75) °C / 277/480VAC
Overload Current	1.5 x Ir
Leakage Current	industrial < 5 mA (440V / 50Hz)
Dielectric Strength	277/480VAC: 2.25 kVDC between L-L 1.7 kVDC between L-N 3 kVDC between L-PE 2.7 kVDC between N-PE Test voltage (2 sec)
Number of Filter Stages	1-stage
Weight	0.95 - 24.5 kg
Material: Housing	Metal
Sealing Compound	UL 94V-0

Mounting	Screw-on mounting on chassis, from top
Terminal	Screw clamps
Operating Temperature [°C]	-25 °C to 100 °C
Climatic Category	25/100/21 acc. to IEC 60068-1
Degree of Protection	IP 20 acc. to IEC 60529
Protection Class	Suitable for appliances with protection class I acc. to IEC 61140
MTBF	> 200'000h acc. to MIL-HB-217 F

Dimensions

Case 24-3

Case 31-4

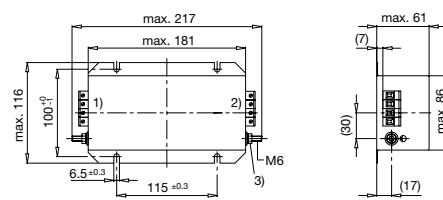
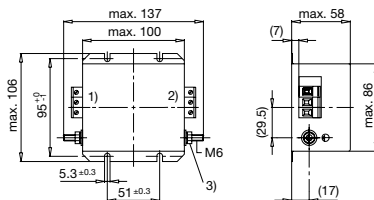

- 1) Line
- 2) Load
- 3) Nut torque 3...4 Nm

Case 32-4

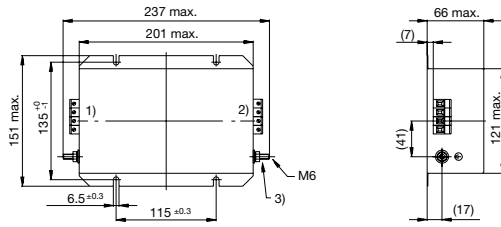

Case 32-8

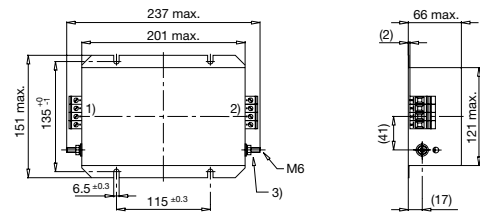

Case 34-4

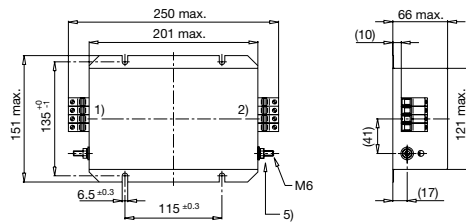

Case 37-4

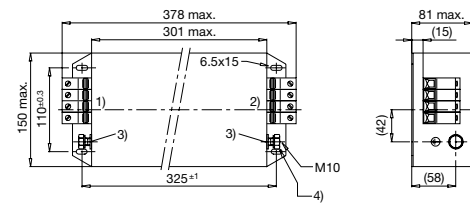

Case 53-4

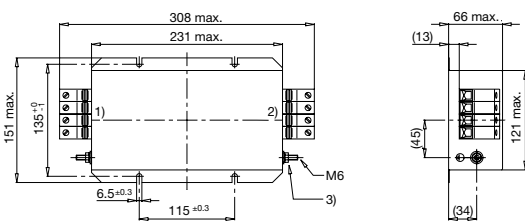

Case 54-4

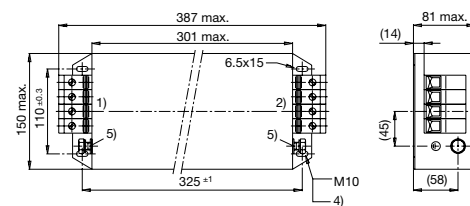

- 1) Line
- 2) Load
- 3) Tightening torque 3...4 Nm
- 4) Tightening torque 10...17 Nm
- 5) Do not unscrew lock-nut

Case 55-4

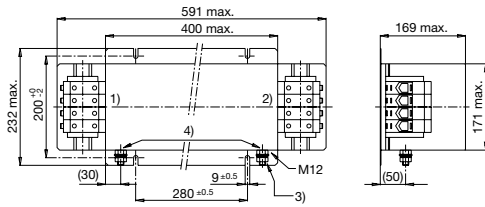

Case 56-4

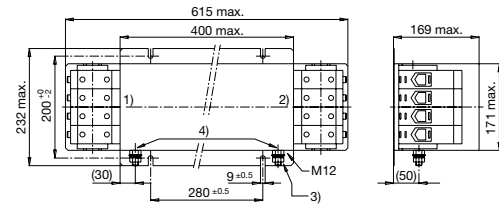

- 1) Line
- 2) Load
- 3) Nut torque 14...30 Nm
- 4) Do not unscrew lock-nut

Case KQ

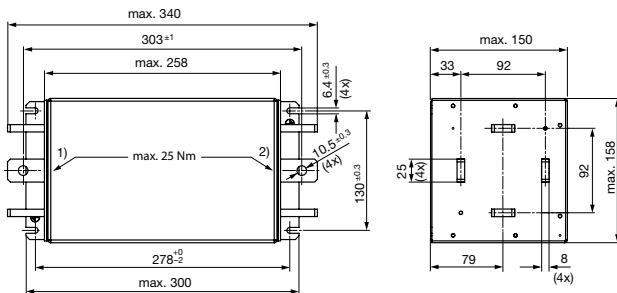

- 1) Line
- 2) Load
- 3) Torsional stress at flat copper max. 25 Nm

Technical data to the filter components

Rated Current @ Ta 40°C (75°C) [A]	L [mH]	C1 [µF]	C2 [µF]	C3 [nF]	C4 [nF]	C5 [µF]	C6 [µF]	R1 [MΩ]	R2 [MΩ]	R3 [MΩ]	R4 [MΩ]
6 (4.8)	9	1.0	-	100	10	2.2	-	-	-	1	2.2
8 (5)	8	1.0	-	100	10	2.2	-	-	-	1	2.2
16 (9.5)	5	1.0	-	100	10	2.2	-	-	-	1	2.2
25 (13)	2.6	4.4	1	10	47	4.4	1	-	1	1	2.2
36 (19)	1.8	4.4	1	10	47	4.4	1	2.2	1	1	-
50 (32)	0.8	4.4	1	10	100	4.4	1	2.2	1	1	-
64 (34)	0.6	4.4	1	10	100	4.4	1	2.2	1	1	-
80 (43)	0.9	6.6	1	47	100	6.6	1	2.2	1	1	-
110 (66)	0.5	6.6	1	47	100	6.6	1	2.2	1	1	-
180 (95)	0.25	6.6	1	47	100	6.6	1	2.2	1	1	2.2
250 (120)	0.2	11	1	100	100	11	1	2.2	0.5	0.5	2.2
550 (320)	0.2	10	1	100	100	10	1	2.2	0.5	0.5	2.2

Diagrams

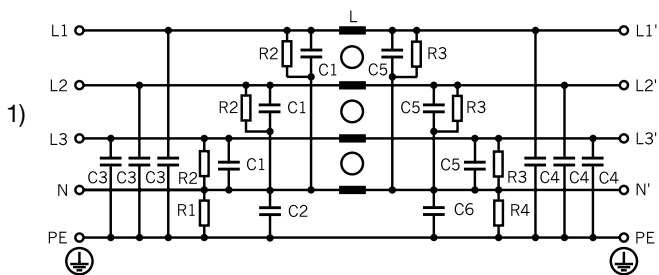

1) Power Line

Derating Curves

Permissible Working Current as a Function of Ambient Temperature

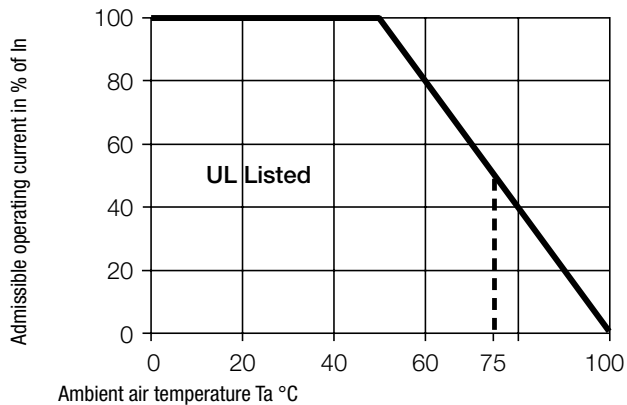

Attenuation Loss

Industrial version

--- differential mode — common mode

6A (FMAD-0924-0610)

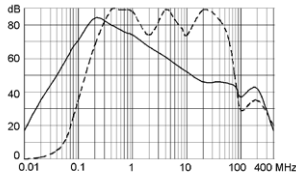

8A (FMAD-0931-0810)

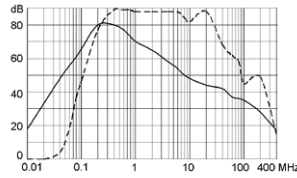

16A (FMAD-0931-1610)
16A (FMAD-0932-1610)

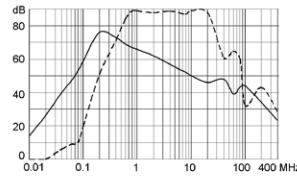

25A (FMAD-0932-2510)

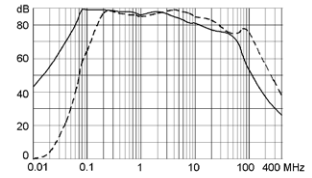

36A (FMAD-0934-3610)

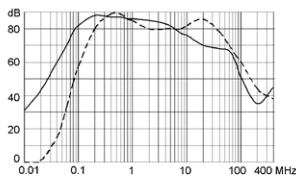

50A (FMAD-0934-5010)

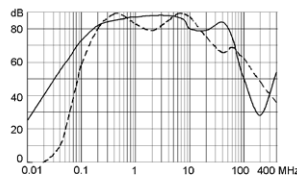

64A (FMAD-0953-6410)

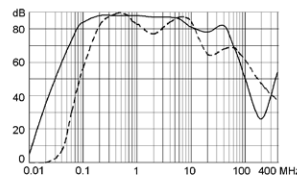

80A (FMAD-0937-8010)

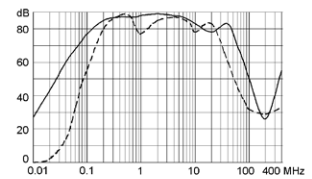

110A (FMAD-0954-H110)

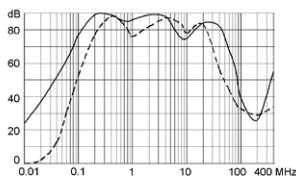

180A (FMAD-0955-H210)

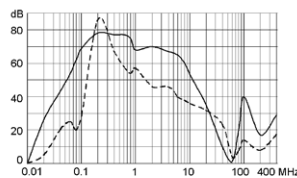

250A FMAD-0956-H310

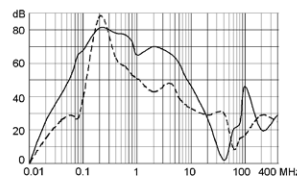

550A FMAD-09KQ-H650

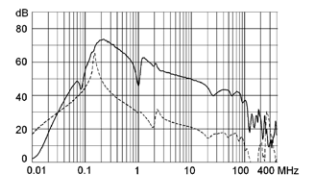

Variants

Rated Current @ Ta 40°C (75°C) [A]	Rated Voltage [VAC]	Tripped Power Dissipation [W]	Contact Resistance [mΩ]	Weight [kg]	Clamps [mm ²]	Housing	Order Number
6 (4.8)	277/480	3.9	27	0.95 kg	4	24-4	FMAD-0924-0610
8 (5)	277/480	9	35	1.9 kg	4	31-4	FMAD-0931-0810
16 (9.5)	277/480	15.4	15	2.1 kg	4	31-4	FMAD-0931-1610
16 (9.5)	277/480	15.4	15	3.1 kg	4	32-4	FMAD-0932-1610
25 (13)	277/480	11.5	4.6	3.35 kg	6	32-8	FMAD-0932-2510
36 (19)	277 - 480	21	4	3.4 kg	10	34-4	FMAD-0934-3610
50 (32)	277/480	20	2	3.4 kg	10	34-4	FMAD-0934-5010
64 (34)	277/480	27	1.6	4.3 kg	25	53-4	FMAD-0953-6410
80 (43)	277/480	39	1.5	7.35 kg	25	37-4	FMAD-0937-8010
110 (66)	277/480	58	1.2	7.25 kg	50	54-4	FMAD-0954-H110
180 (95)	277/480	51	0.39	22 kg	95	55-4	FMAD-0955-H210
250 (120)	277/480	62.5	0.25	24.5 kg	240	56-4	FMAD-0956-H310
550 (320)	277/480	36	0.03	10.6 kg	1)	KQ	FMAD-09KQ-H650

1) Connection straps for M10
6A version: packing unit 2 pcs.

Packaging unit 1 Pcs