

| REVISIONS | | | | | |
|-----------|-----|--------------------------|-----------|-----|------|
| P | LTR | DESCRIPTION | DATE | DWN | APVD |
| | B | REV PER ECO-09-020440 | 11SEP2009 | CR | JP |
| | B1 | REVISE PER ECR-15-013438 | 11SEP2015 | RG | SH |
| | | | | | |
| | | | | | |

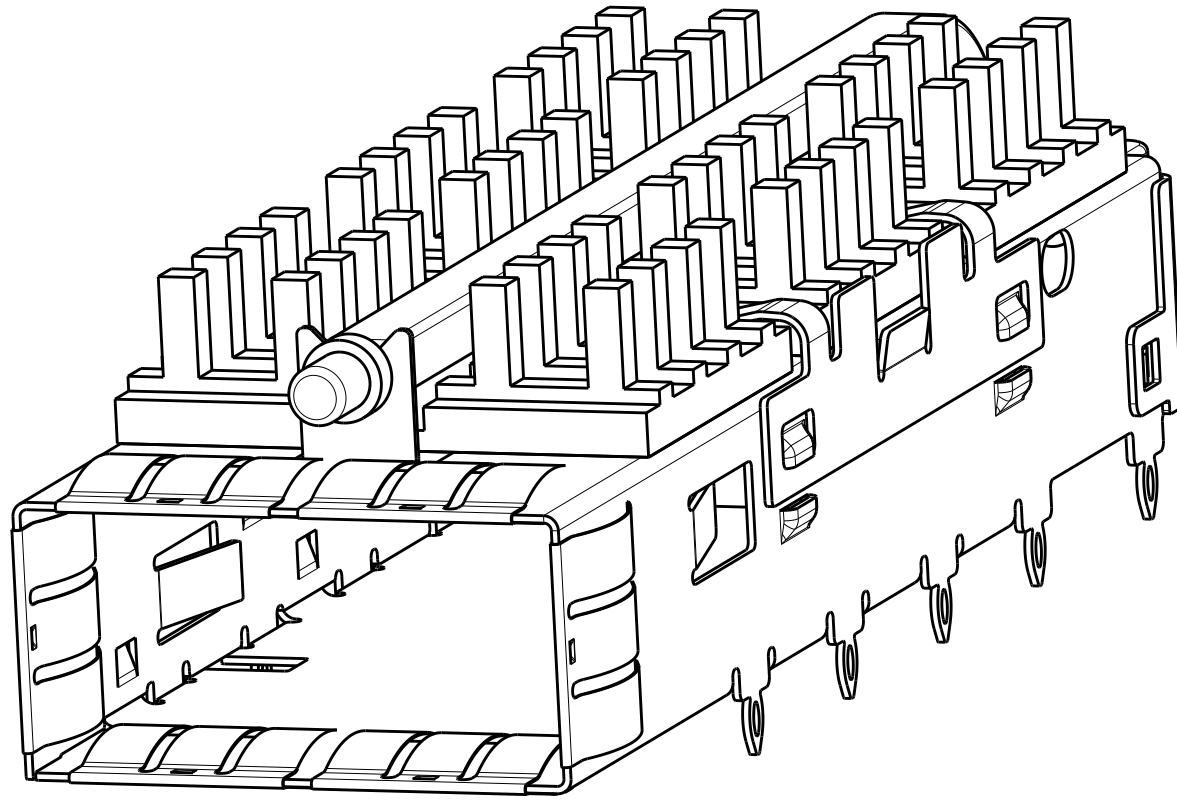

Sn42Bi58 SOLDER
6 PLACES

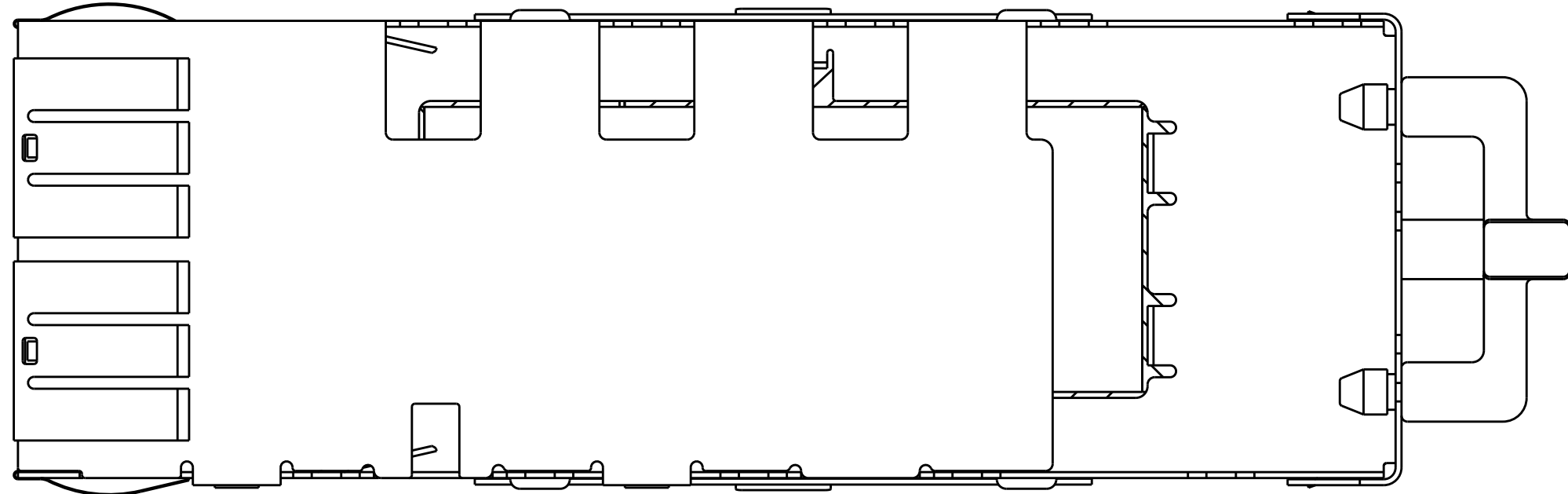
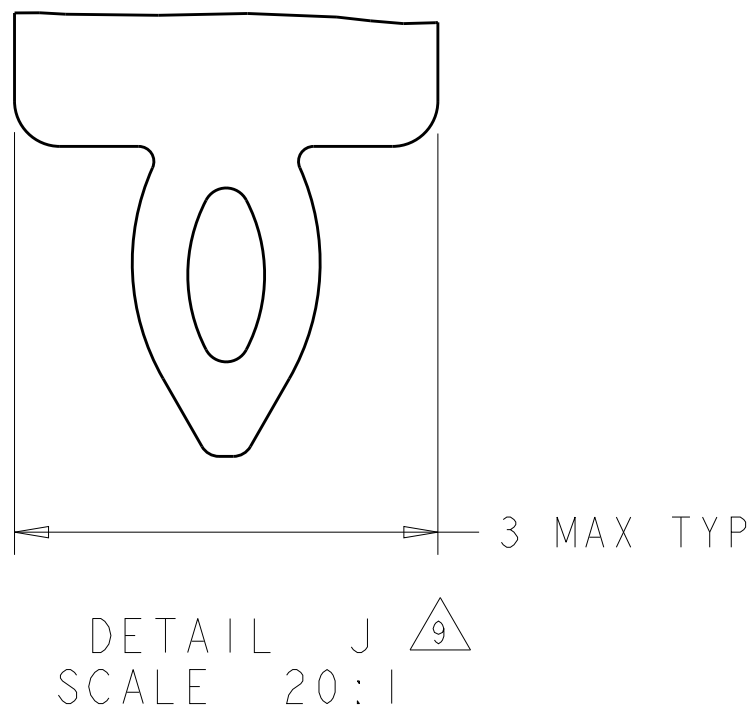
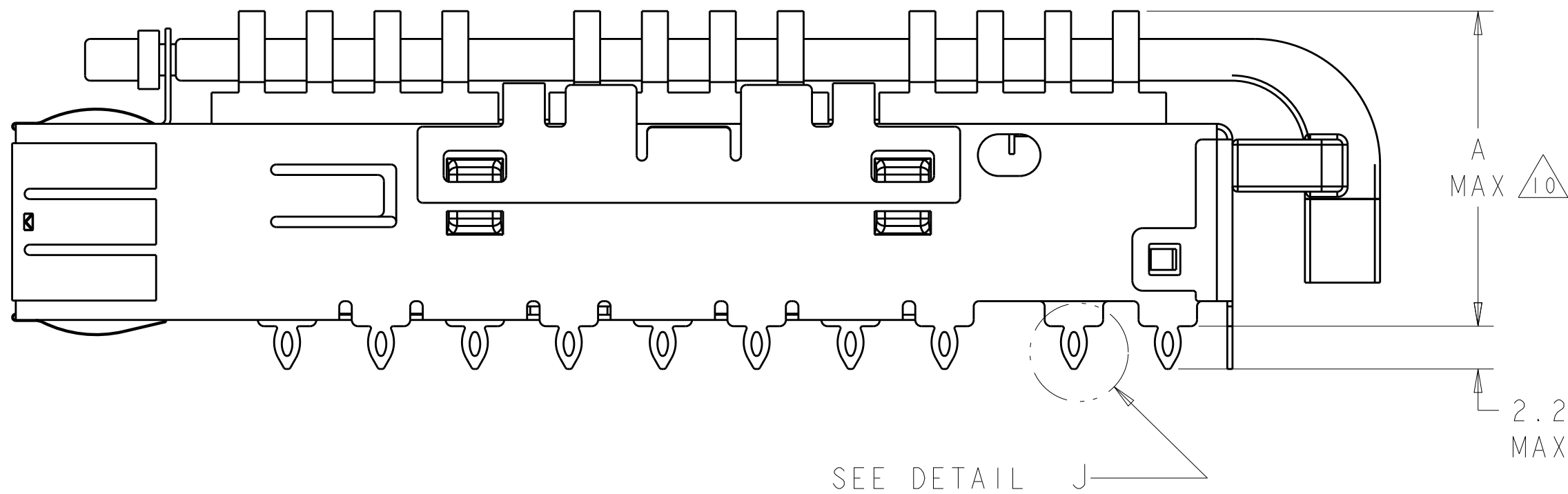
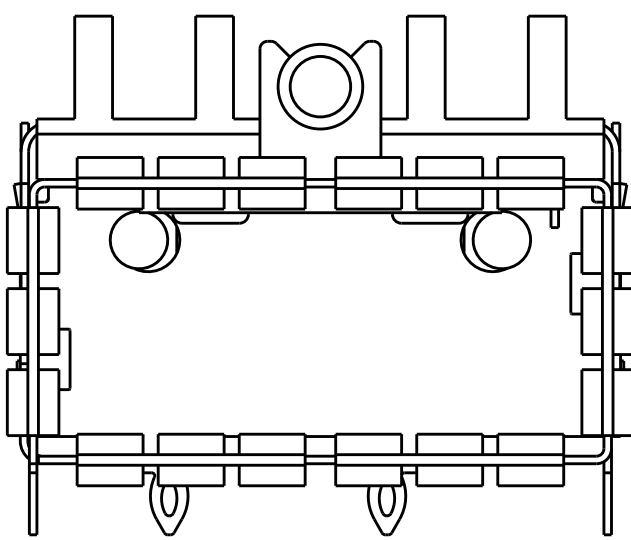
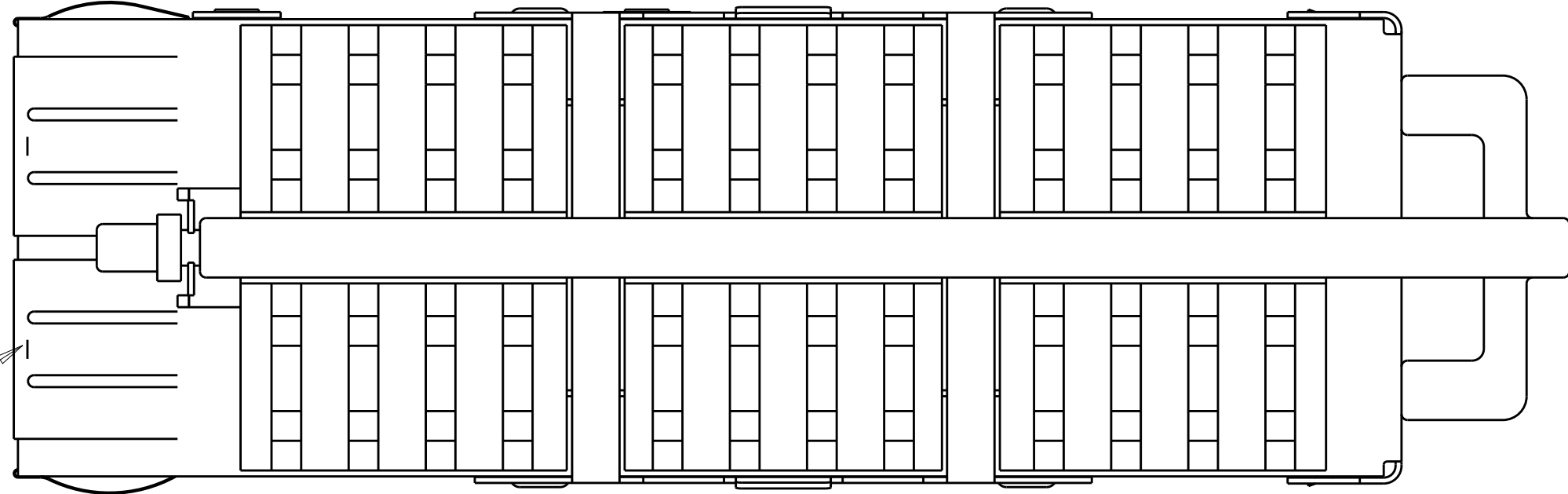

1. CAGE MATERIAL: NICKEL SILVER, 0.25 THICK
HEAT SINK MATERIAL: ALUMINUM
HEAT SINK CLIP MATERIAL: STAINLESS STEEL
LIGHT PIPE MATERIAL: CLEAR POLYCARBONATE, UL-94V-0 RATED.
EMI SPRING MATERIAL: COPPER ALLOY
2. MINIMUM PITCH DIMENSION.
3. MATES WITH QSFP MSA COMPATIBLE TRANSCEIVER.
4. REFERENCE APPLICATION SPEC 114-13217 FOR RECOMMENDED DRILL HOLE DIAMETER AND PLATING THICKNESS.
5. DATUMS AND BASIC DIMENSIONS ESTABLISHED BY CUSTOMER.
6. MINIMUM PC BOARD THICKNESS:
SINGLE SIDED = 1.45mm (shown, pg. 4)
DOUBLE SIDED = 2.2mm
7. HEAT SINK, CLIP, AND LIGHT PIPE SHIPPED ASSEMBLED TO CAGE ASSEMBLY. CAGE ASSEMBLY MAY BE PRESSED INTO THE PCB AS SHIPPED.
8. DATUM -A- IS TOP SURFACE OF HOST BOARD.
9. SURFACE TRACES PERMITTED WITHIN THIS AREA EXCEPT WHERE CAGE STANDOFFS, SHOWN IN DETAIL J, CONTACT PC BOARD.
10. DIMENSION APPLIES WITH MODULE INSTALLED IN THE CAGE TO TOP OF HEAT SINK.
11. MAXIMUM HEIGHT OF CUSTOMER SUPPLIED LED OFF PC BOARD: 1.70mm.
12. DATE CODE (YYWWD) MARKED ON TOP OF CAGE AND CONCEALED BY HEAT SINK APPLIES TO CAGE ASSEMBLY ONLY.
13. SPRING FINISH: 0.8µm MIN TIN OVER 0.8µm MIN NICKEL. NON-PLATED EDGES PERMISSIBLE.
14. HEAT SINK AND CLIP SHIPPED ASSEMBLED TO CAGE ASSEMBLY. CAGE ASSEMBLY MAY BE PRESSED INTO THE PCB AS SHIPPED. LIGHT PIPE MUST BE ASSEMBLED BY CUSTOMER AFTER THE CAGE IS SEATED ON THE PCB.

| | | |
|------|-----------------------|-------------|
| 13.7 | PCI HEAT SINK | 1888972-3 |
| 23.0 | NETWORKING HEAT SINK | 1888972-2 |
| 16.0 | SAN HEAT SINK (SHOWN) | 1888972-1 |
| A | DESCRIPTION | PART NUMBER |

| | | | | | |
|--|--|---|-------------------------------------|---|--|
| THIS DRAWING IS A CONTROLLED DOCUMENT. | | DWN C. VALENTINE CHK E. BRIGHT APVD F. BRIGHT | 09MAR2007 09MAR2007 09MAR2007 | TE Connectivity | |
| DIMENSIONS: | | TOLERANCES UNLESS OTHERWISE SPECIFIED: | | NAME | |
| mm | | 0 PLC ±.5 1 PLC ±0.5 2 PLC ±0.13 3 PLC ±0.013 4 PLC ±0.0001 ANGLES ±.5 | | CAGE ASSEMBLY, THRU BEZEL, QSFP, W/ HEAT SINK AND SINGLE LIGHT PIPE | |
| MATERIAL | | FINISH | | SIZE | |
| TBD | | 13 | | CAGE CODE | |
| | | | | DRAWING NO | |
| | | | | RESTRICTED TO | |
| | | | | A100779C=1888972 | |
| | | | | CUSTOMER DRAWING | |
| | | | | SCALE 4:1 | |
| | | | | SHEET 1 OF 4 | |
| | | | | REV B1 | |

| REVISIONS | | | | | |
|-----------|------|-------------|------|------|-------|
| P. | LTR. | DESCRIPTION | DATE | DWN. | APVD. |
| - | - | SEE SHEET 1 | - | - | - |
| | | | | | |
| | | | | | |
| | | | | | |

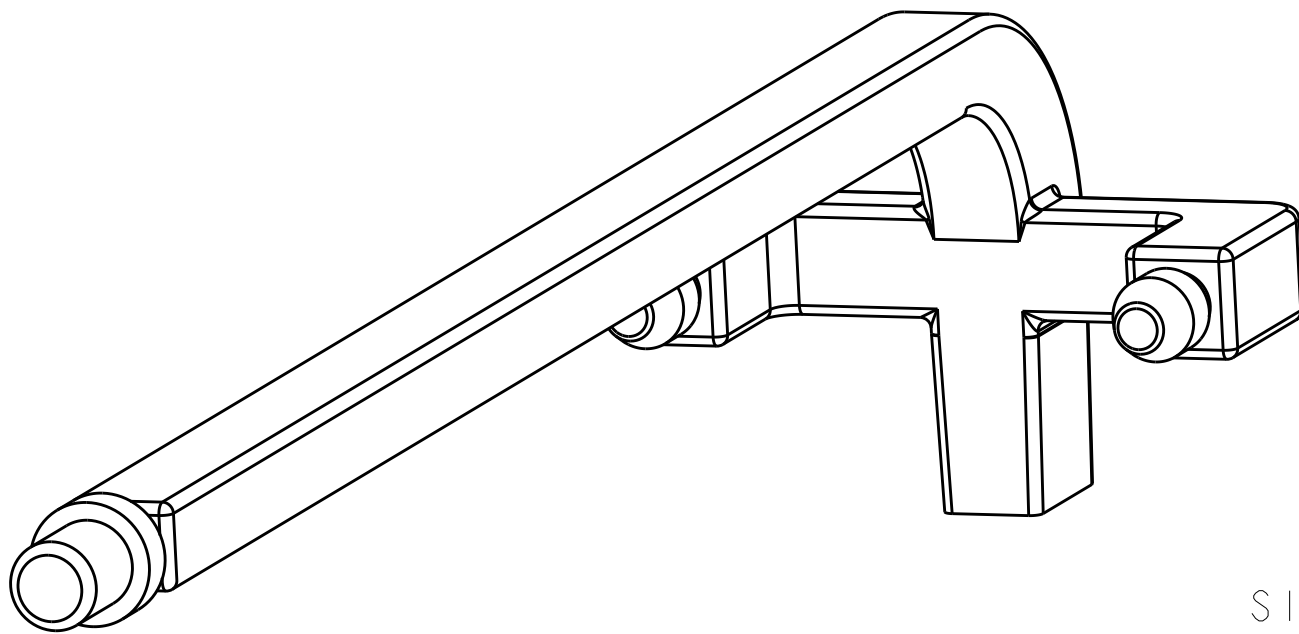

SINGLE LIGHT PIPE

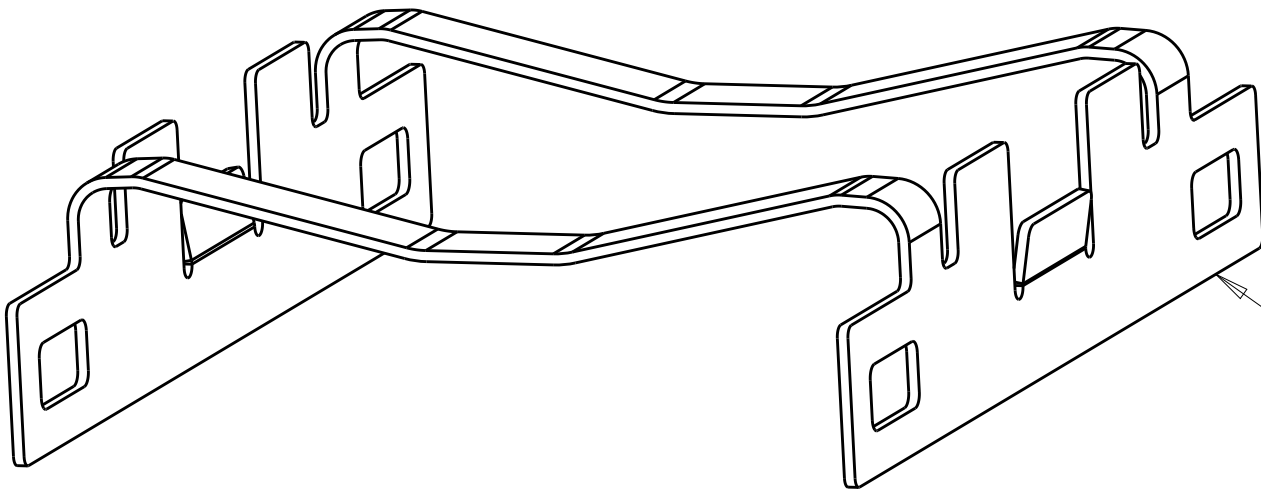

HEAT SINK CLIP

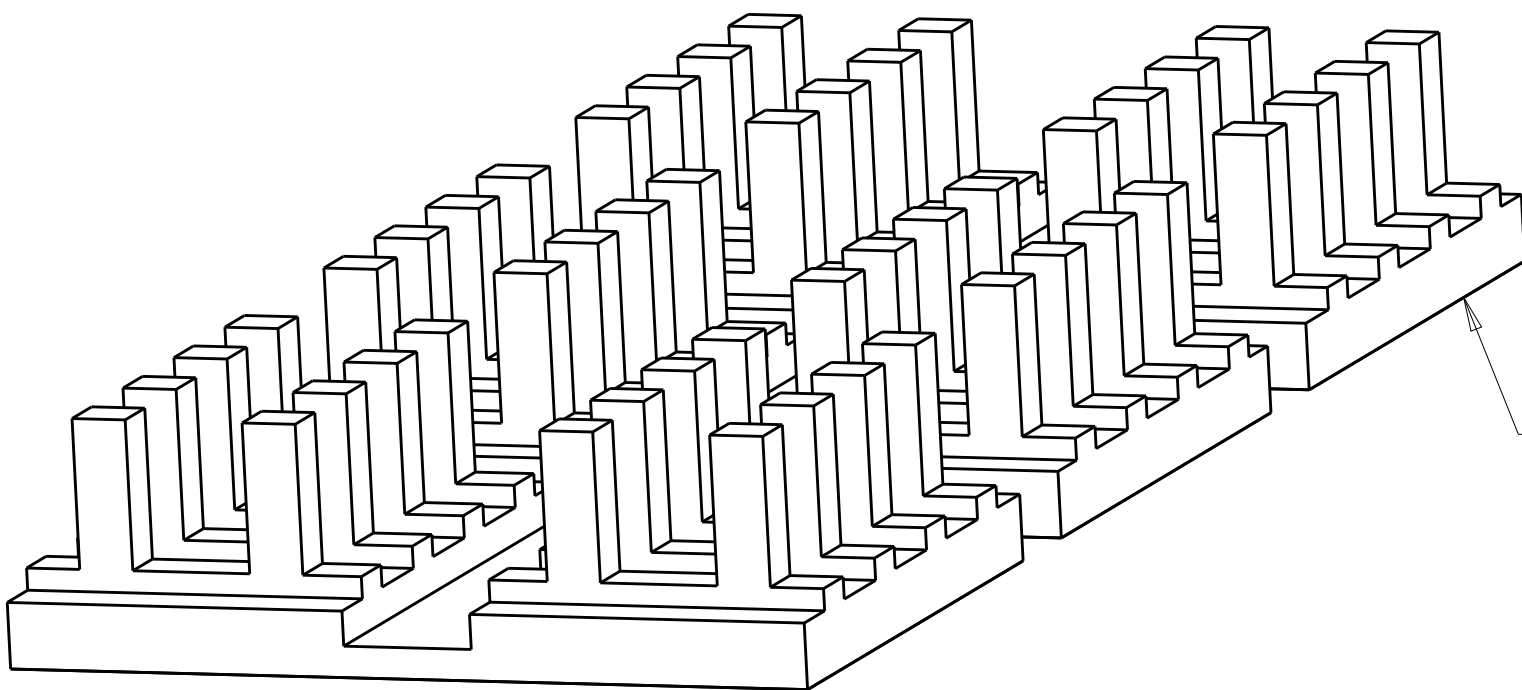

HEAT SINK

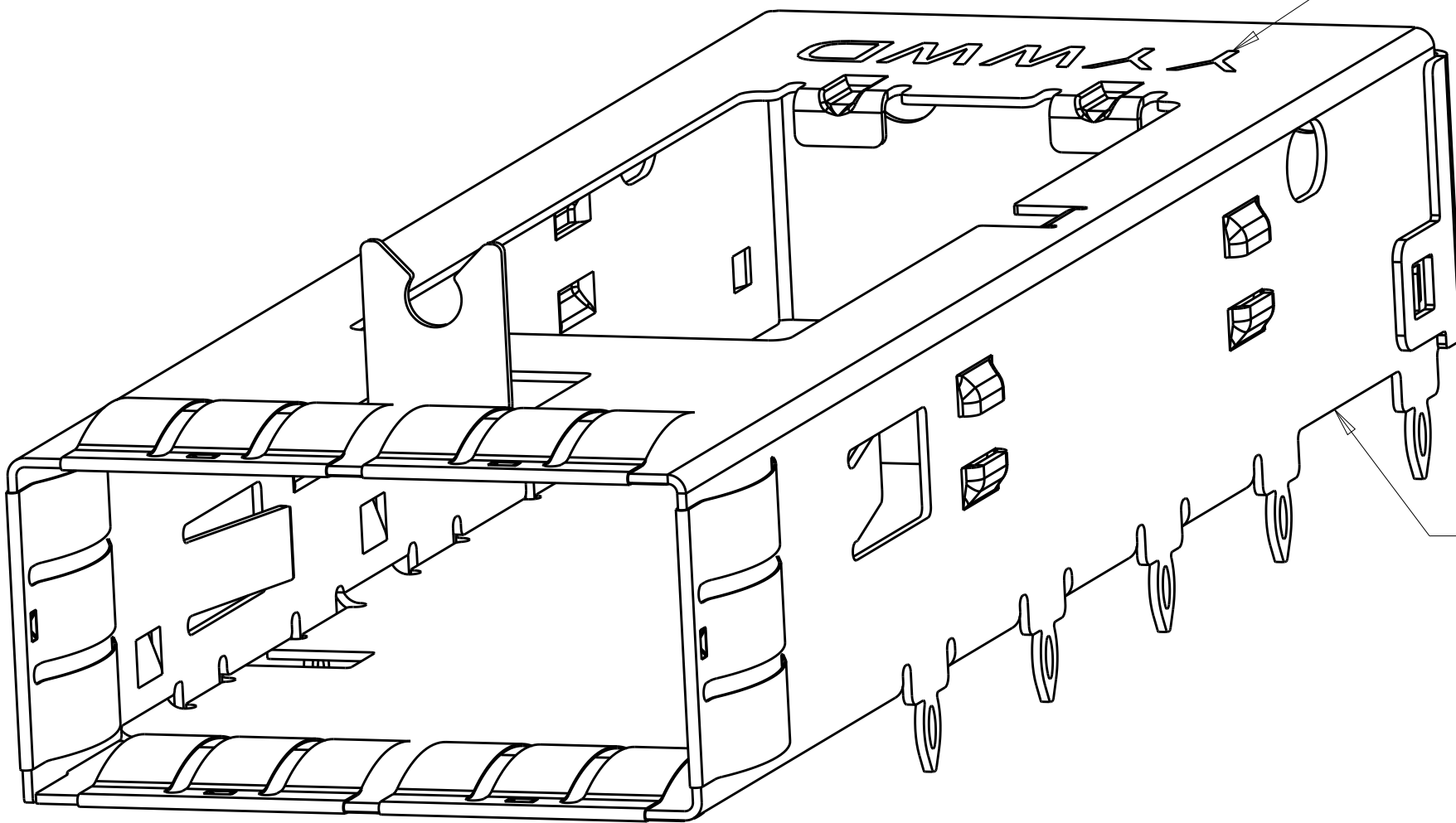

SINGLE QSFP CAGE
W/ LIGHT PIPE HOLDER

EXPLODED ISOMETRIC VIEW
SCALE 6:1

| | | | | | |
|--|--|---|-------------------------------------|---|--|
| THIS DRAWING IS A CONTROLLED DOCUMENT. | | DWN C. VALENTINE CHK E. BRIGHT APVD F. BRIGHT | 09MAR2007 09MAR2007 09MAR2007 | TE Connectivity | |
| DIMENSIONS: mm | | TOLERANCES UNLESS OTHERWISE SPECIFIED: 0 PLC ±.5 1 PLC ±0.5 2 PLC ±0.13 3 PLC ±0.013 4 PLC ±0.0001 ANGLES ±.5 FINISH | | NAME CAGE ASSEMBLY, THRU BEZEL, QSFP, W/ HEAT SINK AND SINGLE LIGHT PIPE - | |
| | | PRODUCT SPEC 108-2286 APPLICATION SPEC 114-13217 | | SIZE A1 | |
| MATERIAL TBD | | WEIGHT - | | CAGE CODE 100779 | |
| - | | CUSTOMER DRAWING | | DRAWING NO C=1888972 | |
| | | SCALE 4:1 | | SHEET 2 OF 4 | |
| | | | | REV B1 | |

| REVISIONS | | | | | |
|-----------|-----|-------------|------|-----|------|
| P | LTR | DESCRIPTION | DATE | DWN | APVD |
| - | - | SEE SHEET 1 | - | - | - |
| | | | | | |
| | | | | | |
| | | | | | |

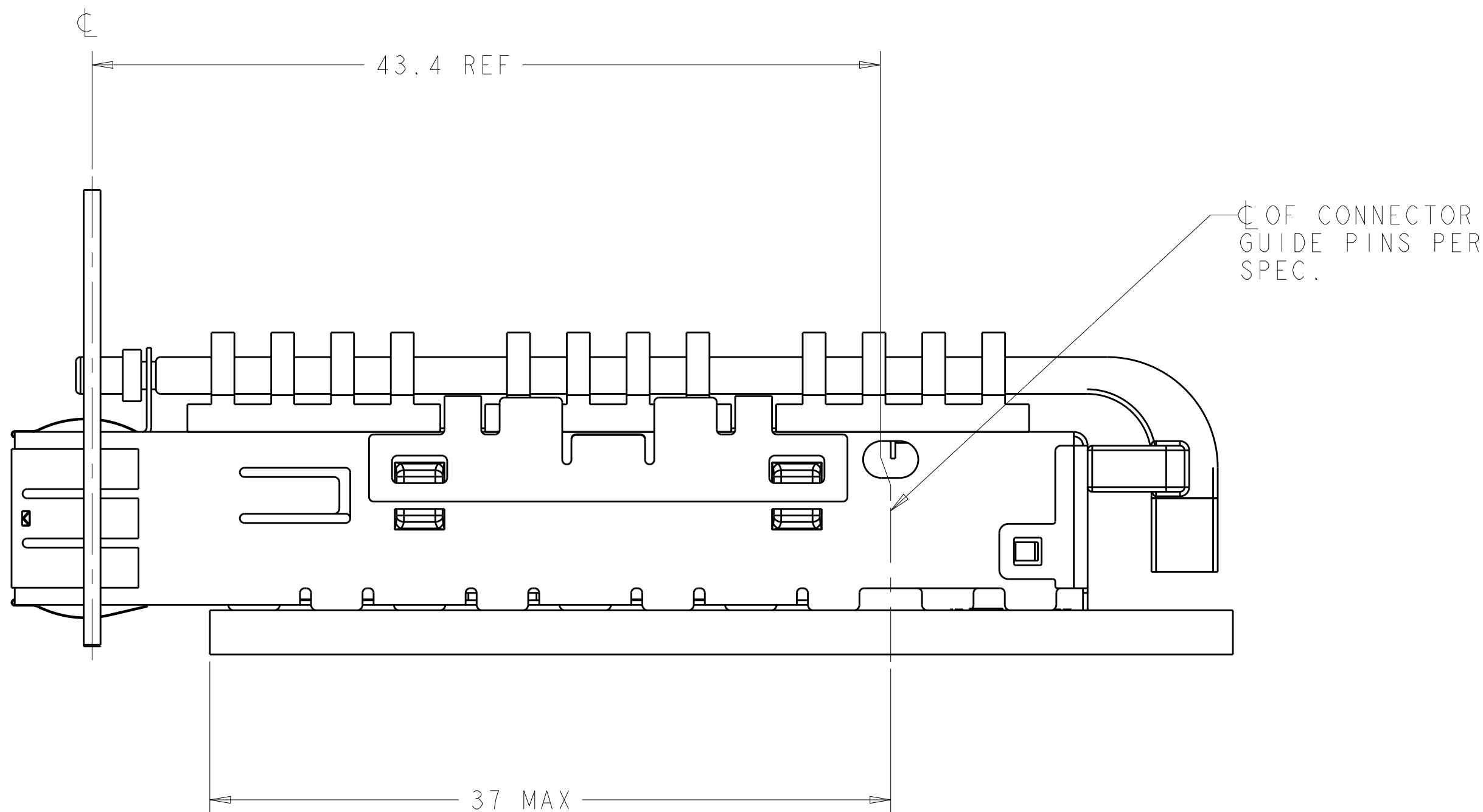
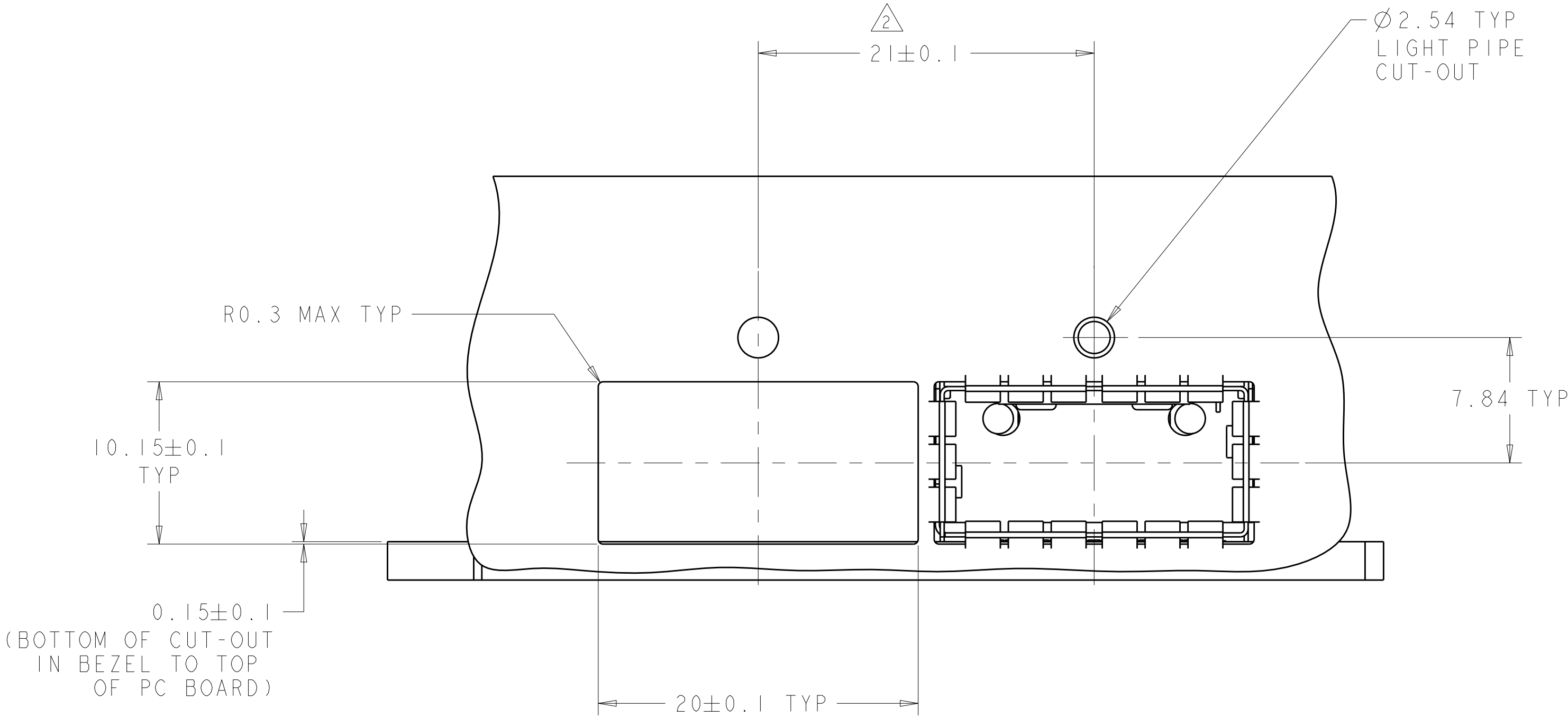

| | | | | | |
|--|--|--|-------------------------------------|---|--|
| THIS DRAWING IS A CONTROLLED DOCUMENT. | | DWN C. VALENTINE CHK E. BRIGHT APVD F. BRIGHT | 09MAR2007 09MAR2007 09MAR2007 | TE Connectivity | |
| DIMENSIONS: | | TOLERANCES UNLESS OTHERWISE SPECIFIED: | | NAME | |
| mm | | 0 PLC ± 0.5 1 PLC ± 0.5 2 PLC ± 0.13 3 PLC ± 0.013 4 PLC ± 0.0001 ANGLES ± 0.0001 FINISH | | CAGE ASSEMBLY, THRU BEZEL, QSFP, W/ HEAT SINK AND SINGLE LIGHT PIPE | |
| MATERIAL | | TBD | | SIZE | |
| - | | - | | A100779C=1888972 | |
| CUSTOMER DRAWING | | SCALE | | SHEET 3 OF 4 | |
| - | | 4:1 | | REV B1 | |

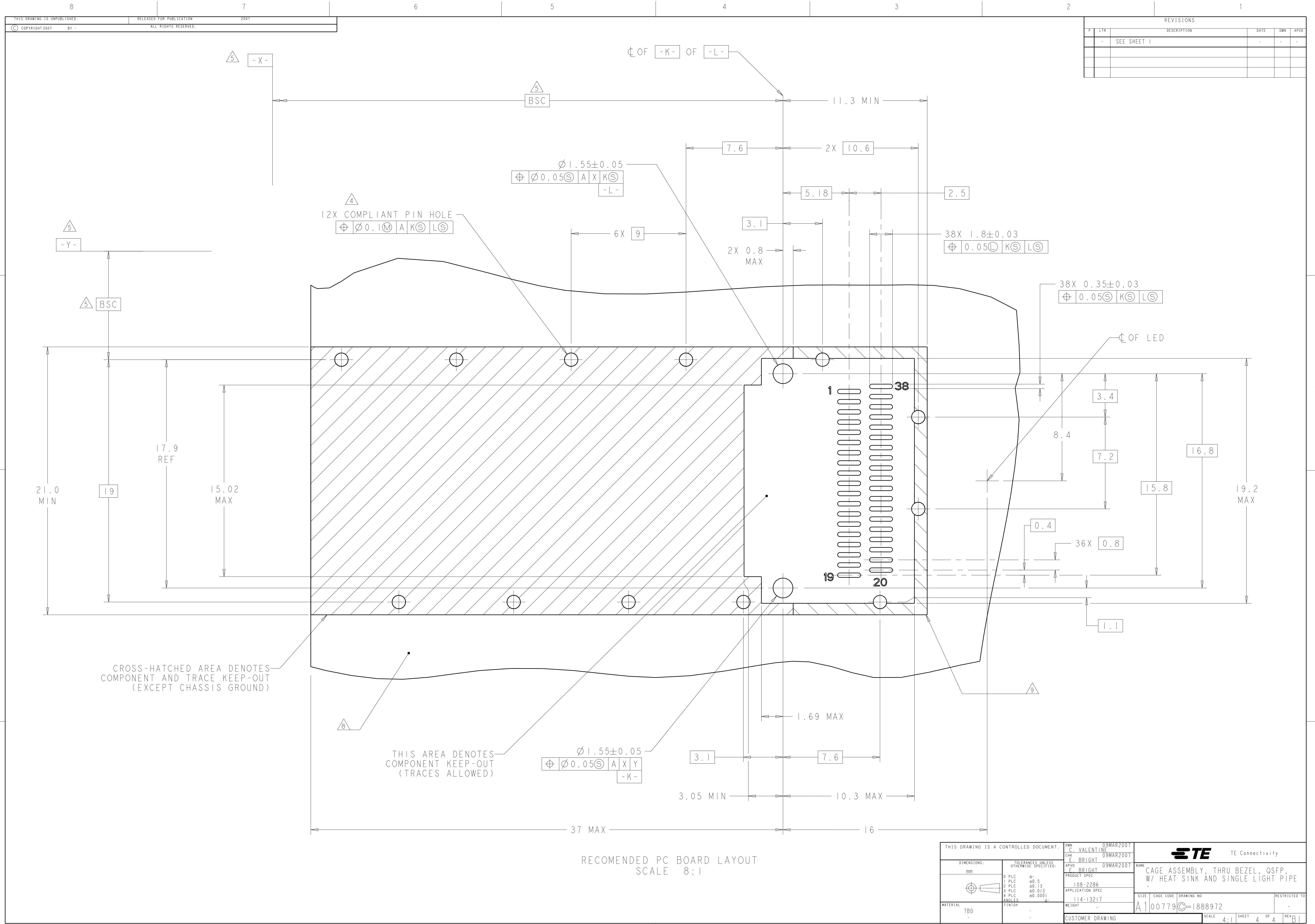

| REVISIONS | | | | | |
|-----------|-----|-------------|------|-----|------|
| P | LTR | DESCRIPTION | DATE | DWN | APVD |
| - | - | SEE SHEET 1 | - | - | - |
| | | | | | |
| | | | | | |
| | | | | | |

| | | | |
|---|--|--|-------------------------------------|
| THIS DRAWING IS A CONTROLLED DOCUMENT. | | DWN C. VALENTINE CHK E. BRIGHT APVD F. BRIGHT | 09MAR2007 09MAR2007 09MAR2007 |
| DIMENSIONS: mm | | TOLERANCES UNLESS OTHERWISE SPECIFIED: 0 PLC ±.5 1 PLC ±0.13 2 PLC ±0.13 3 PLC ±0.013 4 PLC ±0.0001 ANGLES ±.5 | |
| MATERIAL TBD | | FINISH - | |
| CUSTOMER DRAWING | | SCALE 4:1 SHEET 4 OF 4 REV B | |
| CAGE CODE A100779 | | DRAWING NO 114-13217 | |
| NAME CAGE ASSEMBLY, THRU BEZEL, QSFP, W/ HEAT SINK AND SINGLE LIGHT PIPE | | RESTRICTED TO - | |