

REVISIONS				
REV	ECO	DESCRIPTION	DATE	BY APPR
B1	-	RELEASED DRAWING	JUN-19-2014	BEN TOMMY

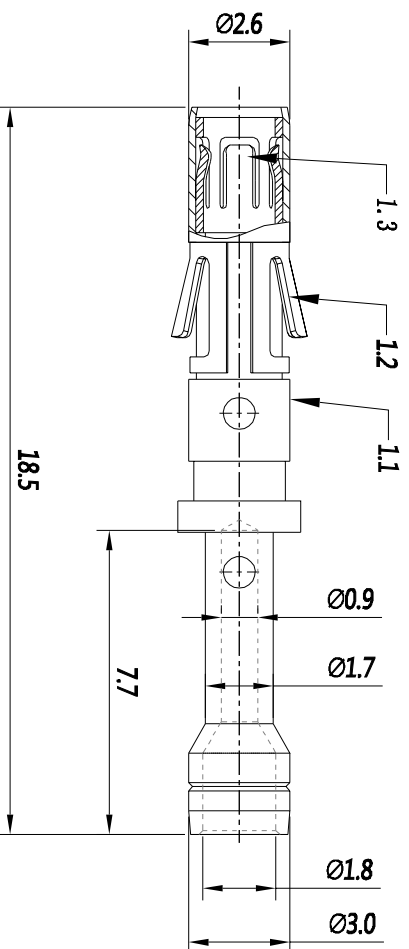

- NOTES : (UNLESS OTHERWISE SPECIFIED)
- MATERIAL :
 - CONTACT BODY : COPPER ALLOY.
 - POSITIONING CLIP : COPPER ALLOY.
 - CROWN SPRING CONTACT : COPPER ALLOY.
 - SPECIFICATIONS :
 - CURRENT RATING : 13A(MAX).
 - TERMINATION TYPE : CRIMPING.
 - WIRE RANGE : 24~26AWG.
 - SUITABLE SOCKET TYPE : MP24M23xx.
 - ROHS COMPLIANT.
 - ALL DIMENSIONS ARE FOR REFERENCE USE ONLY.

P/N	DESCRIPTION	QTY
MS24M23F	CONTACT PLATING(MATING AREA) GOLD FLASH PLATING OVER NICKEL.	
MS24M23G10	10µ" GOLD PLATING OVER NICKEL.	
MS24M23G15	15µ" GOLD PLATING OVER NICKEL.	
MS24M23G30	30µ" GOLD PLATING OVER NICKEL.	

QUANTITY	PART NUMBER	DESCRIPTION	ITEM
MATERIALS LIST			
UNLESS OTHERWISE SPECIFIED			
1) All dimensions are in millimeters.			
2) Tolerances are as follows:			
1 Ft. DEC 2d 30 Precision 1/16"			
2 Ft. DEC 2d 30 Precision 1/8"			
3 Ft. DEC 2d 30 Precision 1/4"			
4) Note reference = A			
MATERIAL SPECIFICATIONS:		CUSTOMER:	
PROCESS SPECIFICATIONS:		THIS DRAWING IS SUPPLIED FOR INFORMATION ONLY. IT IS NOT TO BE USED FOR THE MANUFACTURE OF ANY PARTS OR FOR THE REPRODUCTION OF ANY DRAWING. ALL RIGHTS ARE RESERVED. ALL DIMENSIONS ARE TO UNLESS OTHERWISE SPECIFIED.	
NEXT ASST:		SCALE: NONE	
		SHEET 1 OF 1	

Amphenol
 Shine Systems - www.amphenol-shine.com
 44724 Monkey Drive
 Clinton Township, MI 48038

ECO-MATE SOCKET CONTACT,
 MACHINE, 24-26AWG, SIZE 16