

- 1 HOUSING AND CONTACT OVERMOLDS - LCP, UL94-V0, BLACK.  
CONTACTS AND HOLD DOWNS - COPPER ALLOY.  
PICK AND PLACE TAPE - POLYIMIDE FILM.
- 2 CONTACTS - GOLD PLATE ON MATING SURFACES,  
TIN PLATE ON SOLDER FEET.  
HOLD DOWNS - TIN PLATE.
- 3 DATUMS AND BASIC DIMENSIONS ESTABLISHED BY CUSTOMER.
4. MINIMUM HOST PCB THICKNESS: 1.5.
- 5 SEE MSA SPECIFICATION FOR ADDITIONAL PADDLE CARD  
LAYOUTS COMPATIBLE WITH THIS RECEPTACLE AND FOR  
OPTIONAL SPLIT CONTACT PAD LAYOUTS FOR THE  
PADDLE CARD. SPECIFICATION PINOUT MAY ALSO  
DESIGNATE PAD SEQUENCE DIFFERENT FROM ILLUSTRATION.
- 6 POSITIONS DESIGNATED AS "SIGNAL" ARE REQUIRED  
LOCATIONS FOR HIGH SPEED DIFFERENTIAL PAIR  
SIGNALING. THESE LOCATIONS MAY ALSO BE USED FOR  
SUPPORTING SIDEBAND SIGNALS OR OTHER UTILITY  
PURPOSES. POSITIONS DESIGNATED AS "GROUND" ARE  
REQUIRED WHEN SUPPORTING HIGH SPEED DIFFERENTIAL  
SIGNALS. THESE LOCATIONS MAY ALSO BE USED FOR  
SIDEBAND SIGNALS OR OTHER UTILITY PURPOSES.
- 7 COMPONENT AND TRACE KEEP OUT AREA. EACH EDGE  
0.15 MIN FROM EDGE OF HOLE.
- 8 TAPE AND REEL PACKAGED FOR PICK AND PLACE SMT  
PROCESSING, SEE FIGURE 1. POCKET TAPE WIDTH = 44.

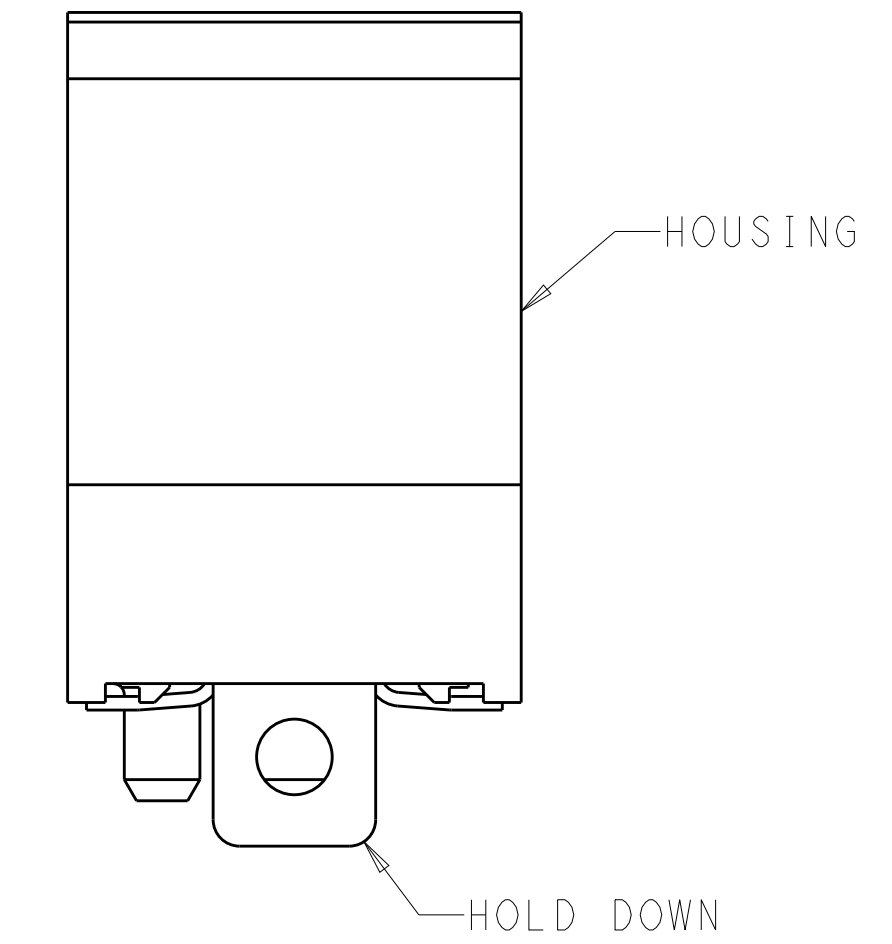

THIS DRAWING IS A CONTROLLED DOCUMENT.		DWN C. VALENTINE CHK D. HARMON APVD D. HARMON	16JAN2018 16JAN2018 16JAN2018	TE Connectivity	
DIMENSIONS:		TOLERANCES UNLESS OTHERWISE SPECIFIED:		NAME	
mm		0 PLC ±.01 1 PLC ±.01 2 PLC ±.01 3 PLC ±.01 4 PLC ±.01 ANGLES ±.01 FINISH		RECEPTACLE ASSEMBLY, VERTICAL, 56 POSITION, SLIVER 2.0	
MATERIAL		WEIGHT		SIZE CAGE CODE DRAWING NO	
1		2		A100779C=2327679	
CUSTOMER DRAWING		SCALE 10:1		SHEET 1 OF 4	
				REV A	

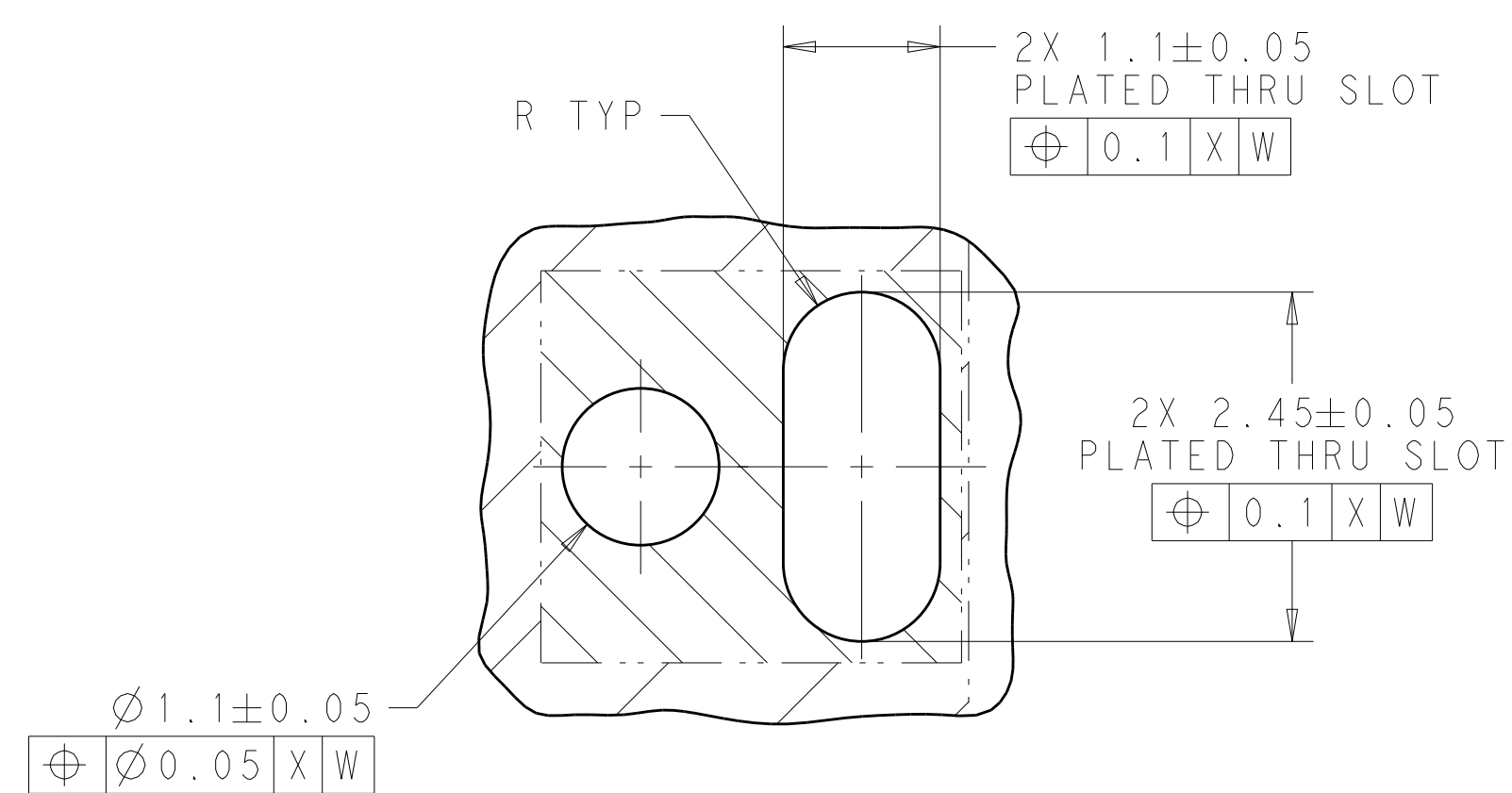

RECOMMENDED PCB LAYOUT  
AND KEEP OUT AREA

4805 (3/13)

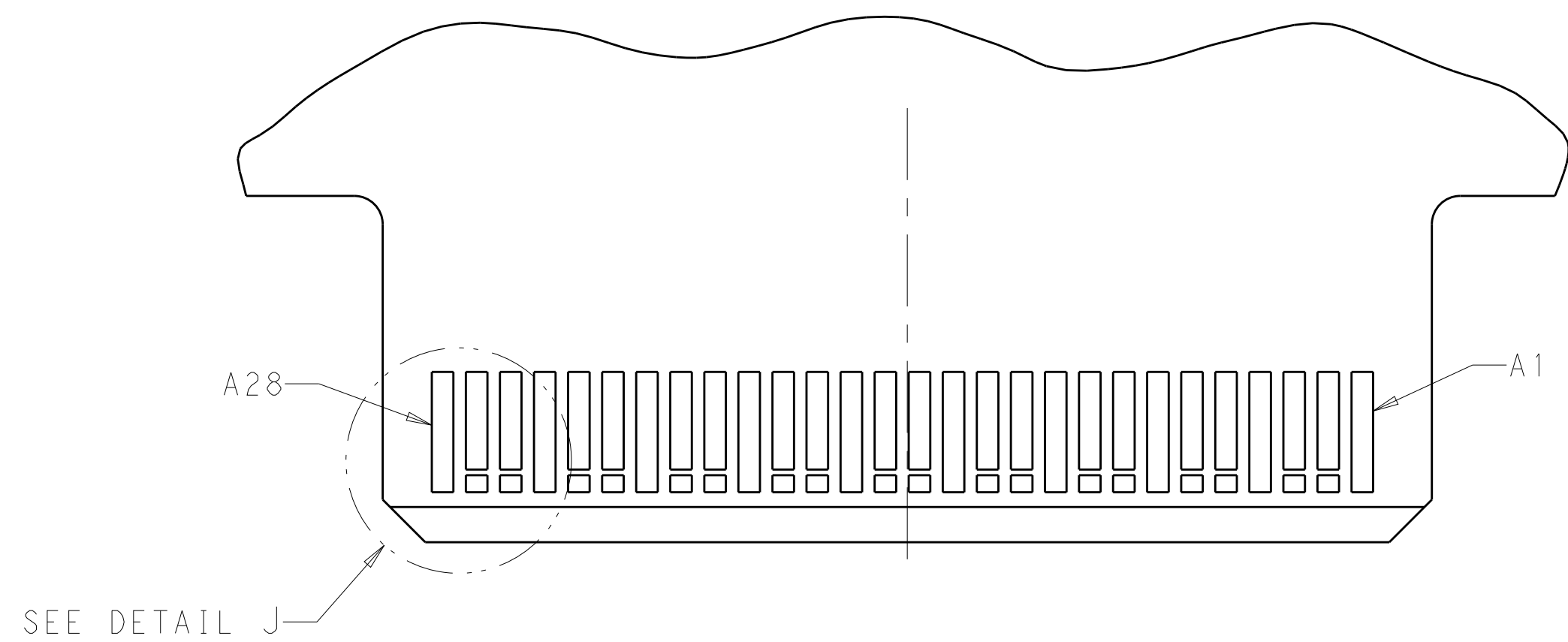

56X  
3±0.13

0.88±0.13  
LEVEL 1 SEQUENCE

CONTACT POINT  
REFERENCE LINE

(0.1)

(2.58)

1.28±0.13  
LEVEL 2 SEQUENCE

DETAIL J  
SCALE 20:1

SPLIT PADS OPTIONAL

4805 (3/13)

REVISIONS					
P	LTR	DESCRIPTION	DATE	DWN	APVD
-	-	SEE SHEET 1	-	-	-

TABLE 1: CONNECTOR CONTACT IDENTIFICATION 56

CONTACT NUMBER	SIDE A	SIDE B
1	GROUND	GROUND
2	SIGNAL	SIGNAL
3	SIGNAL	SIGNAL
4	GROUND	GROUND
5	SIGNAL	SIGNAL
6	SIGNAL	SIGNAL
7	GROUND	GROUND
8	SIGNAL	SIGNAL
9	SIGNAL	SIGNAL
10	GROUND	GROUND
11	SIGNAL	SIGNAL
12	SIGNAL	SIGNAL
13	GROUND	GROUND
14	SIGNAL	SIGNAL
15	SIGNAL	SIGNAL
16	GROUND	GROUND
17	SIGNAL	SIGNAL
18	SIGNAL	SIGNAL
19	GROUND	GROUND
20	SIGNAL	SIGNAL
21	SIGNAL	SIGNAL
22	GROUND	GROUND
23	SIGNAL	SIGNAL
24	SIGNAL	SIGNAL
25	GROUND	GROUND
26	SIGNAL	SIGNAL
27	SIGNAL	SIGNAL
28	GROUND	GROUND

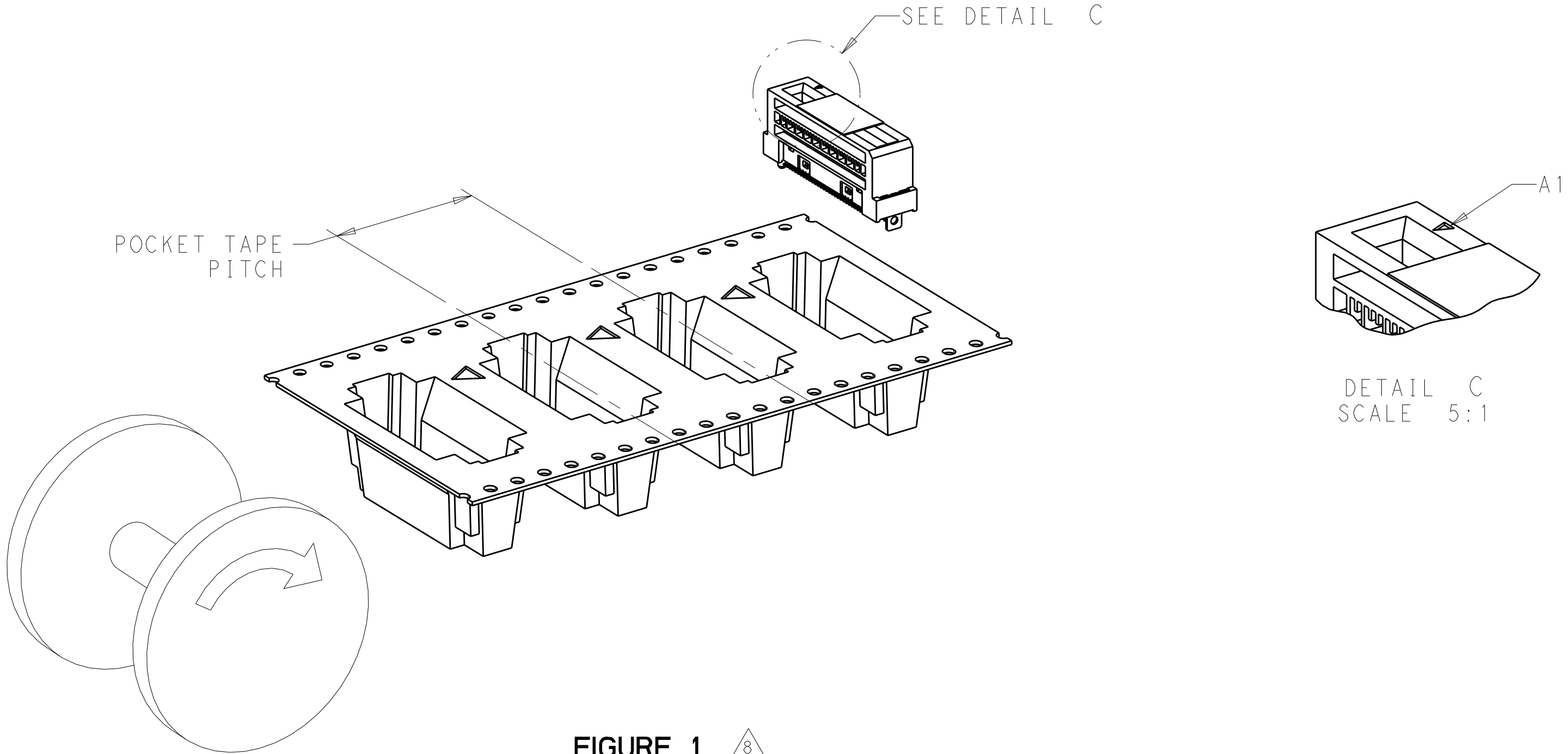

**FIGURE 1** 8  
DIRECTION OFF TOP OF REEL  
FOR USER UNREELING  
SHOWN AS 2327679-1 THRU 2327679-9  
AND 2-2327679-0  
SCALE 2:1

3.7±0.1	0.76µm Au	20	250	YES	200	2-2327679-0
3±0.1	0.76µm Au	24	TBD	NO	200	1-2327679-9
	0.38µm Au				100	1-2327679-8
	FLASH Au/PdNi				50	1-2327679-7
1.4 MAX	0.76µm Au	24	250	NO	200	1-2327679-6
	0.38µm Au				100	1-2327679-5
	FLASH Au/PdNi				50	1-2327679-4
1.7 MIN	0.76µm Au	24	250	NO	200	1-2327679-3
	0.38µm Au				100	1-2327679-2
	FLASH Au/PdNi				50	1-2327679-1
3±0.1	0.76µm Au	20	250	YES	200	2327679-9
	0.38µm Au				100	2327679-8
	FLASH Au/PdNi				50	2327679-7
1.4 MAX	0.76µm Au	20	350	YES	200	2327679-6
	0.38µm Au				100	2327679-5
	FLASH Au/PdNi				50	2327679-4
1.7 MIN	0.76µm Au	20	350	YES	200	2327679-3
	0.38µm Au				100	2327679-2
	FLASH Au/PdNi				50	2327679-1
A	PLATING	POCKET TAPE PITCH	REEL QUANTITY	PICK AND PLACE TAPE	MATING CYCLES	PART NUMBER

THIS DRAWING IS A CONTROLLED DOCUMENT.

DIMENSIONS:  
mm

MATERIAL

TOLERANCES UNLESS OTHERWISE SPECIFIED:

0 PLC ±"

1 PLC ±"

2 PLC ±"

3 PLC ±"

4 PLC ±"

ANGLES ±"

FINISH

DWN  
C. VALENTINE  
CHK  
D. HARMON  
APVD  
D. HARMON

16JAN2018  
16JAN2018  
16JAN2018

PRODUCT SPEC  
108-130021  
APPLICATION SPEC  
114-130008  
WEIGHT  
-

NAME  
RECEPTACLE ASSEMBLY, VERTICAL,  
56 POSITION, SLIVER 2.0  
-

SIZE  
A1

CAGE CODE  
00779

DRAWING NO  
C=2327679

RESTRICTED TO  
-

CUSTOMER DRAWING

SCALE  
10:1

SHEET  
4

OF  
4

REV  
A