

REV.	DATE	DESCRIPTION
NC	04/25/97	INITIAL RELEASE
A	07/28/06	UPDATE DRAWING FORMAT

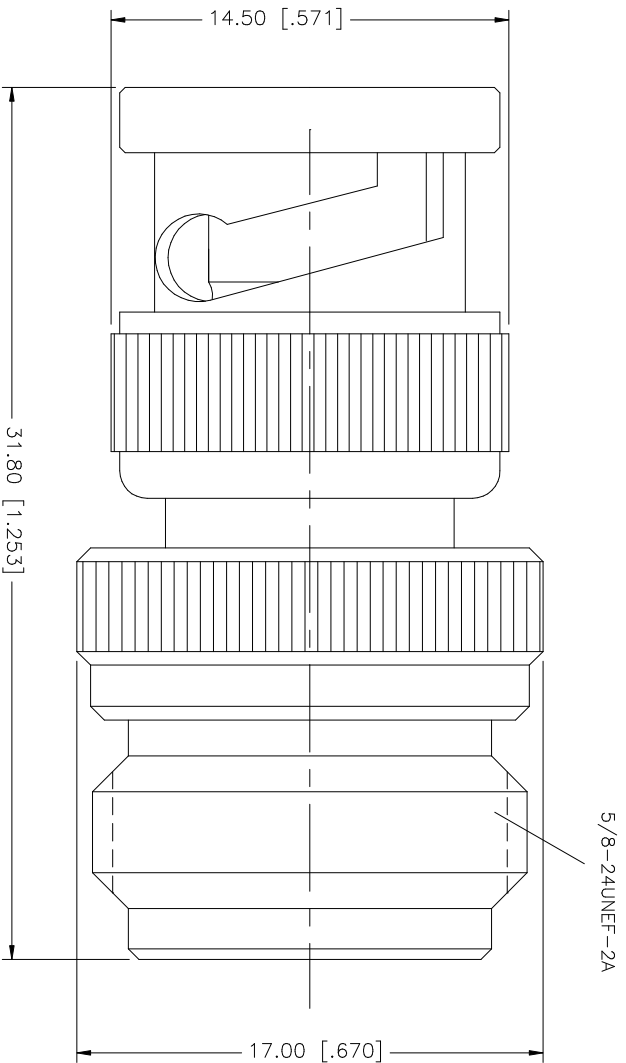

REV.	DATE	DESCRIPTION
8		
7		
6		
5		
4		
3		
2		
1		

DESCRIPTION	MATERIAL	FINISH	QTY
CONTACT PIN	PHOS. BRONZE	GOLD	1
INSULATOR	TEFLON	NATURAL	1
BODY	BRASS	NICKEL	1
DESCRIPTION	MATERIAL	FINISH	QTY

UNLESS OTHERWISE SPECIFIED DIMENSIONS ARE IN MILLIMETERS. DIMENSIONS IN PARENTHESIS ARE IN INCHES AND FOR SUBSTITUTED SERVICE ONLY.	APPROVALS	DATE
UNLESS OTHERWISE SPECIFIED DIMENSIONS ARE IN MILLIMETERS. DIMENSIONS IN PARENTHESIS ARE IN INCHES AND FOR SUBSTITUTED SERVICE ONLY. TOLERANCES FOR MILLIMETERS ARE: 0.5 - 8mm ± 0.20mm 8 - 30mm ± 0.40mm 30 - 120mm ± 0.50mm UNLESS OTHERWISE SPECIFIED TOLERANCES FOR INCHES ARE: .020 - .315 = ± 0.007" .315 - 1.180 = ± 0.015" 1.180 - 4.724 = ± 0.020" DO NOT SCALE DRAWING	DRAWN G.R.S. CHECKED ISSUED SHEET 1 OF 1	07/28/06

CAD FILE	DWG. NO.	REV.	SIZE	SCALE
C:/242/242101.DWG	242101.DWG	A	A	NA

PART DESCRIPTION	PART NO.
Amphenol Connex	242101
BNC MALE TO N FEMALE ADAPTER	